

PART NUMBER	REV	FIRST USED
680081-1	D	854400-1
680081-2	D	354500-1

TERMINAL NAME:			CRIMPING DATA			
.205 FLAG FASTON™ TERMINAL			PAD LTR	CRIMP HEIGHT	WIRE SIZE	
63779			A	.070±.002	12	
			B	.060±.002	14	
			C	NOT	USED	
			D	NOT	USED	
CRIMP		SIZE	TYPE	RANGE		
WIRE		.160	TAB LOCK	14-12		
INSUL		.180	0	.110-.210		
FEED	APPL INST	SET UP GAGE	LAYOUT			
.770	A1 8031	-	L1566			
TERM APPL SPEC 114-2078			WIRE STRIP LENGTH -			

-1	LEADMAKER	MECH POST FEED
-2	BENCH MODEL G	AIR FEED

-	1	-	A	22594-8	NUT, HEX	70
-	1	-	B	240628-1	PLATE, ADJ	69
-	1	-	B	240626-1	SHAFT, PIVOT	68
-	1	-	B	240633-1	BUSHING	67
-	1	-	A	240630-1	LEVER, INTERMEDIATE	66
-	1	-	B	240629-1	BLOCK, PIVOT	65
-	1	-	A	240632-2	SCR, ADJ	64
-	1	-	B	240659-3	PIN, CAM ROLLER	63
-	1	-	B	240658-1	ROLER, CAM	62
-	1	-	B	240631-1	ROD, FEED	61
1	-	-	B	456987-1	BLOCK, PIVOT	60
1	1	-	C	455164-1	CAP ASSEMBLY	59
-	1	-	D	455162-1	HOUSING	58
1	-	-	D	457079-1	HOUSING	57
-	1	-	B	458361-1	GUIDE, FEED ROD	56
1	1	-	B	240624-1	PIN, FEED FINGER	55
1	1	-	B	691499-1	SPRING, FEED FINGER	54
1	1	-	B	454568-2	FINGER, FEED	53
-	1	-	B	240634-1	LEVER, TERMINAL	52
1	-	-	B	457057-3	ARM, PIVOT	51
1	1	-	A	22353-8	SCREW, SHOULDER	50
1	1	-	A	3-21002-5	BOLT, CRIMPER	49
						48
-	1	-	B	238015-1	CAM, POST-FEED 1 5/8 ST	47
1	1	-	A	690578-1	BLOCK, INSULATION ADJUST	46
1	1	-	A	690191-1	PLUG, NYLON	45
1	1	-	C	454574-1	RAM	44
1	1	-	A	690125-1	WASHER, LAMINATED	43
1	1	-	A	1-609124-1	WASHER, RAM	42
						41
1	1	-	A	23241-6	BALL, STEEL	40
1	1	-	A	690170-1	SPRING, COMPRESSION	39
1	1	-	C	690142-1	DISC, INSULATION	38
1	1	-	D	354777-1	WIRE DISC, PLASTIC	37
1	1	-	B	22480-5	WASHER, SPRING	36
1	1	-	B	690212-1	POST, RAM	35
1	1	-	A	3-23846-5	SPRING, HINGE BAR	34
						33
1	1	-	A	690573-1	SPACER, SPRING	32
1	1	-	C	454569-1	MOUNT, DRAG	31
1	1	-	A	1-22354-8	STUD, DRAG	30
1	1	-	A	21030-2	PIN, MOUNT, DRAG	29
1	1	-	B	690582-1	PIN, HINGE	28
						27
1	1	-	C	684905-1	PLATE, BASE	26
1	1	-	B	454579-2	HINGE BAR	25
1	1	-	B	690571-1	BLOCK, STABILIZER	24
1	1	-	C	690585-1	BLOCK, PRESSURE	23
1	1	-	A	8-22282-6	SPRING, DRAG	22
1	1	-	A	21030-6	LEVER, DRAG	21
1	1	-	A	454570-1	DRAG, STOCK	20
1	1	-	C	454573-1	GUIDE, STRIP (REAR)	19
1	1	-	C	454571-2	GUIDE, STRIP (FRONT)	18
1	-	-	A	2-22287-6	SPRING, FEED RETURN	17
-	1	-	A	4-22284-6	SPRING, FEED RETURN	16
						15
						14
1	1	-	C	2-692134-0	POSITIONER, TERMINAL	13
1	1	-	A	5-22280-5	SPRING, TERM. POSITIONER	12
1	1	-	B	454711-1	PLATE, REAR SHEAR	11
1	1	-	C	454709-1	ANVIL INSERT	10
1	1	-	B	690569-1	PLATE, FRONT SHEAR	9
1	1	-	D	691523-3	ANVIL	8
1	1	-	B	454575-5	BLADE, SLUG	7
						6
1	1	-	B	684906-1	PLATE, ANVIL RETAINING	5
1	1	-	B	690574-3	SPACER, TUBULAR INSUL CRIMPER	4
1	1	-	C	690588-3	CRIMPER, INSULATION	3
						2
1	1	-	C	690587-1	CRIMPER, WIRE	1

						129	
2	2	-	C	354779-2	PIN, WIRE DISC (.3000)B	127	
2	2	-	C	8-354778-1	PIN, WIRE DISC (.2900)A	126	
1	1	-	A	986950-1	WASHER, FLAT PRECISION	125	
1	1	-	A	1-21030-2	PIN, DOWEL (ø.187X.62)	124	
1	1	-	A	1-21030-6	PIN, DOWEL (ø.187X1.25)	123	
						122	
2	2	-	A	3-21028-2	PIN, SLOTTED SPRING (ø.094X.25)	121	
2	2	-	A	4-21028-9	PIN, SLOTTED SPRING (ø.125X.38)	120	
-	2	-	A	5-21028-1	PIN, SLOTTED SPRING (ø.125X.50)	119	
1	1	-	A	21029-5	PIN, SLOTTED SPRING (ø.188X.75)	118	
						117	
						116	
4	4	-	A	21024-4	WASHER, LOCK (#8)	115	
2	2	-	A	21055-6	WASHER, FLAT (#8)	114	
2	2	-	A	21899-2	WASHER, FLAT (#10)	113	
2	2	-	A	21024-5	WASHER, LOCK (#10)	112	
1	-	-	A	457058-1	PIN, PIVOT	111	
1	-	-	A	25745-1	RING, SPLIT	110	
1	1	-	A	1-22202-7	NUT, HEX (5/16-24)	109	
1	1	-	A	21022-3	NUT, HEX (LOCKING) (10-32)	108	
-	1	-	A	21018-5	NUT, HEX (6-32)	107	
2	2	-	A	21045-3	RING, RET "C" (ø.187)FD PIN	106	
1	1	-	A	8-21007-5	SCREW, SKT SET (5/16-24x.75)	105	
7	7	-	A	2-22733-8	SCREW, BHC (1/4-20X.63)	104	
1	-	-	A	1-21986-2	RING, RET "E" (ø.187)	103	
1	1	-	A	21009-2	SCREW, SKT SET (1/4-20x.25)	102	
						101	
2	2	-	A	3-21000-9	SCREW, SHC (10-32X1.00)	100	
6	4	-	A	3-21000-8	SCREW, SHC (10-32X.88)	99	
1	2	-	A	3-21000-6	SCREW, SHC (10-32X.62)	98	
-	1	-	A	3-21000-4	SCREW, SHC (10-32X.38)	97	
2	2	-	A	7-21000-6	SCREW, SHC (10-32X.38)	96	
						95	
2	2	-	A	4-21006-0	SCREW, SKT SET (8-32X.25)	94	
1	1	-	A	21061-9	SCREW, SKT SET (8-32X.25)	93	
-	2	-	A	3-21000-0	SCREW, SHC (8-32X.88)	92	
4	4	-	A	2-21000-9	SCREW, SHC (8-32X.75)	91	
2	2	-	A	1-23030-1	SCREW, SHC (NYLON) (8-32X.62)	90	
4	4	-	A	2-21000-8	SCREW, SHC (8-32X.62)	89	
2	2	-	A	2-21000-7	SCREW, SHC (8-32X.50)	88	
1	1	-	A	2-21002-1	SCREW, BHC (8-32X.38)	87	
2	-	-	A	3-21002-4	SCREW, BHC (1/4-20X .62)	86	
-	1	-	A	6-23715-5	SCR, PAN HD (6-32x1.50)FEED ADJ	85	
1	1	-	A	23030-1	SCREW, SHC (NYLON) (6-32X.25)	84	
						83	
						82	
						81	
						80	
6	REF	-	-	A	679532-1	INSERT, GUARD	79
1	-	-	-	D	462622-2	AIR FEED ASSY	78
							77
2	2	-	A	21017-2	SCR, DRIVE (#2X.19) ID	76	
1	1	-	B	461264-1	PLATE, IDENTIFICATION	75	
1	1	-	A	690603-1	SPRING, ASSIST	74	
						73	
1	1	-	A	458109-1	WASHER, SPECIAL	72	
						71	

QTY	REV	U/M	DWG SIZE	PART NO	DESCRIPTION	ITEM NO
	-2					
	-1					

QTY	REV	U/M	DWG SIZE	PART NO	DESCRIPTION	ITEM NO
	-2					
	-1					

- 1 RECOMMENDED SPARE PARTS.
- 2 GREASE LIGHTLY.
- 3 LUBRICATE DAILY USING NO. 20 MACHINE OIL.
- 4. DO NOT EXCEED 80 C.P.M. WITH THIS APPLICATOR.
- 5 AFTER ASSEMBLY OF APPLICATOR, PROPER SPRING PRESSURE (ITEM 34) CAN BE OBTAINED BY TIGHTENING SET SCREW (ITEM 105) UNTIL CONTACT IS MADE WITH SPACER (ITEM 32) THEN TIGHTEN AN ADDITIONAL 5 1/2 - 6 REVOLUTIONS.
- 6 GUARD MUST BE IN PLACE WHEN OPERATING APPLICATOR IN A BENCH MACHINE.

LOC A	DIST 66	AMP 3308 REV 12-89	17 JAN 1997	12:39:07	AMP07567	7	6	5	4	3	2	1	
DIMENSIONS IN INCHES. DO NOT SCALE PRINT. TOLERANCES UNLESS OTHERWISE SPECIFIED:		MATERIAL		FINISH		DR		REL		SCALE		SHEET	
2 PLC DEC ±		3-24-94		3-24-94		M. O'BRINE		B. WOLFE		D		1 OF 2	
3 PLC DEC ±		4-15-94		4-15-94		C. ERISMAN		B. MORGAN		DWG NO		REV D	
4 PLC DEC ±		REVISION RECORD		APP		DATE		MACHINE REF		MINI APPL		REV	
ANGLES ±		REMOVE BURRS, BREAK SHARP EDGES R.015 MAX						END FEED HINGE BAR APPLICATOR		680081		D	

THIS DRAWING IS A CONTROLLED DOCUMENT FOR AMP. INCORPORATED. IT IS SUBJECT TO CHANGE AND THE CONTROLLING ENGINEERING ORGANIZATION SHOULD BE CONTACTED FOR THE LATEST REVISION.

THIS INFORMATION IS CONFIDENTIAL AND IS DISCLOSED TO YOU ON CONDITION THAT NO FURTHER DISCLOSURE IS MADE BY YOU TO OTHER THAN AMP PERSONNEL WITHOUT WRITTEN AUTHORIZATION FROM AMP, INCORPORATED, HARRISBURG, PA.

THIS DRAWING IS A CONTROLLED DOCUMENT FOR AMP INCORPORATED. IT IS SUBJECT TO CHANGE AND THE CONTROLLING ENGINEERING ORGANIZATION SHOULD BE CONTACTED FOR THE LATEST REVISION.

THIS INFORMATION IS CONFIDENTIAL AND IS DISCLOSED TO YOU ON THE CONDITION THAT NO FURTHER DISCLOSURE IS MADE BY YOU TO OTHER THAN AMP PERSONNEL WITHOUT WRITTEN AUTHORIZATION FROM AMP INCORPORATED, HARRISBURG, PA.

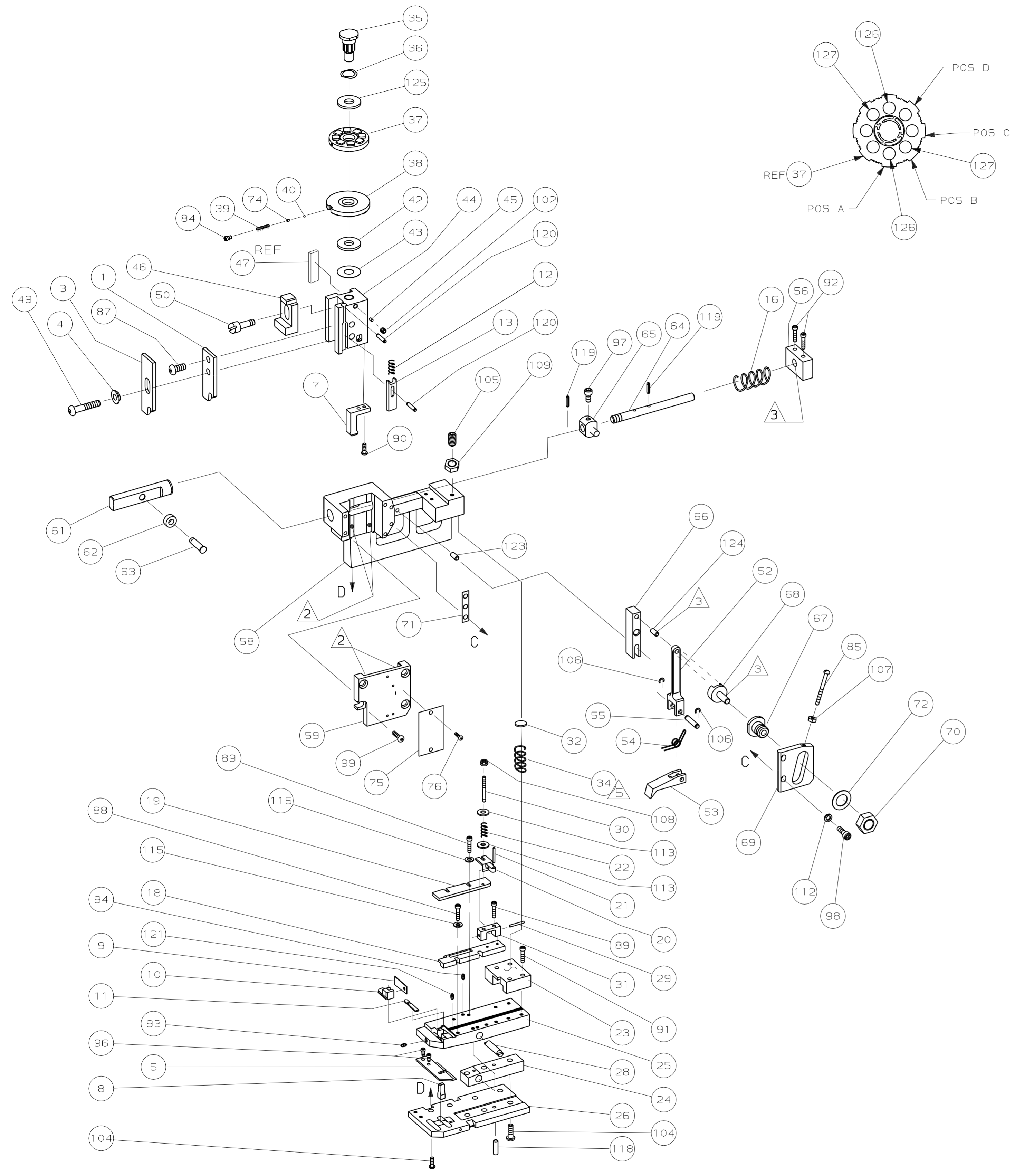

-1 (MECHANICAL FEED)

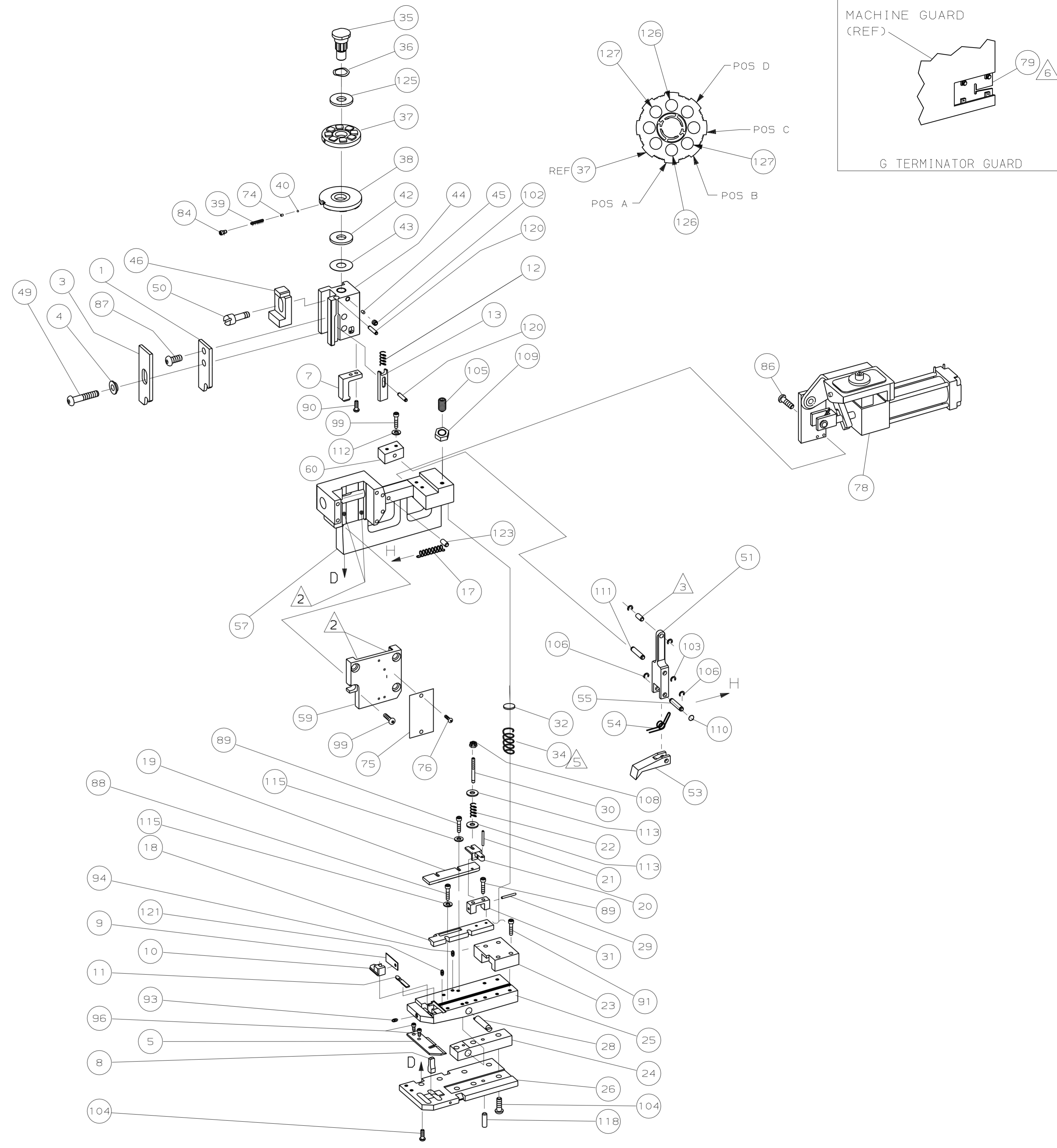

-2 (AIR FEED)

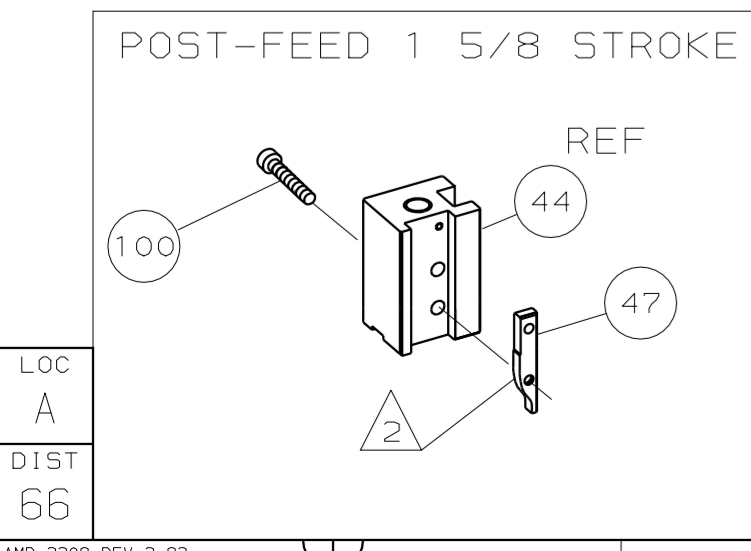
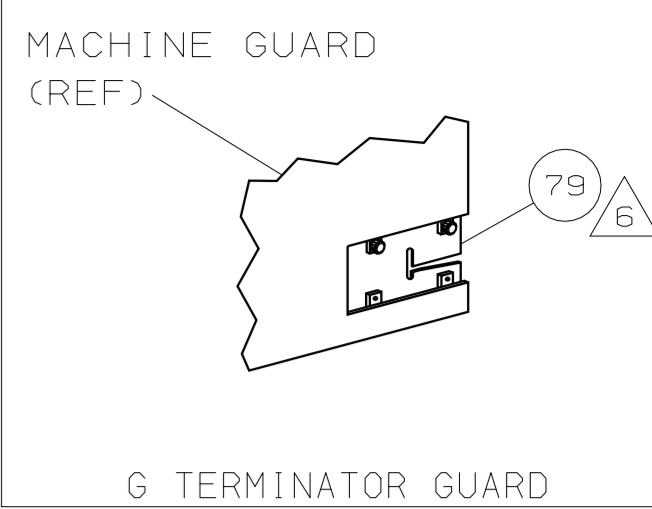

P/F		L/R		REVISION RECORD		APP		DATE	

DWG SIZE	PART NO	DESCRIPTION	ITEM NO
← REVISION OF EACH ASSY NO (WHEN BLANK, USE DWG REVISION)			
QTY REQD PER ASSY		PARTS LIST	
MATL	HT TR	FIN	
DIMENSIONS IN INCHES. DO NOT SCALE PRINT. TOLERANCES UNLESS OTHERWISE SPECIFIED:			
DR	3-24-94 APP	3-24-94	
M. O'BRINE		B. WOLFE	
CHK	3-24-94	REL	4-15-94
C. ERISMAN		B. MORGAN	
NAME		MACHINE REF	
END FEED HINGE BAR APPLICATOR		MINI-APPL	
SCALE	DWG NO	SHEET	REV
	680081	2 OF 2	D

680081  
D  
C  
B  
A