

REVISIONS					
P	LTR	DESCRIPTION	DATE	DWN	APVD
K1		REVISED PER ECR-24-199024	05FEB2024	SS	RE

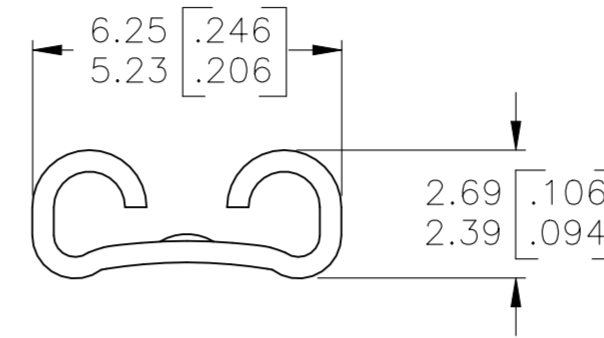

VIEW A-A

- 1 CONTINUOUS STRIP ON REELS.
- 2 MATING TAB THK TO BE 0.508±0.025 [.020±.001]
- 3 WIRE SIZE IS #18-#14 AWG.
- 4 INSULATION RANGE IS 1.52-3.81 [.060-.150] DIA.
- 5 RECEPTACLE LENGTH CAN BE GREATER BY UP TO 0.25 [.010] MAX FROM THE OPPOSITE SIDE.

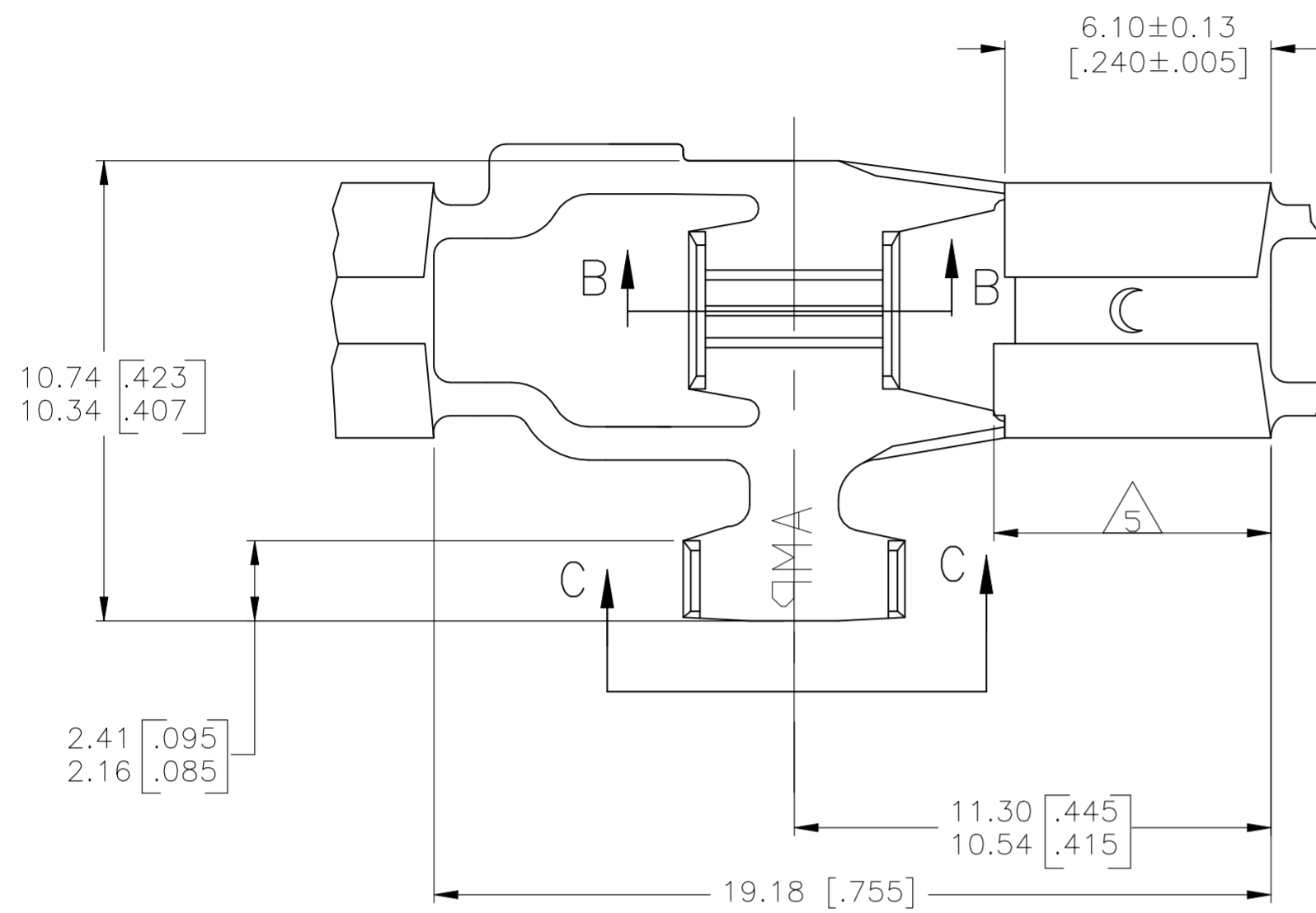
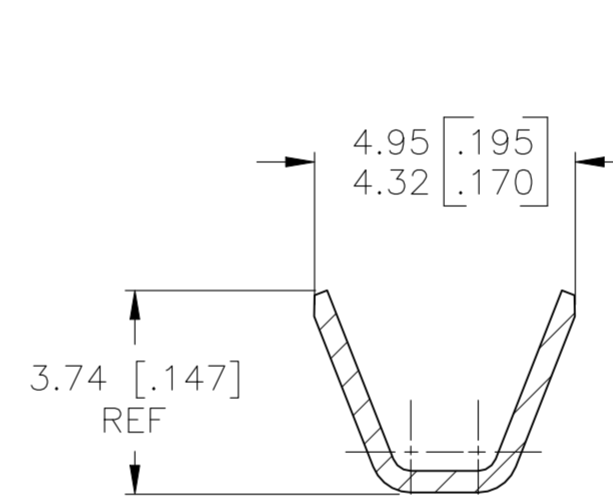
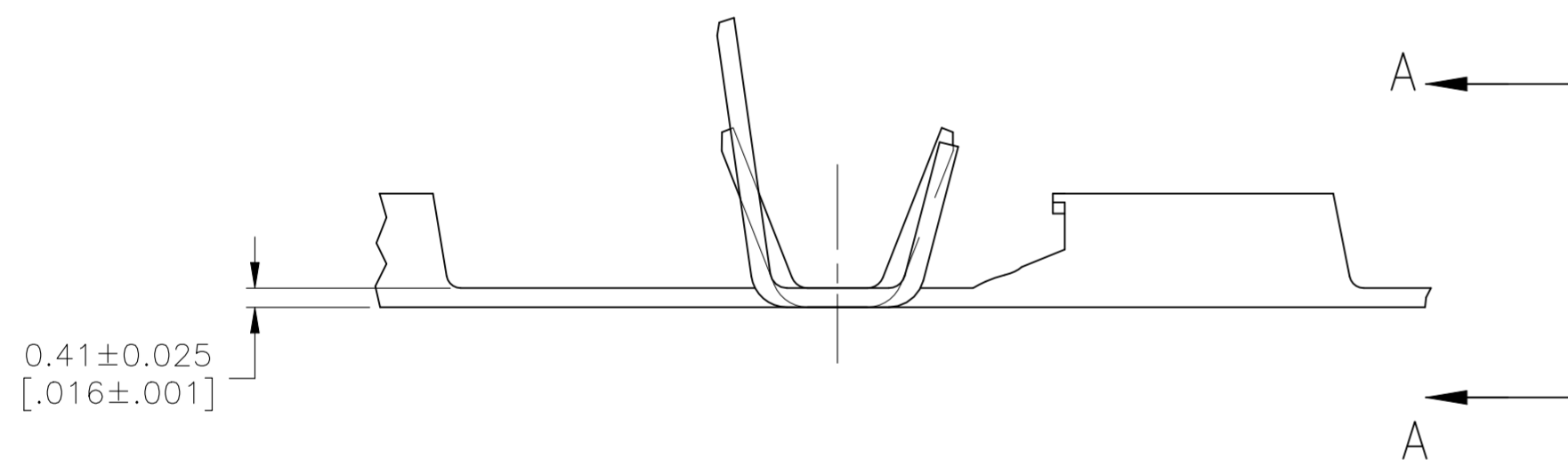

SECTION B-B

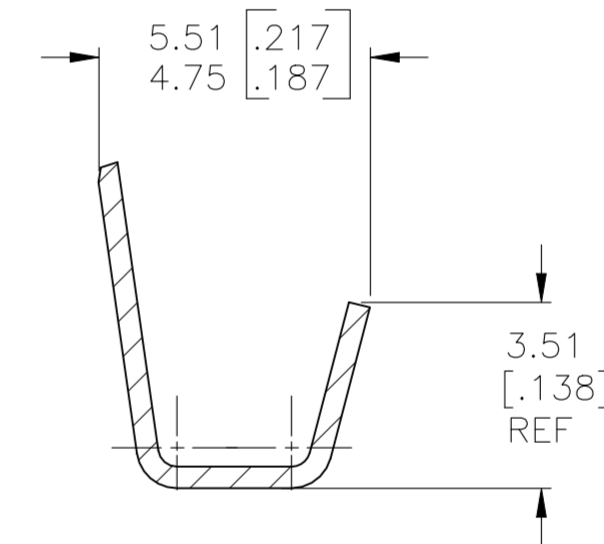

SECTION C-C

PART NO	WIRE		INSULATION DIAMETER (MAX)	WIRE BARREL CRIMP			TENSILE STRENGTH POUNDS	
	QTY	SIZE AWG		WIDTH	CRIMP HEIGHT	CRIMPER		ANVIL
63512-1	1	14	.150	.120	.071	F	FLAT	50
	1	16			.063			30
	1	18			.057			20

OBSOLETE		.000080 MIN TIN	63512-4
	REVERSE REELING	-	63512-3
		-	63512-1
	REELING	FINISH	PART NO.

THIS DRAWING IS A CONTROLLED DOCUMENT.		DWN	JR RUTH	9/29/88		RECEPTACLE, FLAG, FASTON, 4.75 [.187] SERIES		
DIMENSIONS: mm [INCHES]		CHK	MS FEHER	9/30/88		-		
TOLERANCES UNLESS OTHERWISE SPECIFIED:		APVD	C MEYERS	9/30/88		-		
0 PLC ± -		PRODUCT SPEC				-		
1 PLC ± -		APPLICATION SPEC			SIZE	CAGE CODE	DRAWING NO	RESTRICTED TO
2 PLC ± 0.25 [.010]					A2	00779	C=63512	-
3 PLC ± -					SCALE		SHEET	REV
4 PLC ± -					4:1		1 of 1	K1
ANGLES ± -					CUSTOMER DRAWING			
FINISH					SEE TABLE			
MATERIAL					BRASS			