

UNPUBLISHED
 REPRODUCED WITHOUT PERMISSION
 OF AMP INCORPORATED

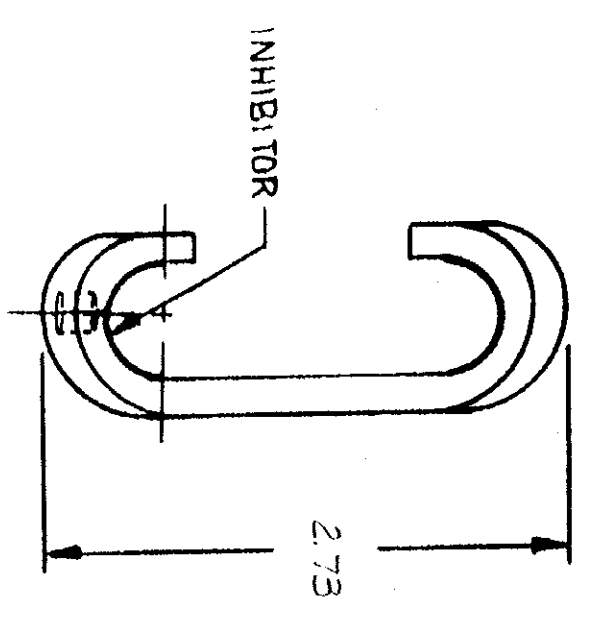
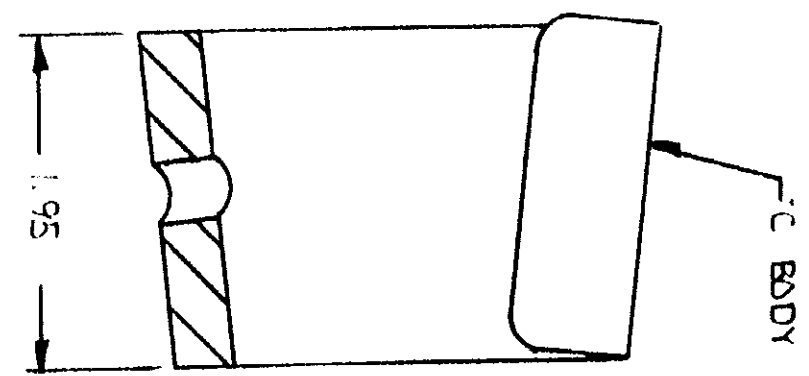
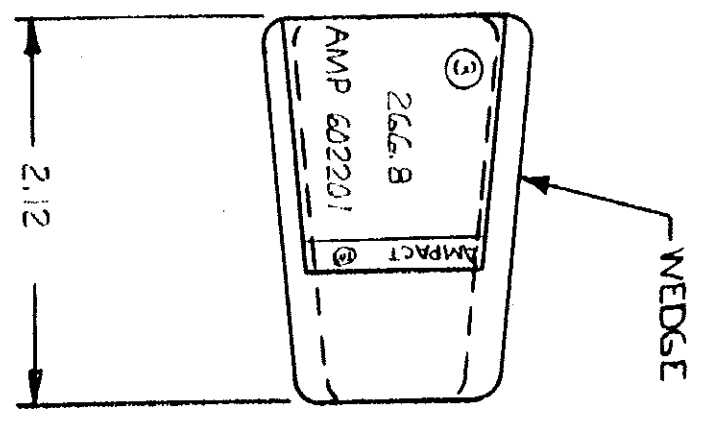
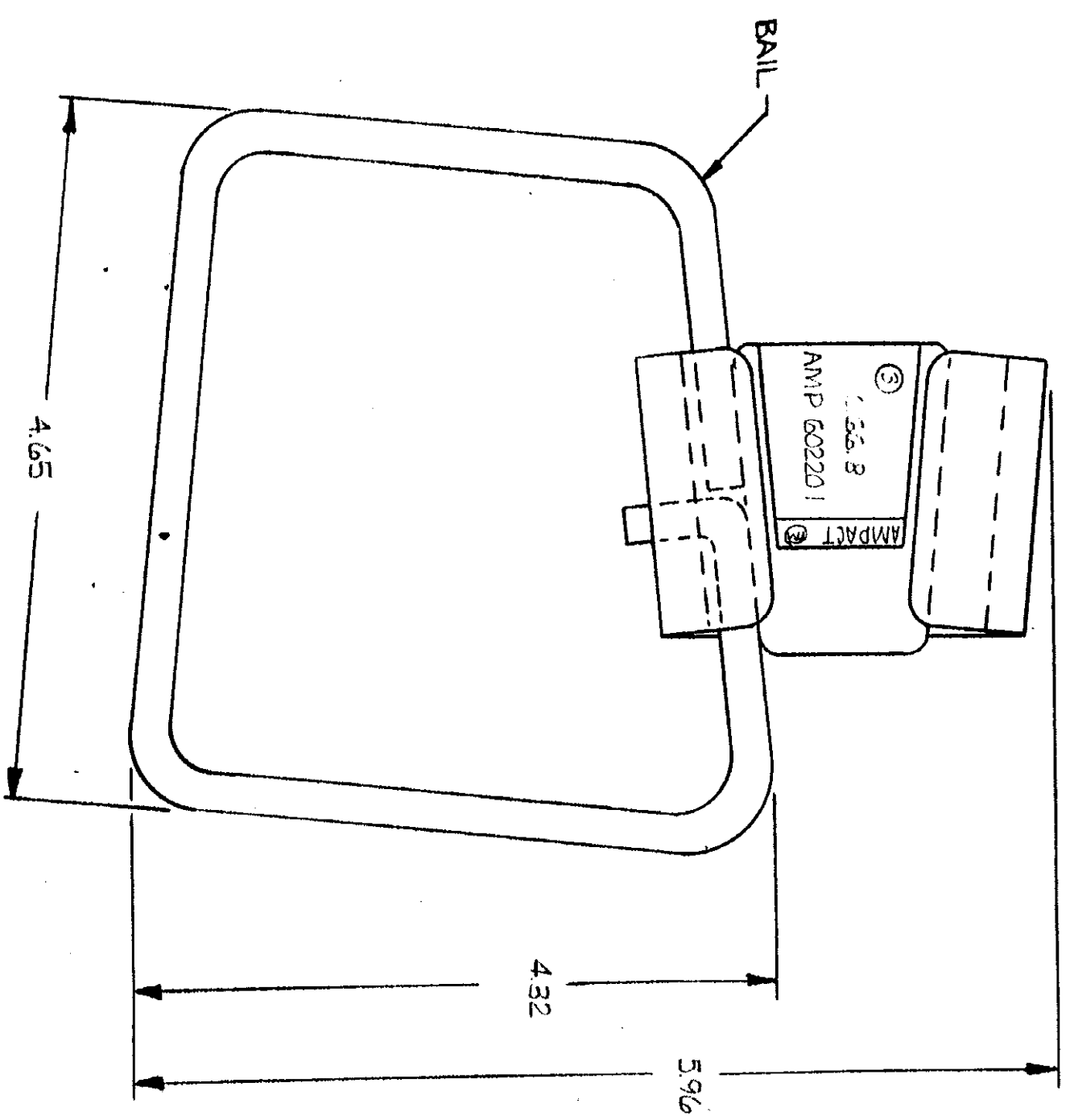

DESIGN APPROVED	DATE	APPROVED
<input checked="" type="checkbox"/>	0 N/A 68-1520	5-7-75
DESIGNED	DATE	APPROVED
<input checked="" type="checkbox"/>		AK 26

DESCRIPTION	MATERIAL & FINISH
1 BAIL	COPPER (ASTM B2), TIN PL (MIL-T-10127)
1 WEDGE	ALUM. ALLOY (90-A-591)
1 C BODY	ALUM. ALLOY (90-A-250/11)

UNLESS OTHERWISE SPECIFIED DIMENSIONS ARE IN INCHES
 TOLERANCES ON:
 DECIMALS ±.02
 ANGLES ±.30°

CONTRACT NO.	5-6-75	DR	DR	DATE	5-7-75
DR	DR	DATE	5-7-75	CHKD	5-7-75
APPD	APPD	DATE	5-21-75	APPD	5-21-75
APPD	APPD	DATE	5-21-75	APPD	5-21-75
OTHER APPD	OTHER APPD	DATE	5-21-75	OTHER APPD	5-21-75
FINISH	(SEE TABLE)	SCALE	N.T.S.	SHEET	602201