

P.C. BOARD MOUNTING DIMENSIONS

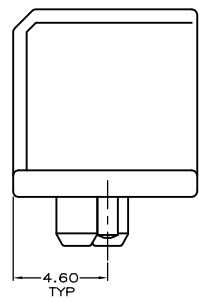

- △ HOUSING: SPS, UL 94V-0 RATED, BLACK.
- △ CONTACT: BRASS.
- △ .076um MINIMUM GOLD OVER 0.76um MINIMUM PALLADIUM NICKEL ON MATING AREA, 3.80um MINIMUM TIN ON SOLDER TAIL, ALL OVER 1.27um MINIMUM NICKEL.
- △ DATUMS AND DIMENSIONS ESTABLISHED BY CUSTOMER.
- △ RECOMMENDED MINIMUM TRACE WIDTH FOR END POSITIONS WHEN CARRYING 3 AMPS: 1.8 WIDE x 55um THICK, BOTH SIDES.

5787531-1  
PART NUMBER

THIS DRAWING IS A CONTROLLED DOCUMENT.		DATE	07-08-99	BY	R.S.KLINE	TYCO ELECTRONICS CORPORATION
DIMENSIONS: mm		DATE	07-11-99	BY	R.S.KLINE	SHANGHAI PRC
TOLERANCES UNLESS OTHERWISE SPECIFIED:		DATE	07-11-99	BY	R.S.KLINE	SHANGHAI PRC
Ø	± 0.13	PRODUCT SPEC				
PLC	± 0.13	APPLICATION SPEC				
PLC	± 0.13					
PLC	± 0.13					
MATERIAL:		SIZE	A1	DATE CODE	00779	DRAWING NO
		WEIGHT				5787531
		CUSTOMER DRAWING				RESTRICTED TO
		SCALE	8:1	SHEET	1	REV
						0