

LOC		DIST		REVISIONS			
AD	00	P	LTR	DESCRIPTION	DATE	OWN	APPD
		P		REVISED PER ECO-11-004835	11MAR11	RK	HMR

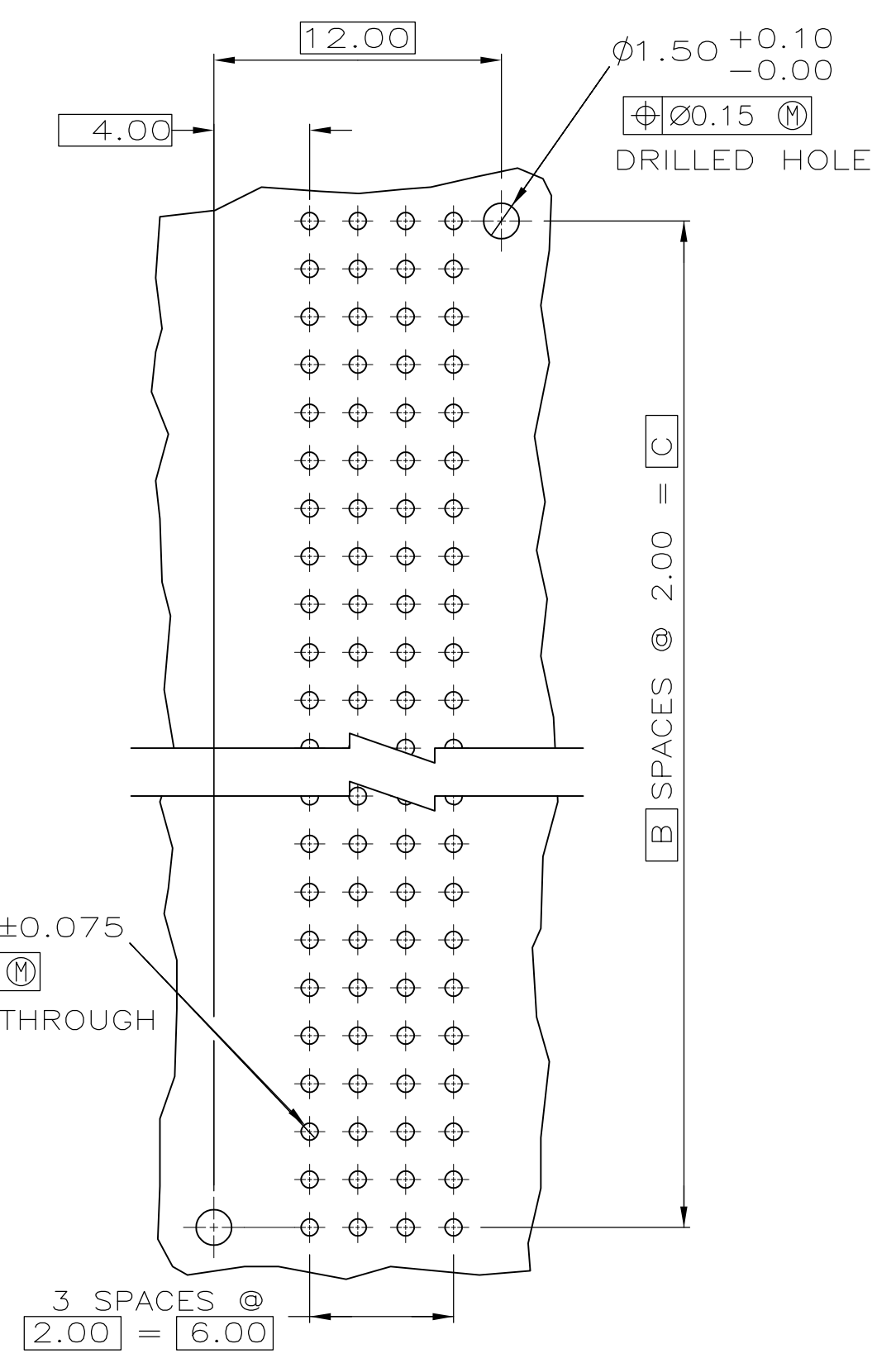

RECOMMENDED CIRCUIT PATTERN
PER IPC-D300 TYPE II, CLASS C
(COMPONENT SIDE)

- 1 HOUSING MATERIAL: LIQUID CRYSTAL POLYMER PER ASTM D5138 LCPO00 G30A 32250.
- 2 CONTACT MATERIAL: PHOSPHOR BRONZE PER UNS ALLOY NO. C51100, TEMPER: H04.
- 3 CONTACT FINISH:(E)
UNDERPLATE (ENTIRE CONTACT):
0.00127 MIN NICKEL PER SAE-AMS-QQ-N-290
ON MATING SURFACES:
FLASH GOLD PER ASTM B 488, OVER
0.00076 MIN PALLADIUM-NICKEL OVER UNDERPLATE, OR
0.00076 MIN GOLD PER ASTM B 488 OVER UNDERPLATE.
ON LEADS:
0.00381 MIN MATTE TIN PER ASTM B 545 OVER UNDERPLATE.
LUBRICATION (MIN MATING SURFACES):
SURFACE CONDITIONER AFTER PLATING.
- 4 PART MARKING, LOCATED APPROXIMATELY AS SHOWN.

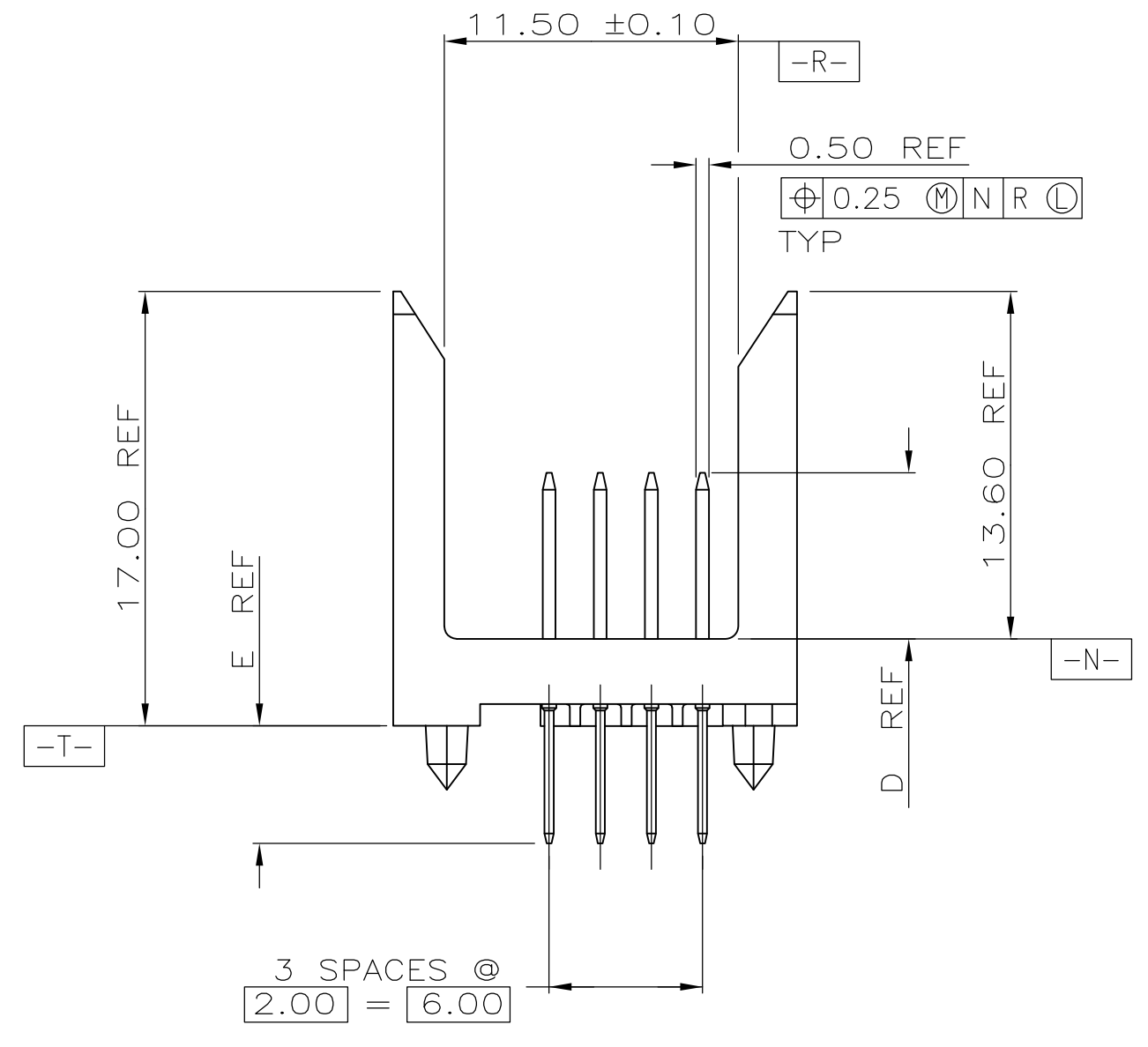
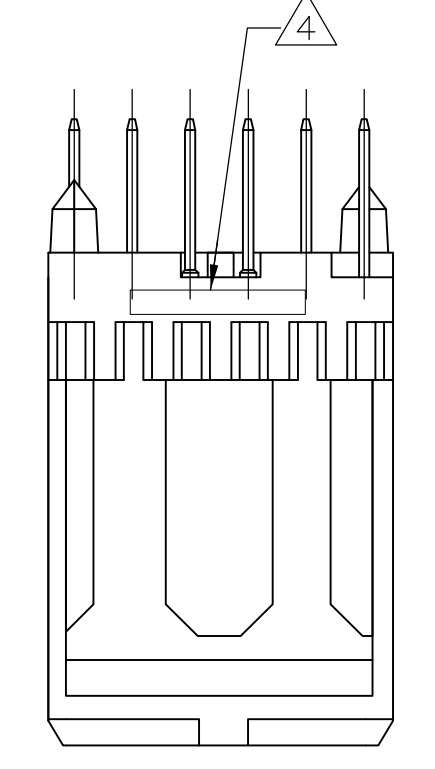
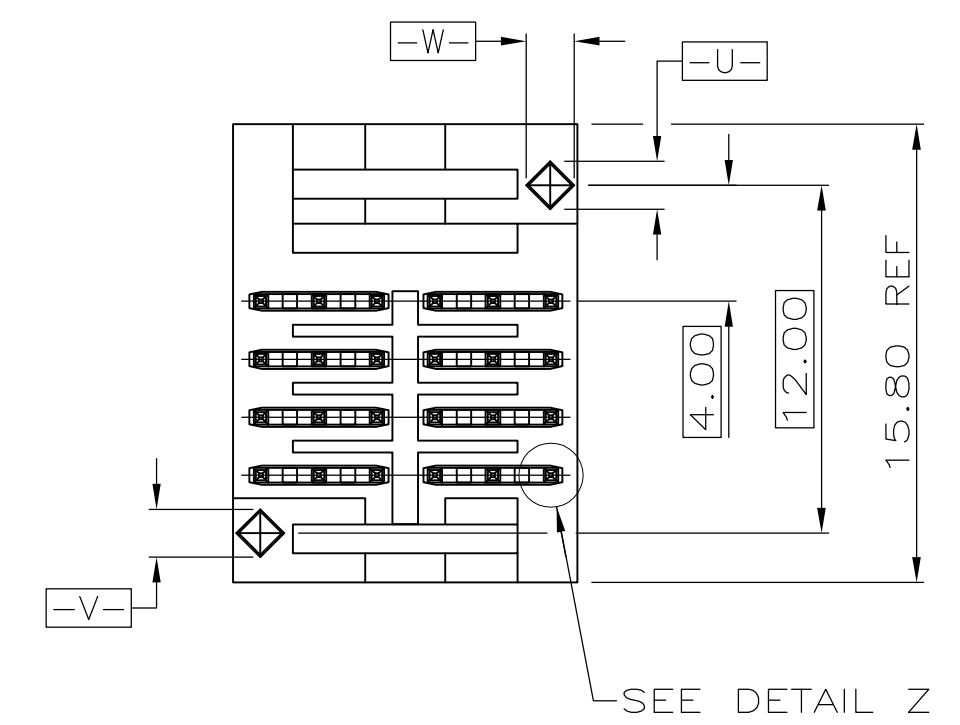
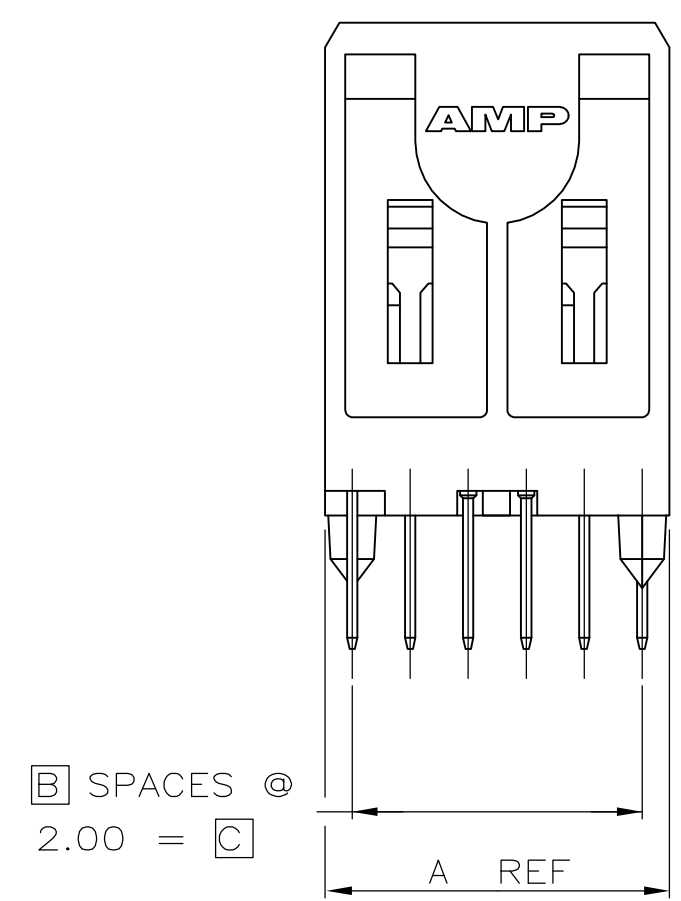
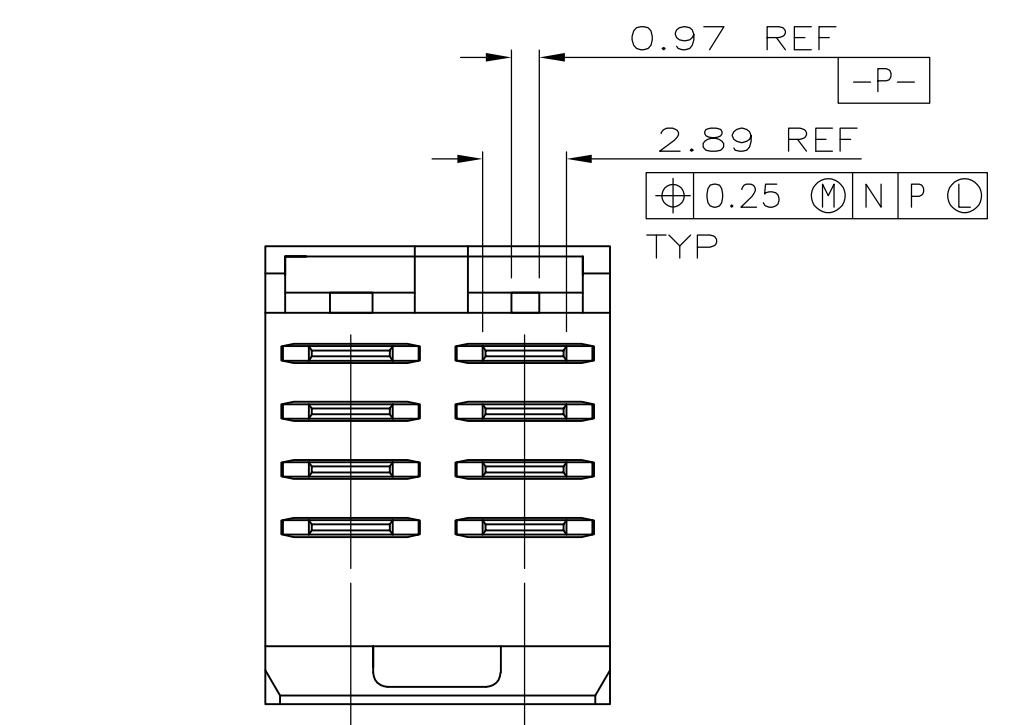
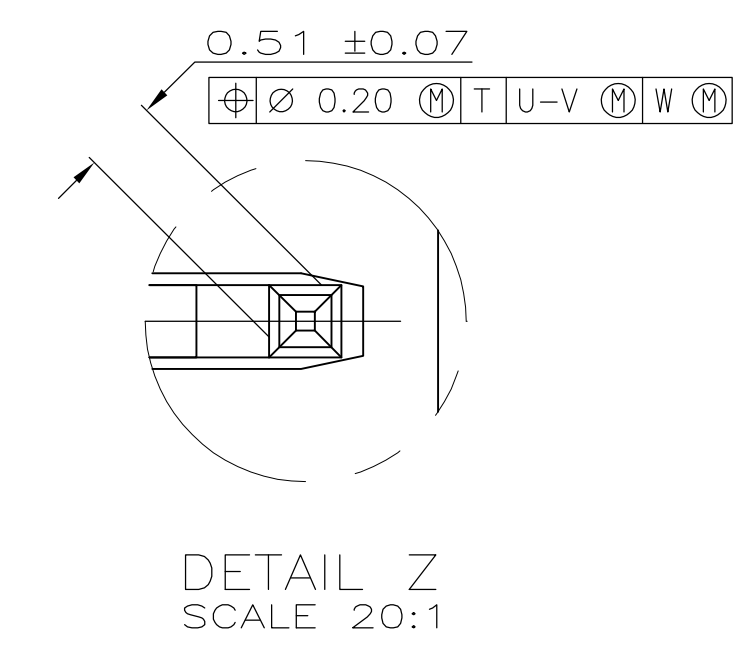

6.00	1	4.25	6.50	10.00	5	11.83	3	8	5536600-1
G	F	E	D	C	B	A	FINISH	NO OF POSN	PART NUMBER

THIS DRAWING IS A CONTROLLED DOCUMENT.		OWN D.R.BENDER 08/11/92	CHK R.L.BENDORF 09/03/92	APVD		NAME STE TE Connectivity	
DIMENSIONS: mm		TOLERANCES UNLESS OTHERWISE SPECIFIED:		PRODUCT SPEC		APPLICATION SPEC	
0 PL	±	1 PL	±	APVD		NAME	
2 PL	±	3 PL	± 0.13	PRODUCT SPEC		Z-PACK 2mm FB, POWER MODULE, PIN ASSEMBLY	
4 PL	±	ANGLES		APPLICATION SPEC		2mm CL, 4 ROW, TABLED MATING & LEAD LENGTHS	
MATERIAL		FINISH		WEIGHT		RESTRICTED TO	
1 2 3		3		-		SIZE CAGE CODE DRAWING NO	
CUSTOMER DRAWING		SCALE 4:1		SHEET 1 OF 1		REV P	