

Figure 1

NUMBER OF CIRCUITS	PLUG NUMBER	CAP NUMBER	CONNECTOR TYPE
2	480318-[]	480319-[]	Free-Hanging
2	480393-[]	---	Free-Hanging
3	480303-[]	480305-[]	Free-Hanging
3	480304-[]	480305-[]	Panel-Mount
3	480388-[]	480387-[]	Free-Hanging

1. INTRODUCTION

Each MATE-N-LOK Connector consists of two housings (a plug and a cap) and pin and socket contacts. The plug accepts socket contacts. See Figure 1. Read these instructions carefully before assembling the connector.

2. CONTACT CRIMPING

a. To determine which contacts to use in these housings, refer to TE Connectivity Instruction Sheet 408-7300.

b. Crimp contacts in strip form using the proper auto-machine applicator according to the instruction sheet shipped with the applicator.

c. Crimp loose piece (lp) contacts with the proper hand tool.

3. CONTACT INSERTION



Use pins only in cap. Use sockets only in plug.

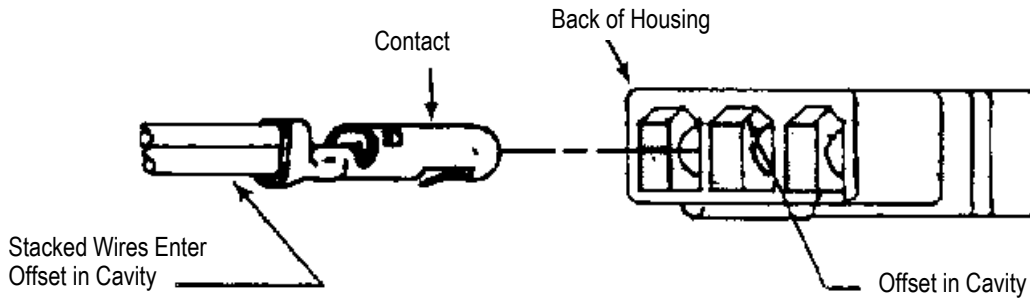
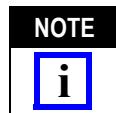

Figure 2

- a. For single-wire leads, push contact into housing as far as it will go. See Figure 1. Pull back lightly on wire to make sure contact is latched in place.
- b. For two-wire leads, first align contact with cavity as shown in Figure 2. Then push contact into housing and check to make sure it is properly inserted.
- c. For contacts crimped to small, flexible wire, use Insertion Tool 91002.



Be sure to stamp cutout from side of panel thru which housing will enter. See Figure 4.

- b. To install plug in panel, squeeze mounting legs together and push plug straight through panel (mating face first) until mounting leg engages panel. See Figure 4.

4. HOUSING ENGAGEMENT AND DISENGAGEMENT

- a. To mate housings, align index ribs on plug and cap and push plug into cap until detents on cap snap into indents in plug. See Figure 1.
- b. To disengage housings, simply pull them apart.

5. PANEL MOUNTING

- a. To mount plug to panel, first stamp cutout in panel using the dimensions in Figure 3.

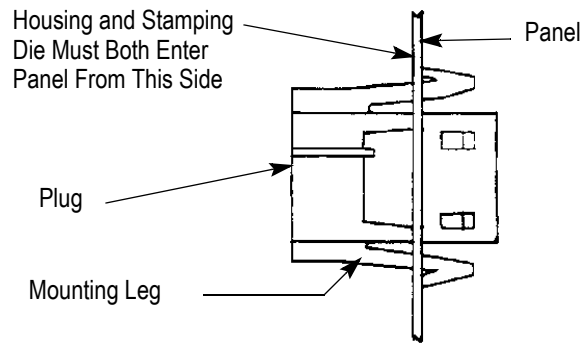
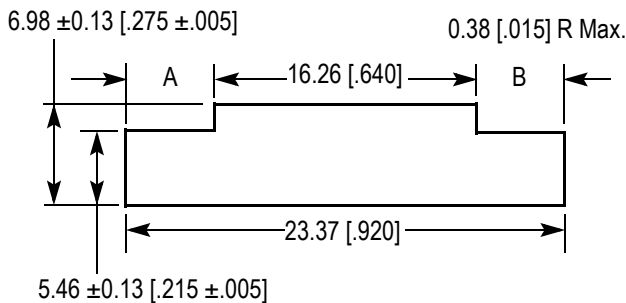

Figure 4



NOTE: Recommended Panel Thickness Range is 0.64-1.65 [.025-.065]. Dimensions A and B to be equal to 0.13 [.005].

Figure 3

6. CONTACT EXTRACTION

There are two types of extraction tools available. Use TE Tool 465644-1 to extract both pin and socket contacts when you can clearly see contacts as you look into front of housing and can easily reach rear of housing. If either view or access is restricted, use TE Tools 1-305183-1 (for pin contacts), and 1-305183-2 (for socket contacts).

7. REVISION SUMMARY

- Updated document to corporate requirements
- New logo