

REVISIONS					
P	LTR	DESCRIPTION	DATE	DWN	APVD
	F3	PART OBSOLESCENCE	26MAR2024	KA	SS

**MATERIAL:**  
 HOUSING: THERMOPLASTIC, UL94V-0, BLACK.  
 TERMINAL: M3 THREAD, BRIGHT TIN PLATED, COPPER ALLOY.  
 SCREWS: M3 THREAD ZINC PLATED STEEL, EXCEPT WHERE OTHERWISE NOTED.

**ELECTRICAL:**  
 RATED CURRENT: 10A.  
 OPERATING VOLTAGE: 300V.  
 WIRE RANGE: 16-30AWG .

**MECHANICAL:**  
 PITCH (TERMINAL SPACING): .250"  
 OPERATING TEMP.: 120°C MAX.

- ① SEE FIGURE.
- ② M3 SCREWS, ZINC PLATED STEEL AND M3 THREADED TERMINAL.
- 3 RUNNING TORQUE: 4 IN-LB MAX.
- ④ OBSOLETE PARTS: OBSOLETE CIS STREAMLINING PER D.RENAUD/D.SINISI

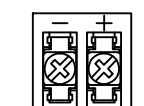
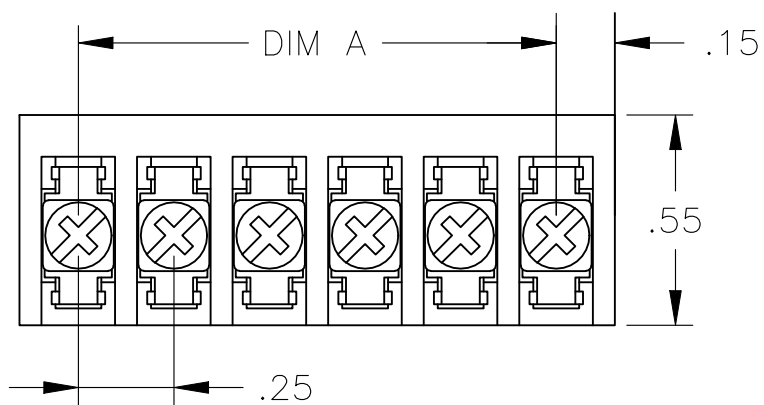

-2 1546119 1-

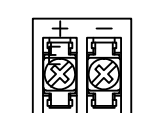

-2 1546119 2-

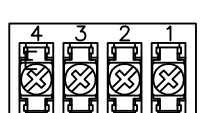

-2 796988 7-

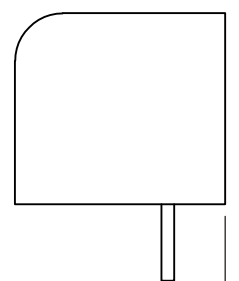
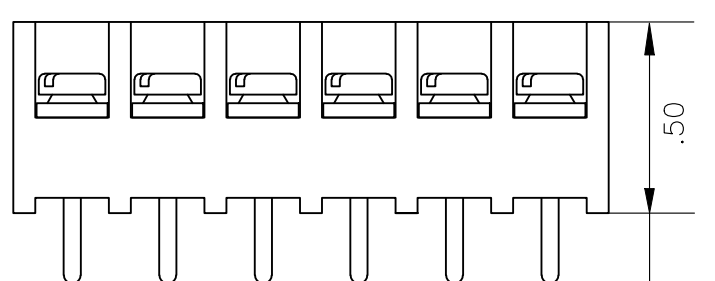

.169±.010

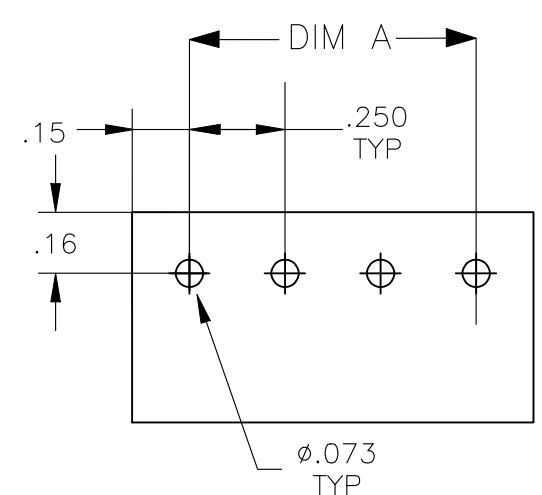

RECOMMENDED PCB LAYOUT

DIM. "A"	NO. OF POS.	CATALOG NUMBER	PART NO.
④ .25	2	3PCV-02-006-SPL	<del>796597-3</del>
7.25	30	3PCV-30-006	4-1546119-3
7.00	29	3PCV-29-006	2-1546533-9
④ 6.75	28	3PCV-28-006	<del>2-1546533-8</del>
6.50	27	3PCV-27-006	2-1546533-7
6.25	26	3PCV-26-006	4-1546119-2
6.00	25	3PCV-25-006	2-1546533-5
5.75	24	3PCV-24-006	4-1546119-1
5.50	23	3PCV-23-006	2-1546533-3
④ 5.25	22	3PCV-22-006	<del>3-1546119-9</del>
5.00	21	3PCV-21-006	2-1546533-1
② 4.75	20	3PCV-20-308	796597-2
4.75	20	3PCV-20-006	796597-1
4.50	19	3PCV-19-006	1-1546533-9
④ 4.25	18	3PCV-18-006	<del>3-1546119-7</del>
④ 4.00	17	3PCV-17-006	<del>3-1546119-6</del>
3.75	16	3PCV-16-006	7-1437646-8
3.50	15	3PCV-15-006	7-1437646-5
3.25	14	3PCV-14-006	7-1437646-3
3.00	13	3PCV-13-006	3-1546119-2
2.75	12	3PCV-12-006	6-1437646-7
2.50	11	3PCV-11-006	2-1546119-9
2.25	10	3PCV-10-006	6-1437646-2
2.00	9	3PCV-09-006	5-1437646-9
1.75	8	3PCV-08-006	5-1437646-7
1.50	7	3PCV-07-006	5-1437646-4
1.25	6	3PCV-06-006	5-1437646-0
1.00	5	3PCV-05-006	4-1437646-5
④ ① .75	4	3PCV-04-006-SPL	<del>2-796988-7</del>
.75	4	3PCV-04-006	4-1437646-2
④ .50	3	3PCV-03-006	<del>3-1437646-9</del>
④ ① .25	2	3PCV-02-297	<del>2-1546119-2</del>
④ ① .25	2	3PCV-02-296	<del>2-1546119-1</del>
④ ① .25	2	3PCV-02-006	3-1437646-3

THIS DRAWING IS A CONTROLLED DOCUMENT.		DWN S SCHLEGEL 24MAR2003	<b>STE</b> TE Connectivity	
DIMENSIONS: INCHES		CHK S YODER 24MAR2003		
TOLERANCES UNLESS OTHERWISE SPECIFIED:		APVD S YODER 24MAR2003	NAME 3PCV-XX-006 ASSEMBLY	
0 PLC ± -	1 PLC ± -	PRODUCT SPEC -	SIZE A3	
2 PLC ± 0.02	3 PLC ± 0.01	APPLICATION SPEC -	CAGE CODE 00779	DRAWING NO C-4-1437646-2
4 PLC ± -	ANGLES ± -	WEIGHT -	RESTRICTED TO -	
MATERIAL -	FINISH -	CUSTOMER DRAWING		
SCALE 1			SHEET 1 OF 1	REV F3