

4

3

2

1

THIS DRAWING IS UNPUBLISHED. RELEASED FOR PUBLICATION
 © COPYRIGHT - By - ALL RIGHTS RESERVED.

| REVISIONS | | | | | |
|-----------|-----|---------------------------|-----------|-----|------|
| P | LTR | DESCRIPTION | DATE | DWN | APVD |
| B1 | | REVISED PER ECO-14-012833 | 21AUG2014 | NK | DR |
| B2 | | REVISED PER ECO-17-008806 | 20FEB2018 | RS | DR |

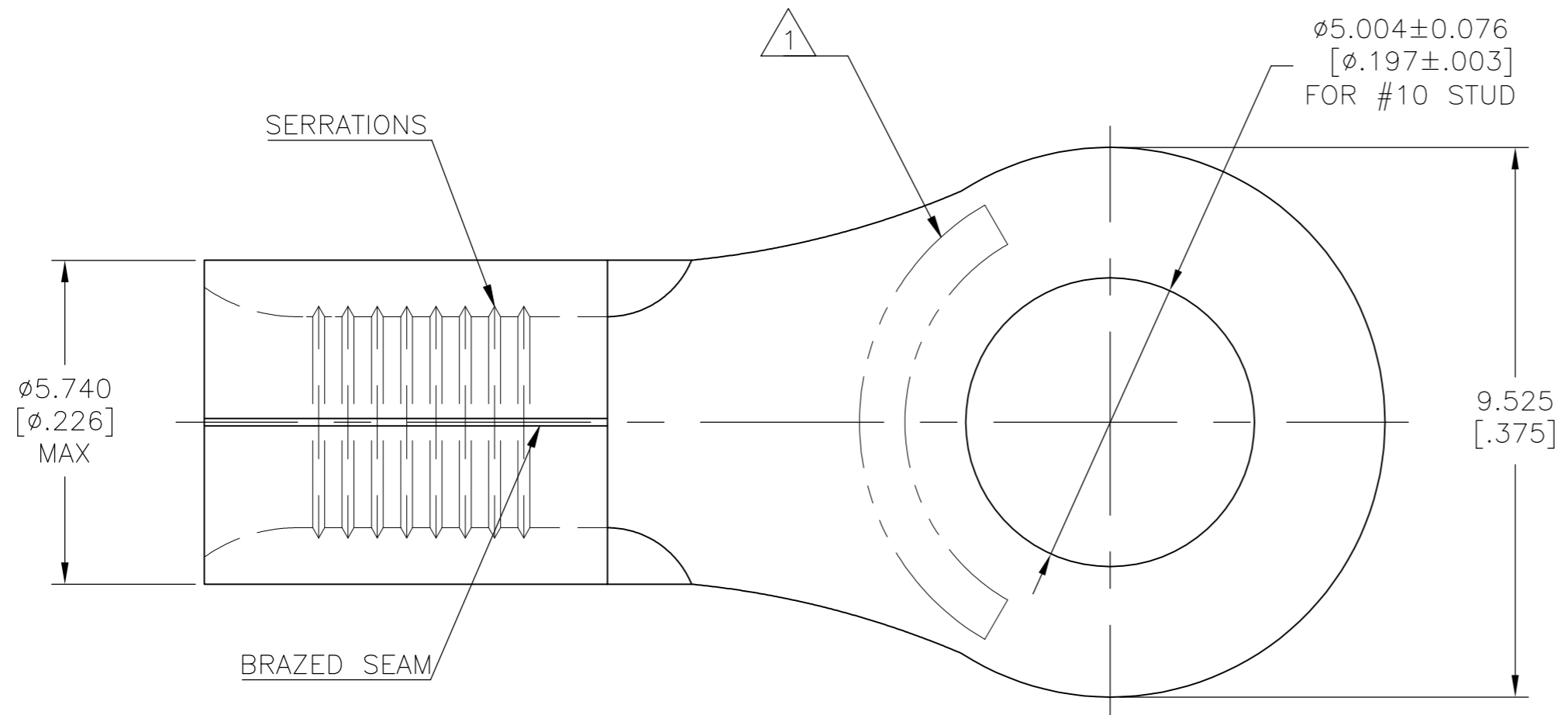

| | |
|--------------------------------|---------------------------|
| AMP WIRE RANGE | E13288 Listed |
| 12-10 AWG SOLID OR STRANDED | 12-10 AWG STRANDED |
| LR7189 Certified | MILITARY P/N AND CLASS |
| 12-10 AWG SOLID OR STRANDED | NOT APPLICABLE |

- 1 STAMP AMP 12-10* APPROX AS SHOWN.
- 2 NOTE DELETED

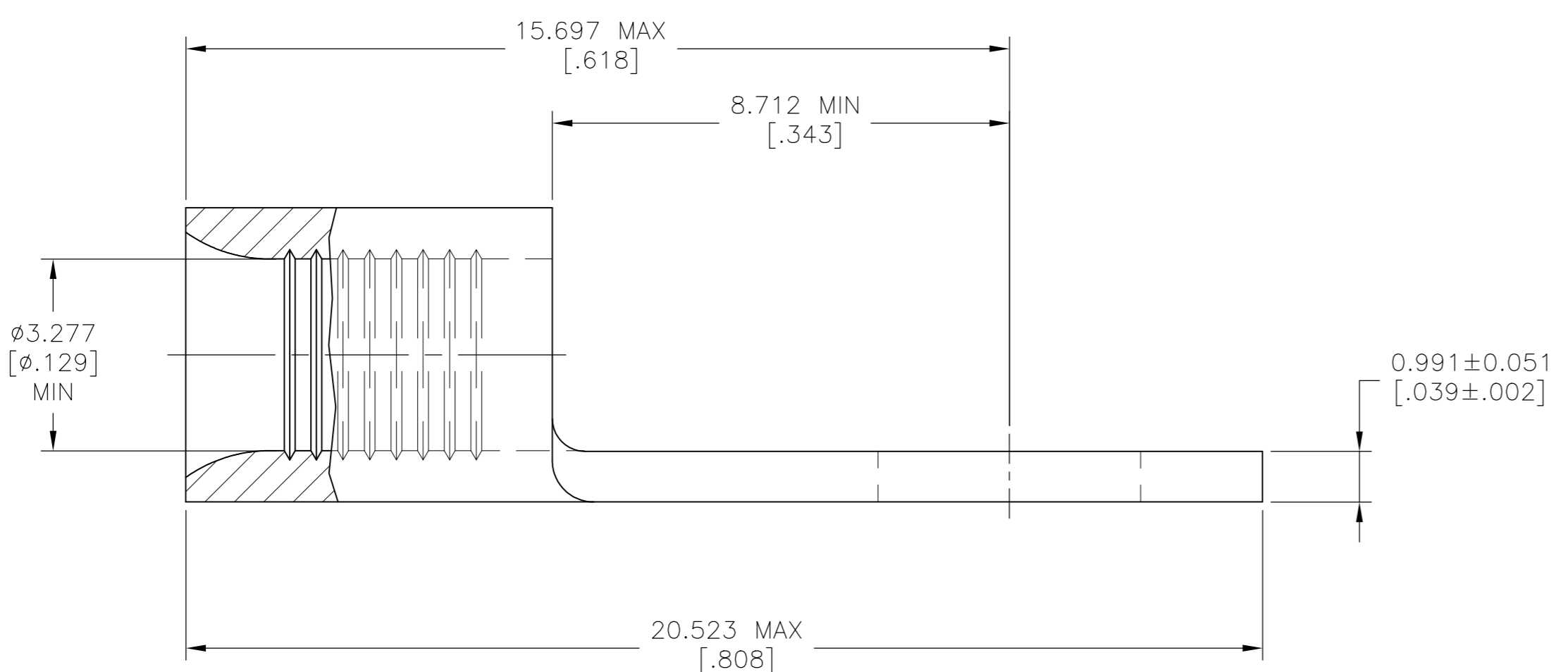

| | | |
|--|--|---|
| AMP INCORPORATED CUSTOMER SERVICE SYSTEMS | | MAX RECOMMENDED OPERATING TEMPERATURE: 170°C [338°F] MAX |
| FOR ADDITIONAL PRODUCT INFORMATION OR COPIES OF DRAWINGS AND TECHNICAL DOCUMENTS | PRODUCT INFORMATION CENTER 1-800-522-6752 | VOLTAGE RATING: NOT APPLICABLE |
| FOR APPLICATION TOOLING INFORMATION | TOOLING ASSISTANCE CENTER 1-800-722-1111 | WIRE CROSS SECTIONAL AREA RANGE: 2.62-6.64mm ² [5,180-13,100] CIR MILS SOLID OR STRANDED |
| FOR ORDER ENTRY | 1-800-526-5142 | THIS DRAWING IS A CONTROLLED DOCUMENT FOR AMP INCORPORATED. IT IS SUBJECT TO CHANGE AND THE CONTROLLING ENGINEERING ORGANIZATION SHOULD BE CONTACTED FOR THE LATEST REVISION. |

| | | |
|-----|--------------|-------------|
| 500 | LOOSE PIECE | 31805 |
| QTY | PACKAGE TYPE | PART NUMBER |

| | | | | |
|--|--|-----------------------------|----------------------|---------|
| THIS DRAWING IS A CONTROLLED DOCUMENT. | | DWN TA BRINKMAN 3-17-93 | TE Connectivity Ltd. | |
| DIMENSIONS: mm [INCHES] | | CHK DA PATTERSON 3-17-93 | NAME | |
| TOLERANCES UNLESS OTHERWISE SPECIFIED: | | APVD DE MILLER 3-17-93 | PRODUCT SPEC | |
| 0 PLC ± - | | UL 486 A-B | | |
| 1 PLC ± - | | APPLICATION SPEC | | |
| 2 PLC ± - | | SIZE | | |
| 3 PLC ± 0.127[.005] | | CAGE CODE | | |
| 4 PLC ± - | | DRAWING NO | | |
| ANGLES ± - | | RESTRICTED TO | | |
| MATERIAL COPPER PER ASTM B-152 ANNEALED | FINISH TIN PLATE 0.00254[.000100] MIN THK PER ASTM B545 | WEIGHT | A2 00779 | C=31805 |
| CUSTOMER DRAWING | | SCALE | SHEET | REV |
| | | 1:1 | 1 of 1 | B2 |