

4

3

2

1

THIS DRAWING IS UNPUBLISHED. RELEASED FOR PUBLICATION 20
 © COPYRIGHT 20 BY - ALL RIGHTS RESERVED.

LOC	DIST	REVISIONS			
P	LTR	DESCRIPTION	DATE	DWN	APVD
FT	0	J1	REVISED PER ECO-12-007714	28APR2012	KH MS

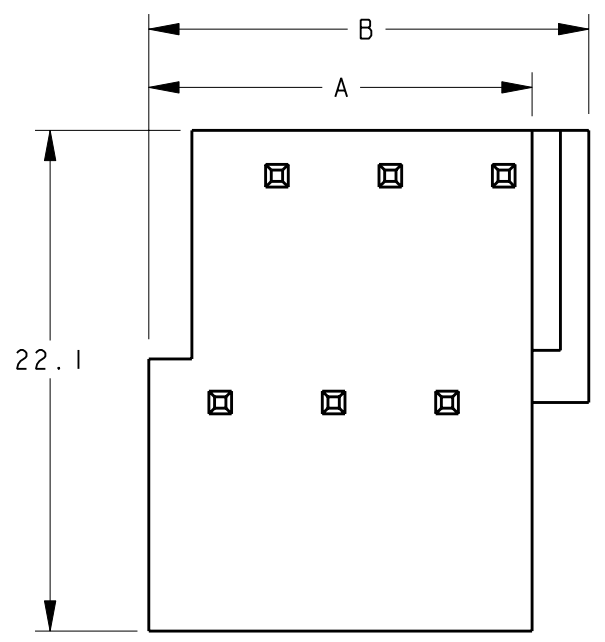

- 1 MATERIALS AND FINISH
HOUSING: PA 6-6, UL 94-V0, COLOR GREEN.
TERMINAL: COPPER ALLOY, TIN PLATED.
- 2 SUITABLE FOR 1,6-2,4mm PC BOARD THICKNESS.
- 3 NOT CUMULATIVE TOLERANCE.
- 4 P/N FROM 284060-4 TO 2-284060-5 ARE OBTAINED BY ASSEMBLING DIFFERENT MONOLITHIC MODULES CHOSEN AMONG: 284060-2 AND 284060-3, IN ORDER TO REALIZE THE DESIRED NUMBER OF WAYS.
- 5 OBSOLETE

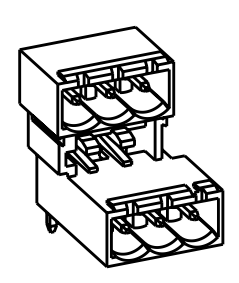

284060-3 AS SHOWN

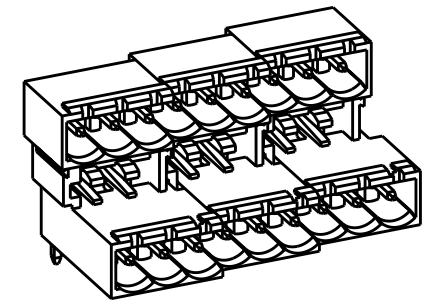

EXPLODED VIEW 284060-9

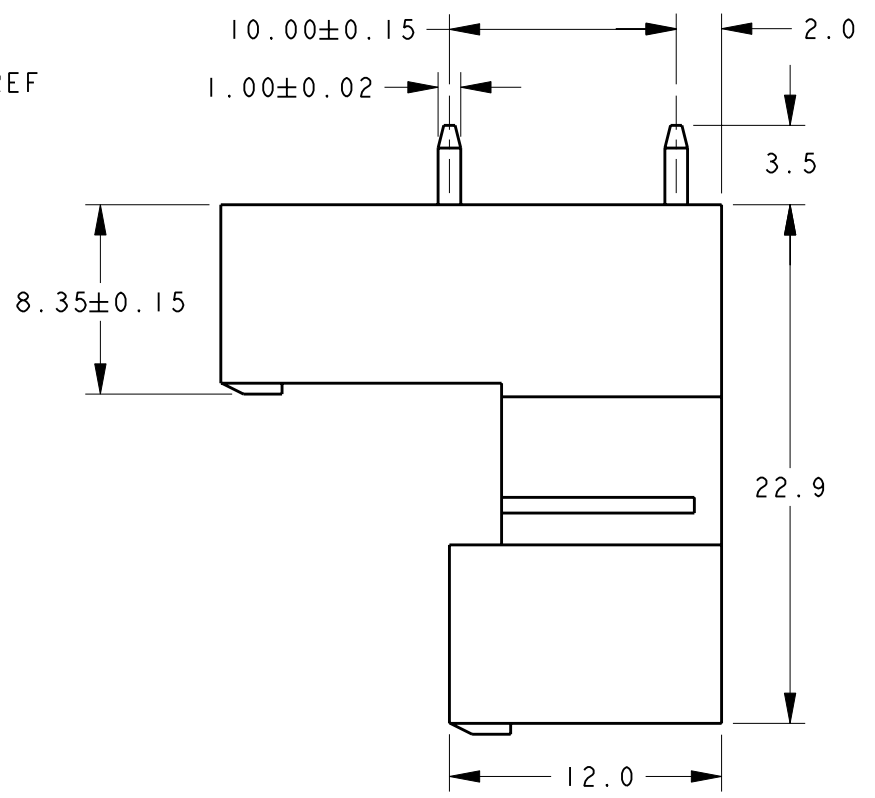
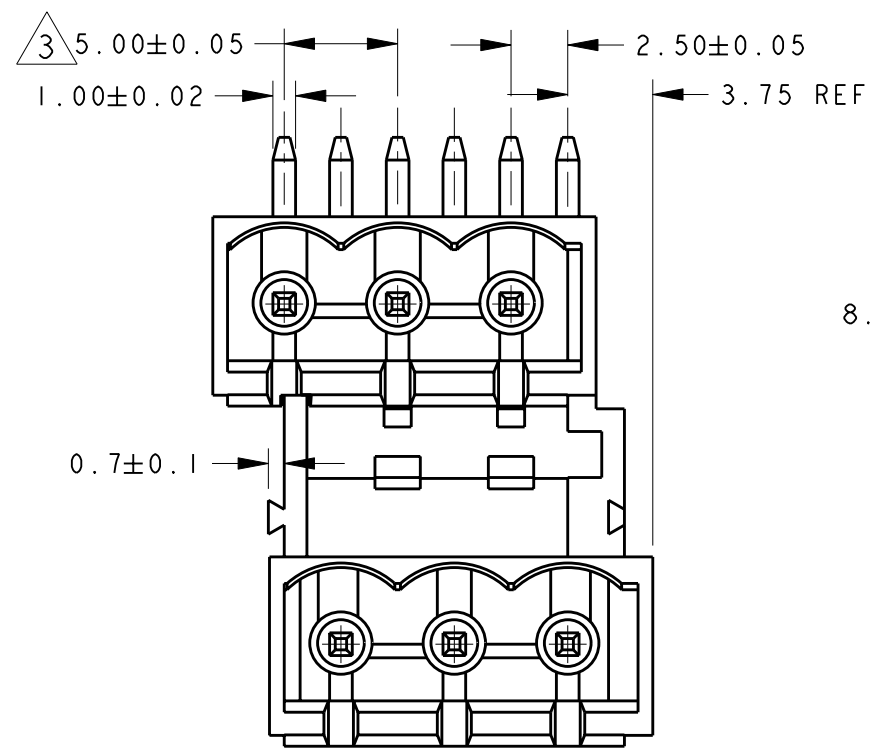

5	127	129.5	25	2-284060-5
5	122	124.5	24	2-284060-4
5	117	119.5	23	2-284060-3
5	112	114.5	22	2-284060-2
5	107	109.5	21	2-284060-1
5	102	104.5	20	2-284060-0
5	97	99.5	19	1-284060-9
5	92	94.5	18	1-284060-8
5	87	89.5	17	1-284060-7
5	82	84.5	16	1-284060-6
5	77	79.5	15	1-284060-5
5	72	74.5	14	1-284060-4
5	67	69.5	13	1-284060-3
5	62	64.5	12	1-284060-2
5	57	59.5	11	1-284060-1
5	52	54.5	10	1-284060-0
5	47	49.5	9	284060-9
5	42	44.5	8	284060-8
5	37	39.5	7	284060-7
5	32	34.5	6	284060-6
5	27	29.5	5	284060-5
5	22	24.5	4	284060-4
5	17	19.5	3	284060-3
5	12	14.5	2	284060-2

RECOMMENDED PC BOARD LAYOUT

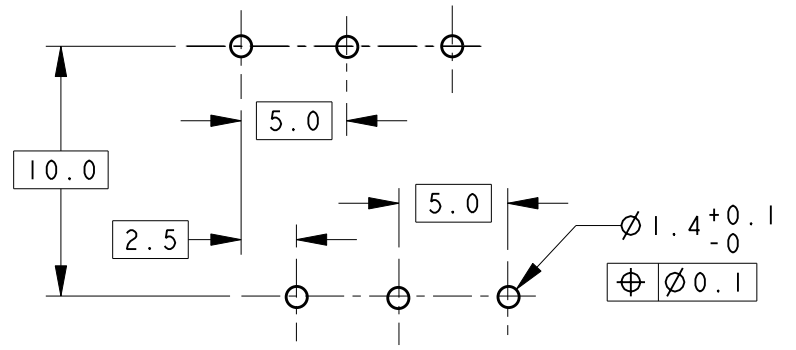

THIS DRAWING IS A CONTROLLED DOCUMENT.		DWN 24JAN2002 E. ZANOLINI	 TE Connectivity	
DIMENSIONS: mm		CHK 24JAN2002 E. ZANOLINI		
TOLERANCES UNLESS OTHERWISE SPECIFIED:		APVD 24JAN2002 D. BIEVENOUR	NAME TERMINAL BLOCK MULTIPLE HEADER 90 DEGREE CLOSED ENDS 5.0mm PITCH	
0 PLC ±.3 1 PLC ±.25 2 PLC ±. 3 PLC ±. 4 PLC ±. ANGLES ±2		PRODUCT SPEC -	SIZE CAGE CODE DRAWING NO RESTRICTED TO A3 00779 C-284060 -	
MATERIAL	FINISH	APPLICATION SPEC -	SCALE SHEET OF REV	
		WEIGHT -	3:1 1 OF 1 J1	
CUSTOMER DRAWING				