

THIS DRAWING IS UNPUBLISHED. RELEASED FOR PUBLICATION 11SEP2011
 © COPYRIGHT 2011 BY Tyco Electronics Japan G.K. ALL RIGHTS RESERVED.

LOC		DIST		REVISIONS			
P	LTR	DESCRIPTION	DATE	DWN	APVD		
A		RELEASED	24OCT2012	T.S	N.Y		
B		REVISED	11NOV2013	T.S	N.Y		

- 1 MATERIAL
 BODY HOUSING:
 HIGH TEMPERATURE THERMOPLASTIC, BLACK, UL94V-0
 INSERT HOUSING:
 HIGH TEMPERATURE THERMOPLASTIC, BLACK, UL94V-0
 LIGHT PIPE HOUSING:
 HIGH TEMPERATURE THERMOPLASTIC, CLEAR, UL94V-2
 TERMINALS:
 0.32mm THICKNESS PHOSPHOR BRONZE PLATED WITH
 2µmMIN BRIGHT TIN IN SOLDER AREA,
 1.27µmMIN GOLD IN CONTACT AREA,
 ALL OVER 1.27µmMIN NICKEL
 SHIELD:
 0.2mm THICKNESS PHOSPHOR BRONZE PRE-PLATED
 1.27µmMIN SEMI-BRIGHT NICKEL,
 2.0µmMIN BRIGHT TIN ON PCB GROUND TABS
- 2 SUGGESTED PANEL OPENING DIMENSIONS
- 3 SUGGESTED PNAEL LOCATION POINT

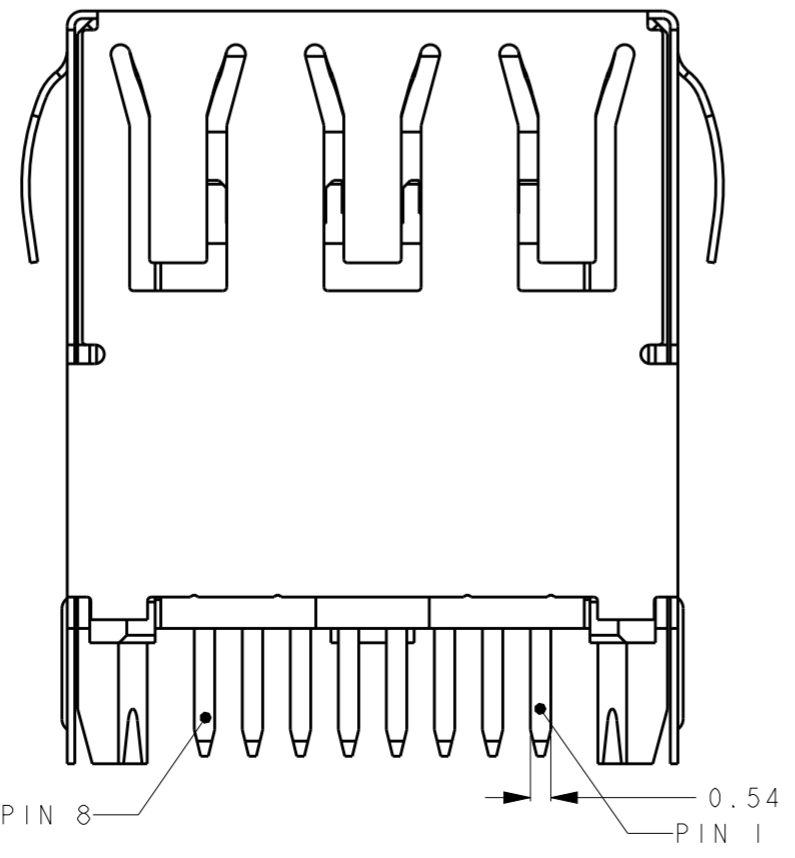
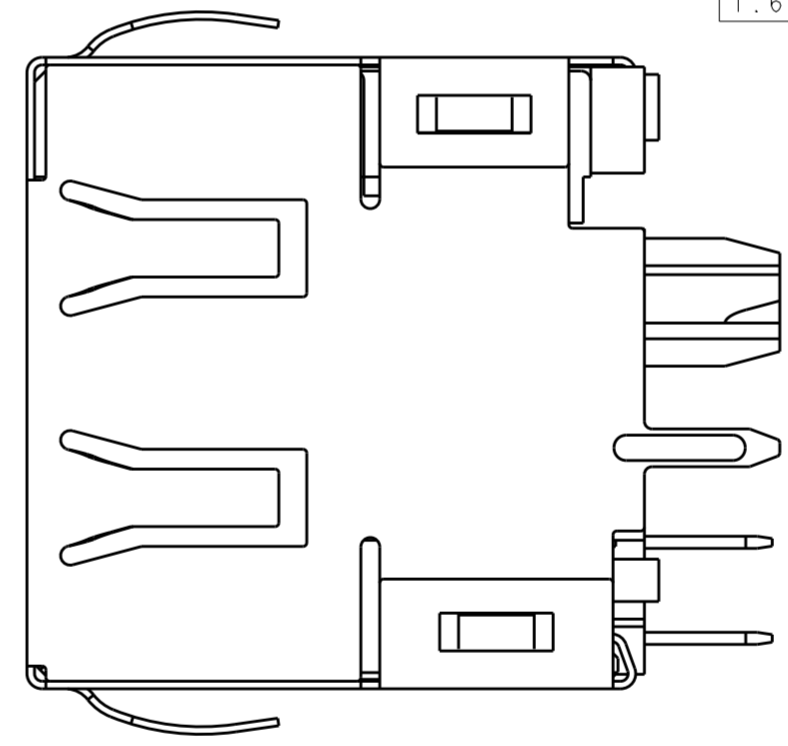
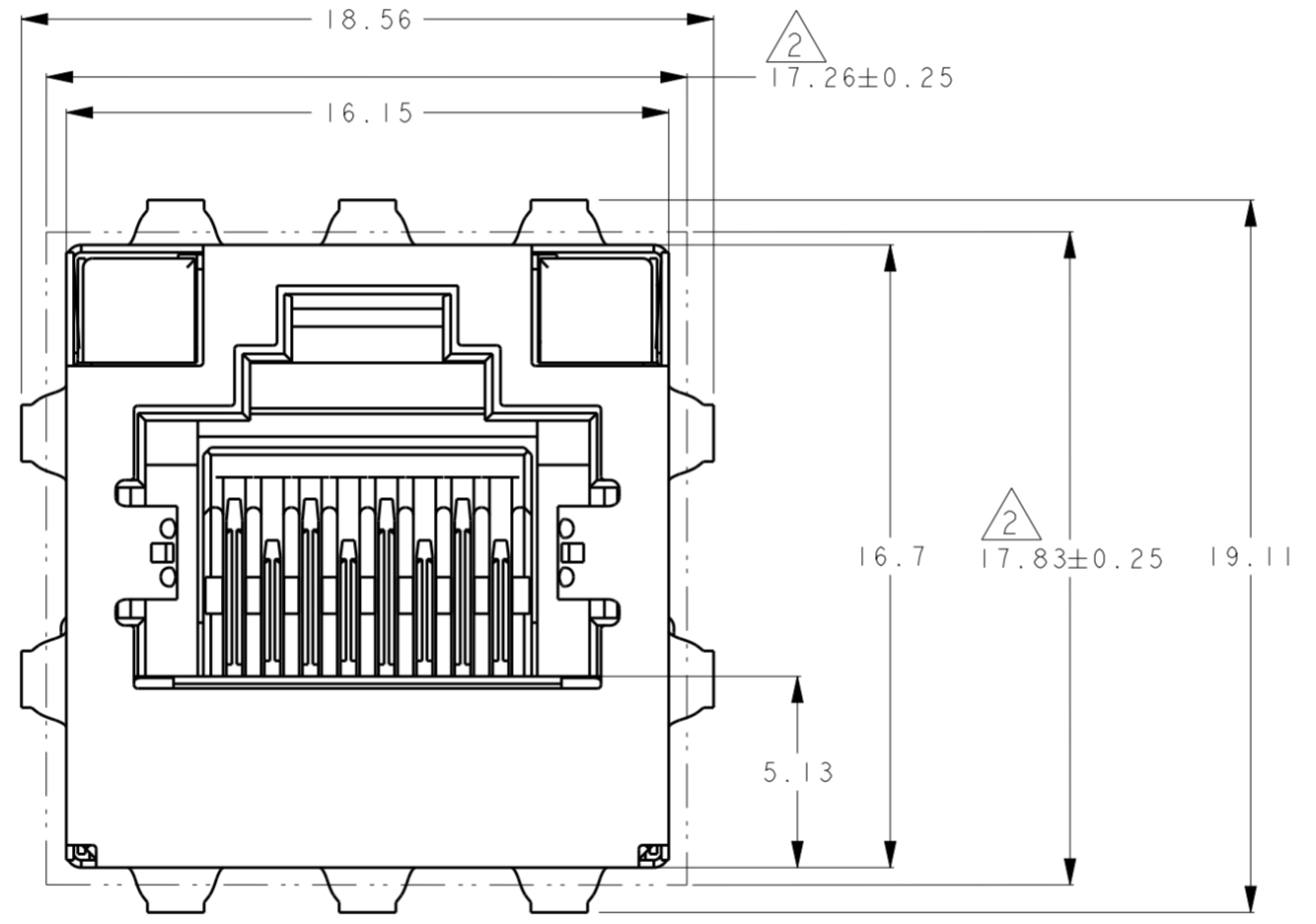
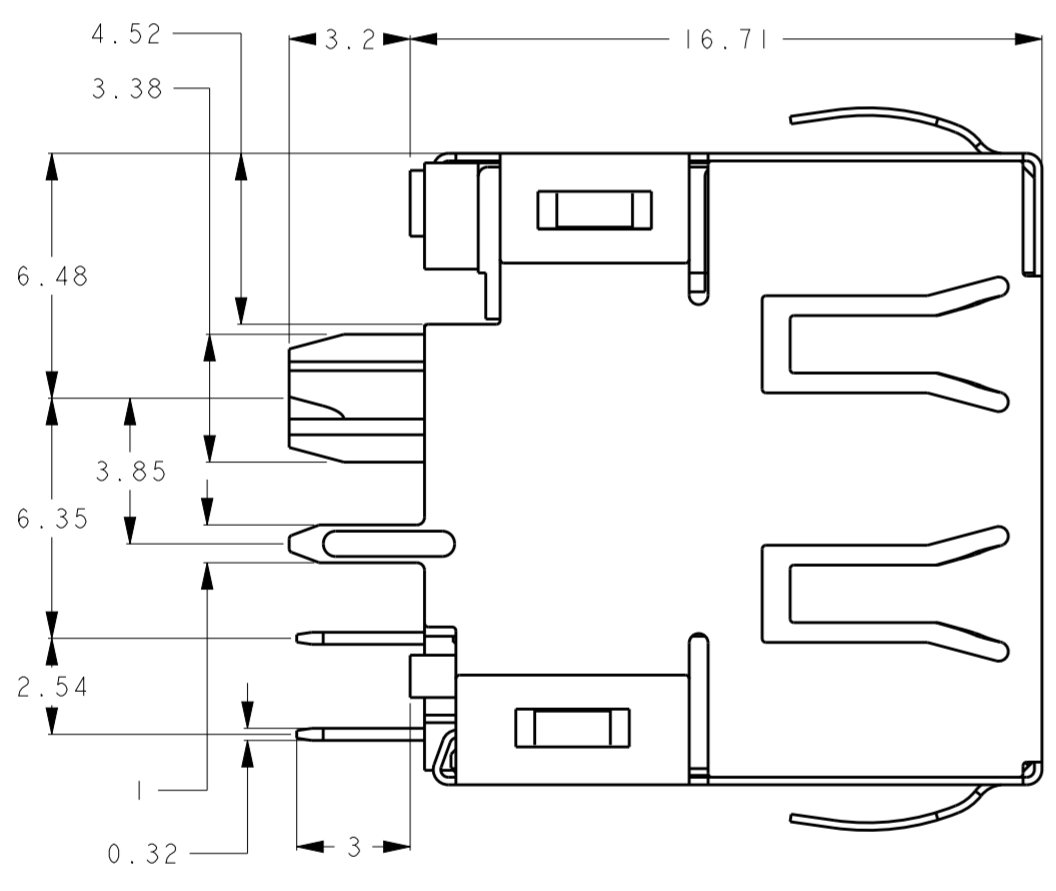
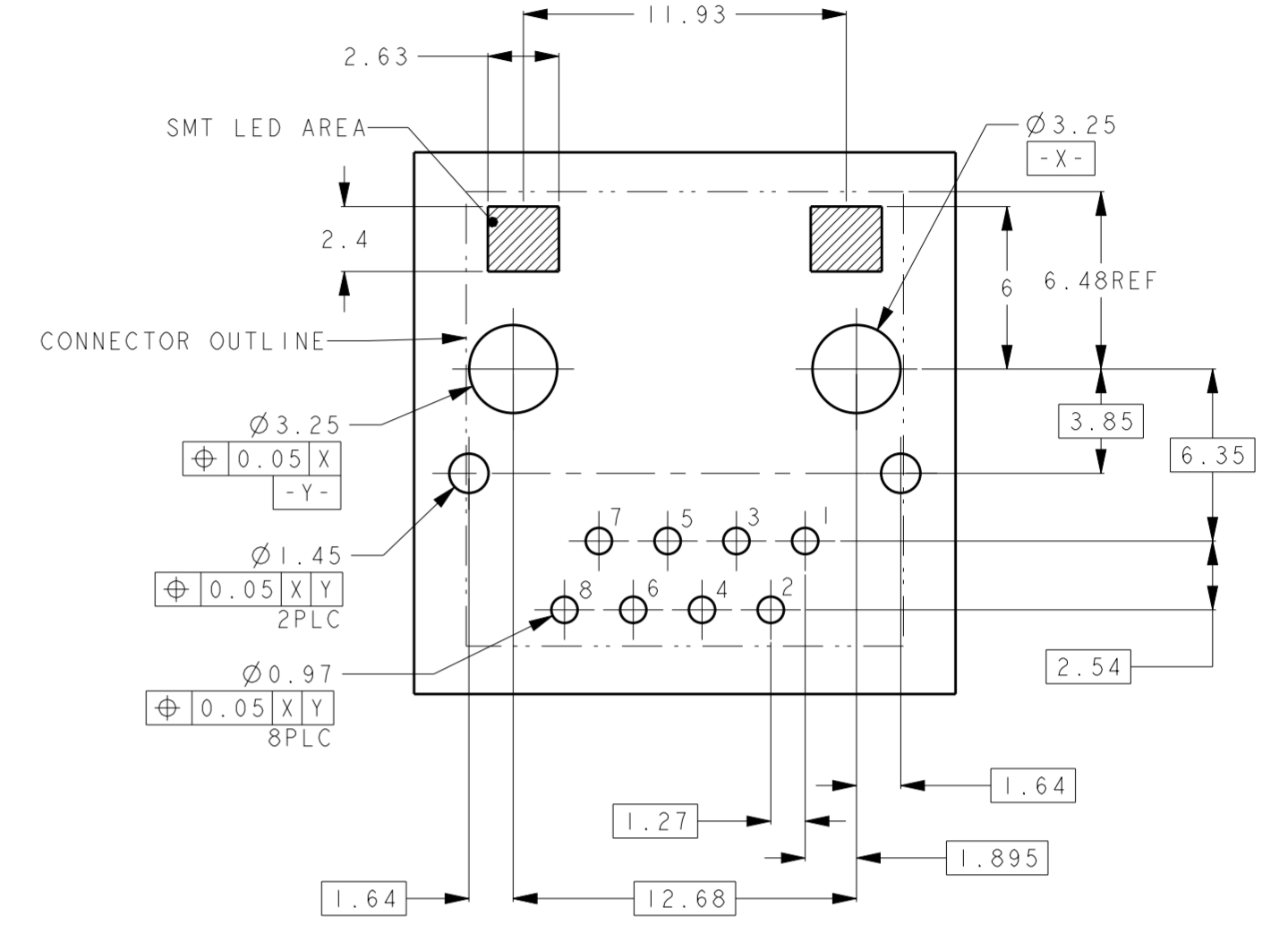
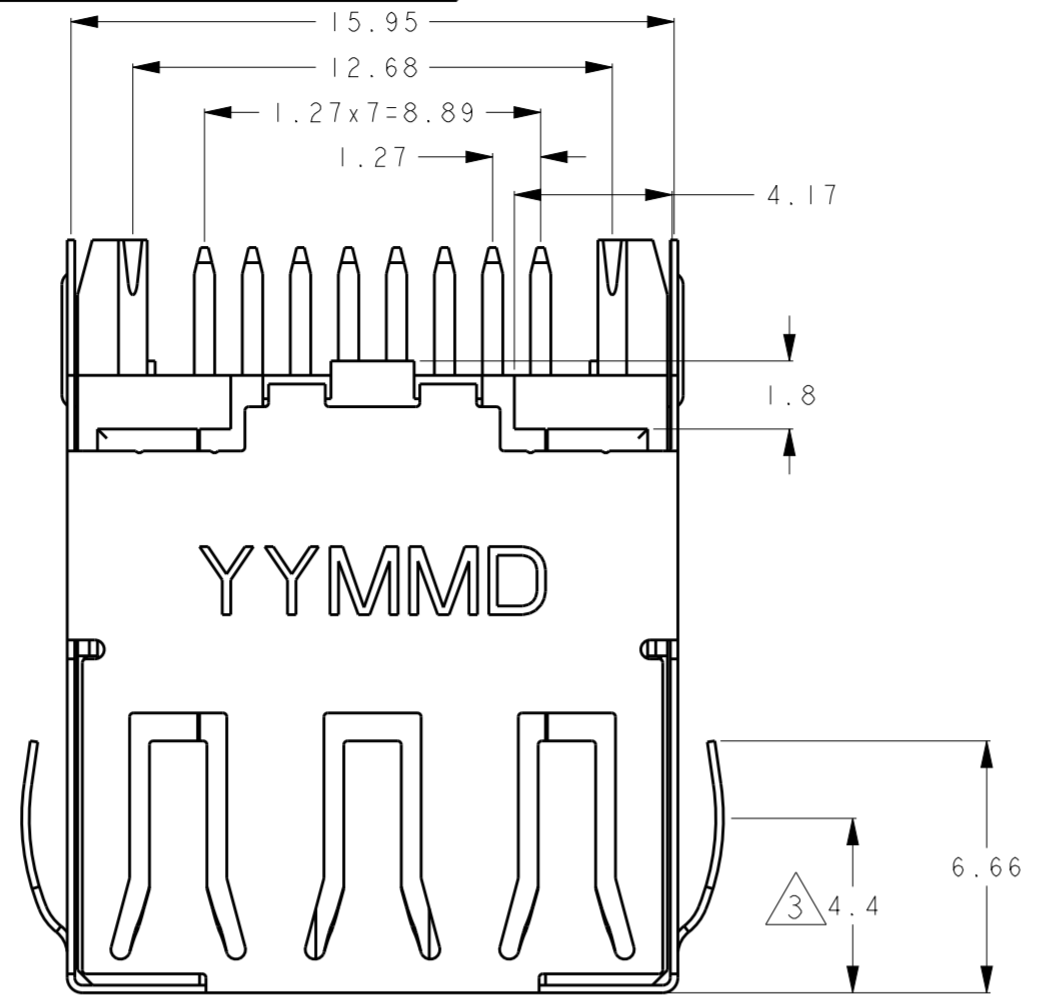

THIS DRAWING IS A CONTROLLED DOCUMENT.

DIMENSIONS: □□□ mm	TOLERANCES UNLESS OTHERWISE SPECIFIED: □□□ ±0.3 0-PLC ± 1-PLC ±0.1 2-PLC ±0.01 3-PLC ±0.001 4-PLC ±0.0001 ANGLES ±5°	DWN T. SHIMOYASU 24OCT2012 CHK M. HARASAWA 24OCT2012 APVD N. YAMASAKI 24OCT2012	TE Connectivity RJ45 MODULAR JACK TOP ENTRY TYPE 8POS
MATERIAL	FINISH	PRODUCT SPEC 108-78909 APPLICATION SPEC	
WEIGHT 5.75g		SIZE A2	CAGE CODE 0779
CUSTOMER DRAWING		DRAWING NO. C-2201061	RESTRICTED TO

1471-9 (3/11)