

NUMBER C-179464



METRIC

PRINT DIM. DIMENSIONS IN MM. DO NOT SCALE PRINT

PRINT DIST

- 注:
1. 通用製品規格: 108-5410
 2. 通用コンタクト型番
タブ・コンタクト: 177917-□ (#20-#16AWG)
177916-□ (#26-#22AWG)
 3. 嵌合相手側製品型番
プラグ・ハウジング: 177899-□
リセ・コンタクト: 177915-□ (#20-#16AWG)
177914-□ (#26-#22AWG)
 4. 通用プレート型番: 177919-□
 5. 取扱説明書: 411-5638
- 表1参照
8. PART 5-179464-1 COMPLY WITH GLOW WIRE REQUIREMENT FOR PARTS OF NON-METALLIC MATERIAL SUPPORTING A CURRENT-CARRYING CONNECTION DETAILED IN IEC 60335-1, SECTION 30 (GWT)
 9. APPLICATION SPEC: 114-5175

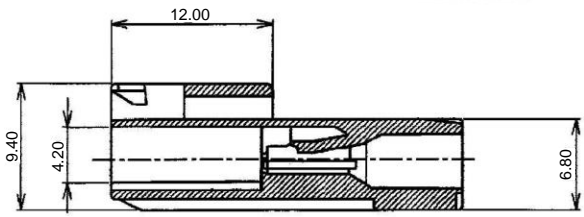
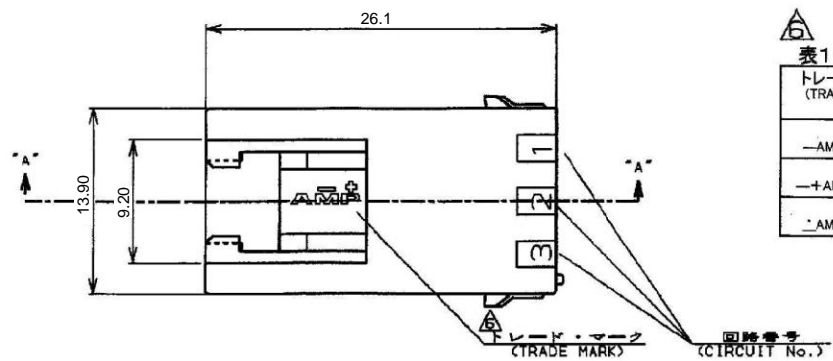

断面 "A-A" (SECT)

表1 (TABLE 1)

トレードマーク (TRADE MARK)	生産場所 (MANUFACTURING PLACE)
— AMP OR AMP	日本 (JAPAN)
—+ AMP OR AMP	中国 (CHINA(PO))
· AMP OR AMP	韓国 (KOREA)

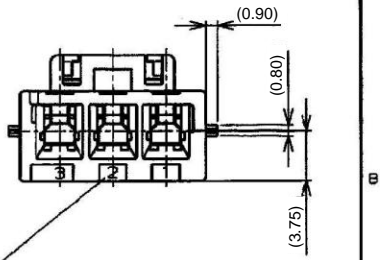

回路番号 (CIRCUIT No.)

- NOTES,
1. PRODUCT SPEC, 108-5410
 2. APPLICABLE CONTACT P/N
TAB CONTACT: 177917-□ (#20-#16AWG)
177916-□ (#26-#22AWG)
 3. MATING CONN. P/N
PLUG H56, 177899-□
REC CONTACT: 177915-□ (#20-#16AWG)
177914-□ (#26-#22AWG)
 4. APPLICABLE PLATE P/N: 177919-□
 5. INSTRUCTION SHEET: 411-5638
 6. SEE TABLE 1
 7. ALL PARTS MEET RTI ELECTRICAL RATING OF 105C ACCORDING TO UL 1977

自然色 (NATURAL)	3	5-179464-1
黒 (BLACK)	↑	↑
青 (BLUE)	↑	↑
黄 (YELLOW)	↑	↑
赤 (RED)	↓	↓
自然色 (NATURAL)	3	179464-1
ハウジング色調 係数 (HOUSING COLOR) (Pos.)		型番 (P/N)

REVISED PER	BY	DATE	REASON	DATE	BY	DATE	REASON
C5		20SEP 2023					
C4		21NOV 2019					
C3		11FEB '14					
C2		02AUG '12					
C1		09MAY '11					
LTR							

規格 (SPEC)	適用範囲 (INSULATION DIA.)	名称 (NAME)	アンペア パワー ダブルロック コネクタ
3.95mmピッチ	キャット	ハウジング (直吊りタイプ)	
AMP POWER DOUBLE LOCK CONN. 3.95mm PITCH CAP HOUSING 3 Pos OF RES HANGING			
材質 (MATERIAL)	仕上げ (FINISH)	寸法 (DIMENSIONS)	SIZE
6/6 ナイロン (UL94V-0)			A3 J
6/6 NYLON (UL94V-0)			
DR. 23.MAR.'94	DE. 23.MAR.'94	図番 (No.)	C-179464
M. SUZUKI	M. SUZUKI	尺度 (SCALE)	REV. C5
CHK. 25.MAR.'94	APP. 25.MAR.'94	シート (SHEET)	1 OF 1
M. SHINDO	Y. KASHIWA		

CUSTOMER DRAWING