

REVISIONS				
P	LTN	DESCRIPTION	DATE	APVD
B		REVISED PER ECR-20-100642	19SEP2022	M, G, D, Z

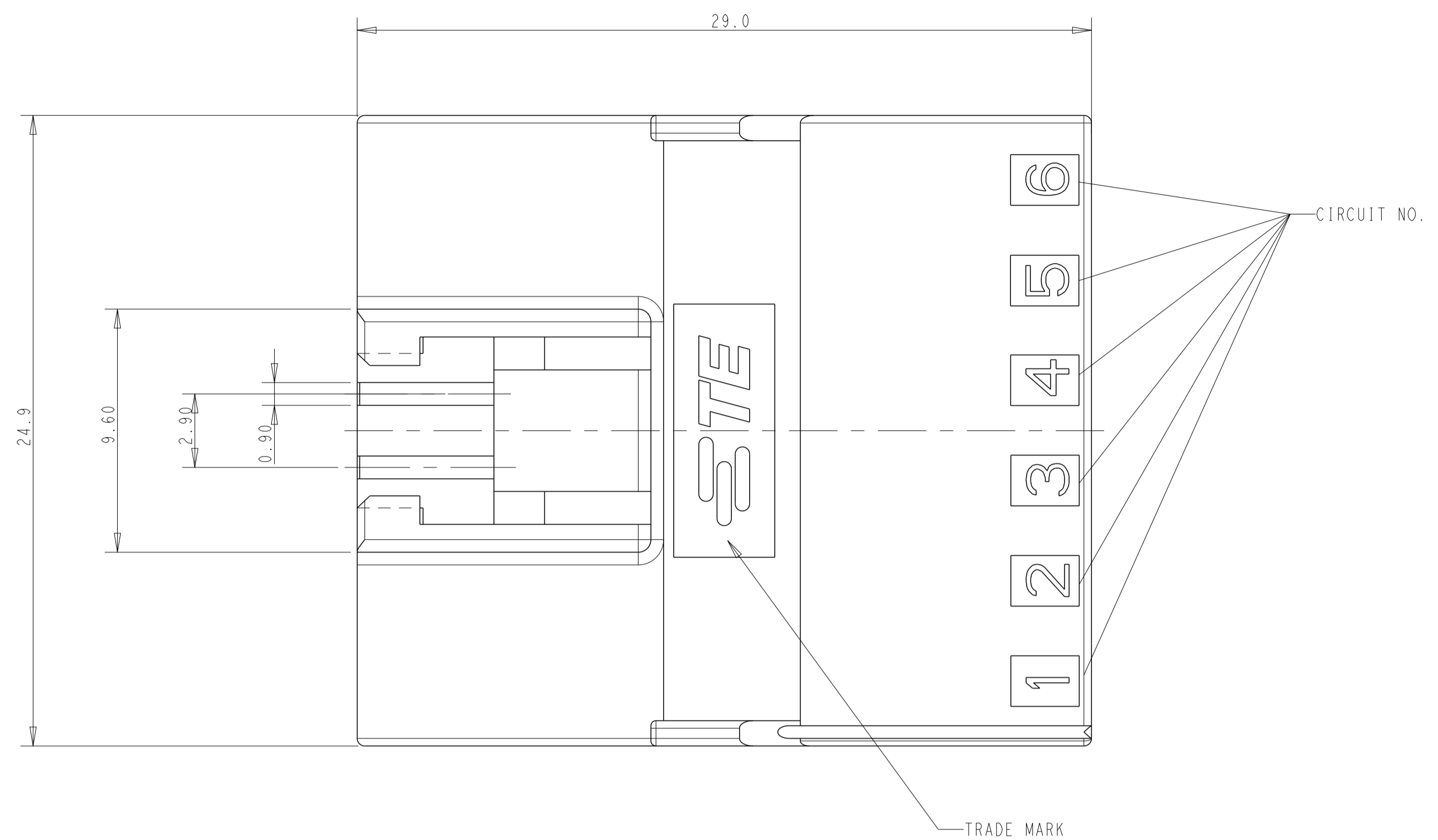

- NOTES:
- APPLICABLE CONTACT P/N:
 TAB CONTACT: 175150- (20-16 AWG)
 175149- (26-22 AWG)
 - MATING CONN. P/N:
 PLUG HSG: 176280-
 REC CONTACT: 175152- (20-16AWG)
 175151- (20-22AWG)
 - INSTRUCTION SHEET: IS-503J.

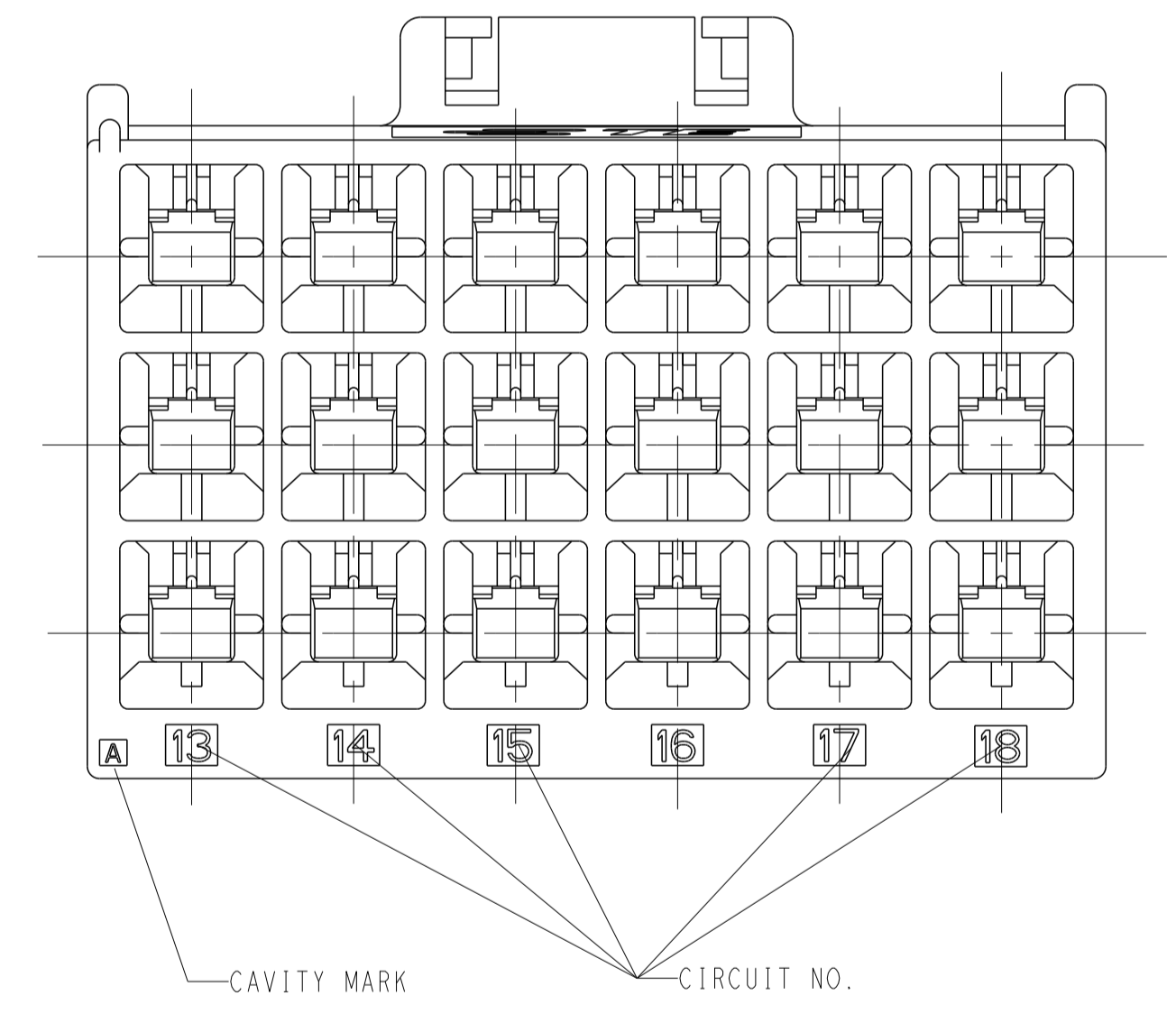
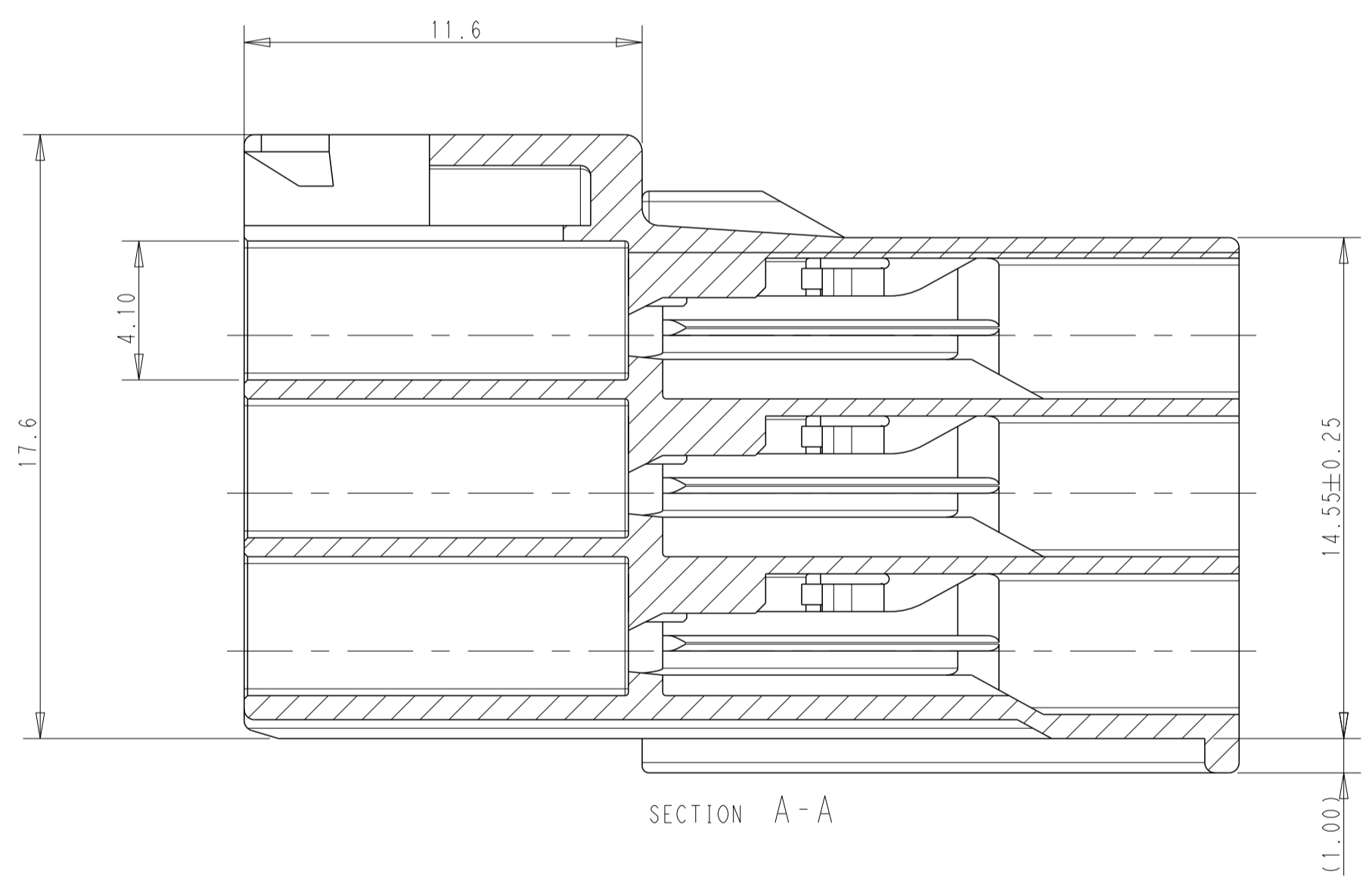
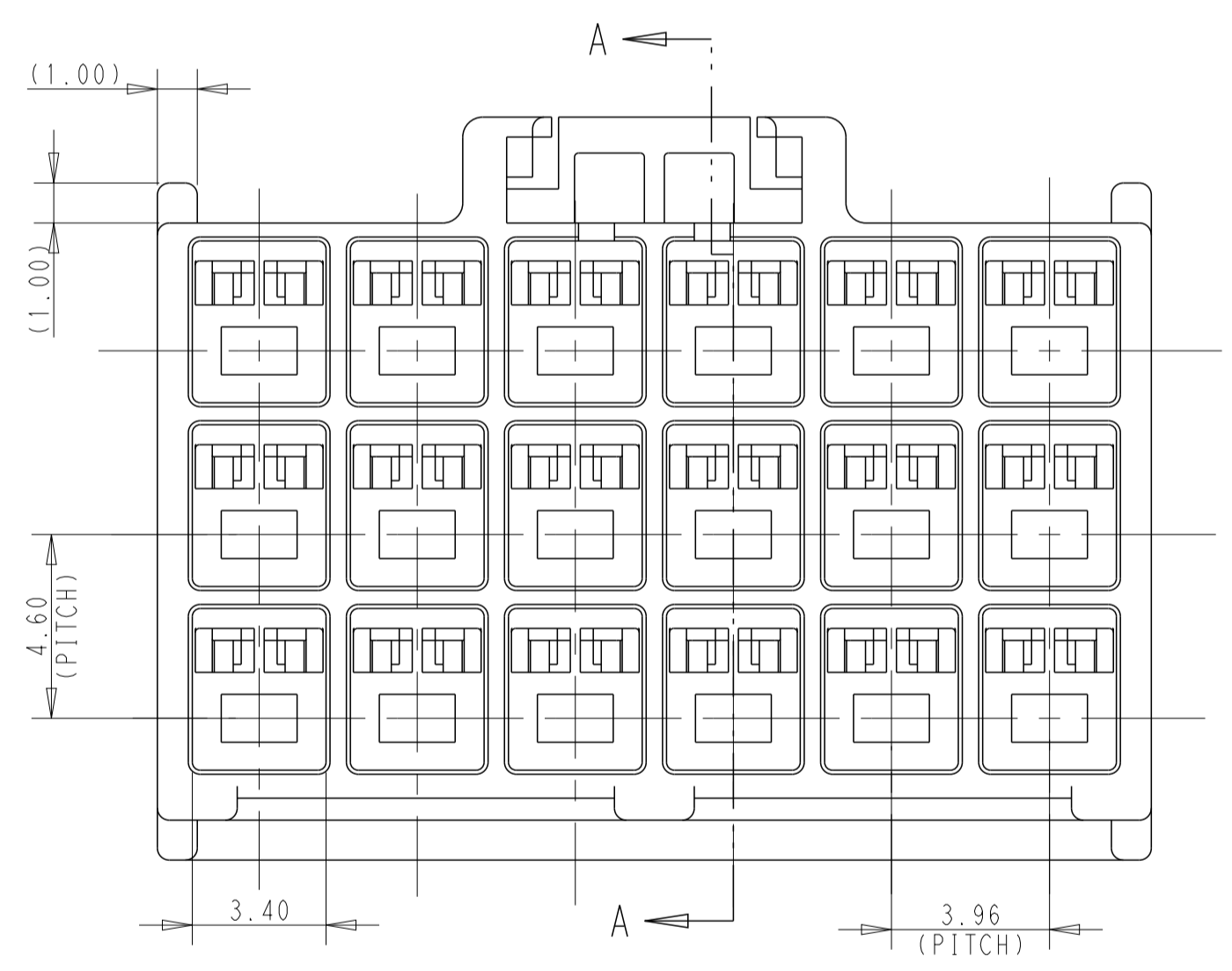

POS.	COLOR	PART NUMBER
18	BLACK	176291-9
DEVELOPMENT	18	BLUE
DISCONTINUED	18	YELLOW
DISCONTINUED	18	RED
18	NATURAL	176291-1

THIS DRAWING IS A CONTROLLED DOCUMENT.

DIMENSIONS:	TOLERANCES UNLESS OTHERWISE SPECIFIED:	DWN M. SHINDO 23NOV89	CHK M. YOSHIDA 28NOV89	APVD N. ONOUE 28NOV89
mm	0 PLC ±0.25 1 PLC ±0.2 2 PLC ±0.2 3 PLC ±0.2 4 PLC ±0.2 ANGLES ±°	PRODUCT SPEC 108-5302	APPLICATION SPEC 114-5142	WEIGHT
MATERIAL 6/6 NYLON (UL94 V-0)	FINISH	CAGE CODE 00779	DRAWING NO. 176291	CUSTOMER DRAWING

NAME: AMP UNIVERSAL POWER CONN 3.96 PITCH CAP HOUSING 18 POS (TPL ROW)

RESTRICTED TO: A

SCALE: 6:1 SHEET 1 OF 1 REV B