

REVISIONS					
P	LTR	DESCRIPTION	DATE	DWN	APVD
	C	REVISED PER ECR-20-100642	19SEP2022	M.G	D.Z

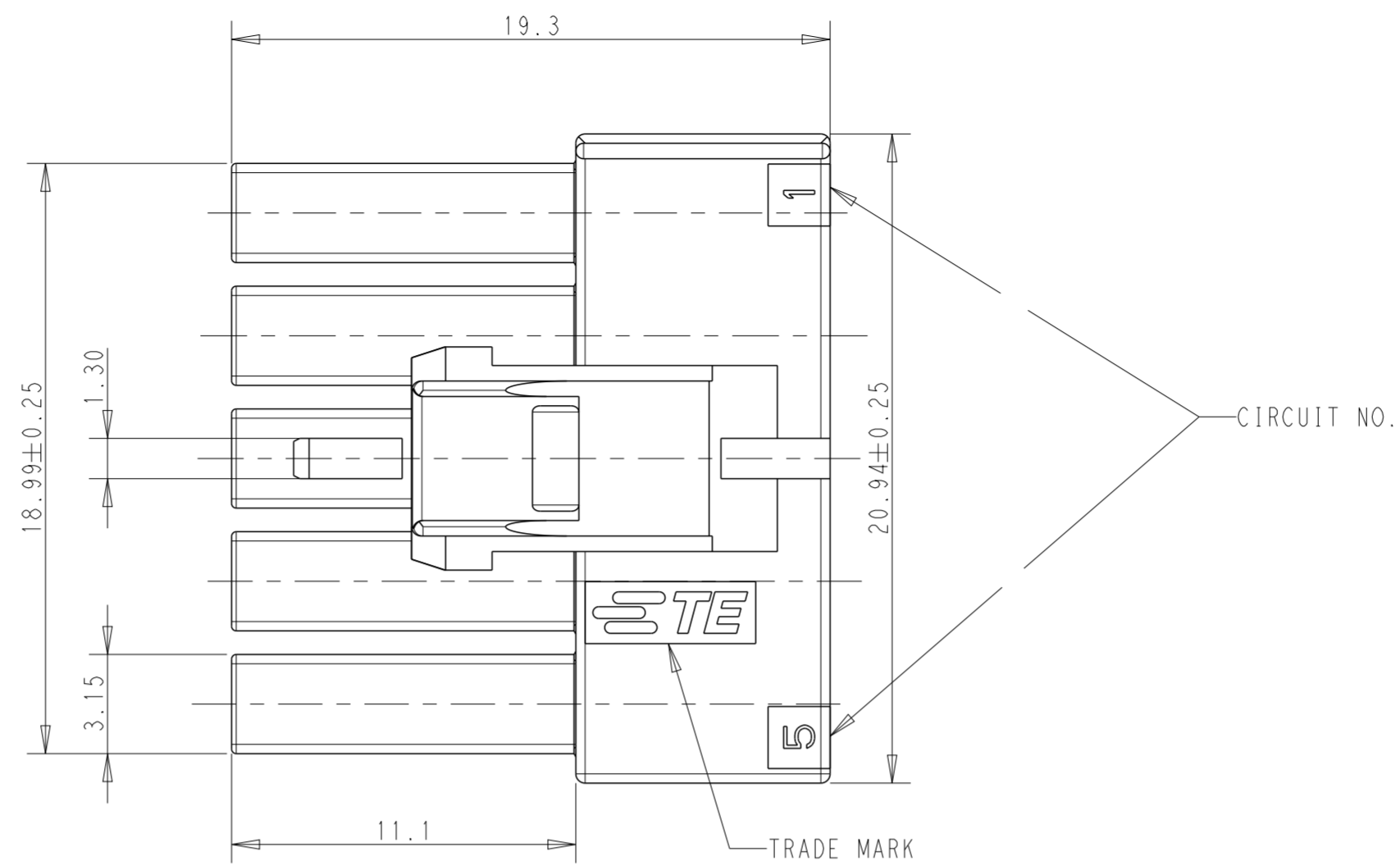

- 1 APPLICABLE CONTACT P/N:  
 REC CONTACT: 175152- (20-16 AWG)  
 175151- (26-22 AWG)
- 2 MATING CONN. P/N:  
 CAP HSG: 176290- (FREE HANGING)  
 176300- (PANEL MOUNT)  
 TAB CONTACT: 175150- (20-16 AWG)  
 175149- (26-22 SWG)
- 3 INSTRUCTION SHEET: IS-503J.

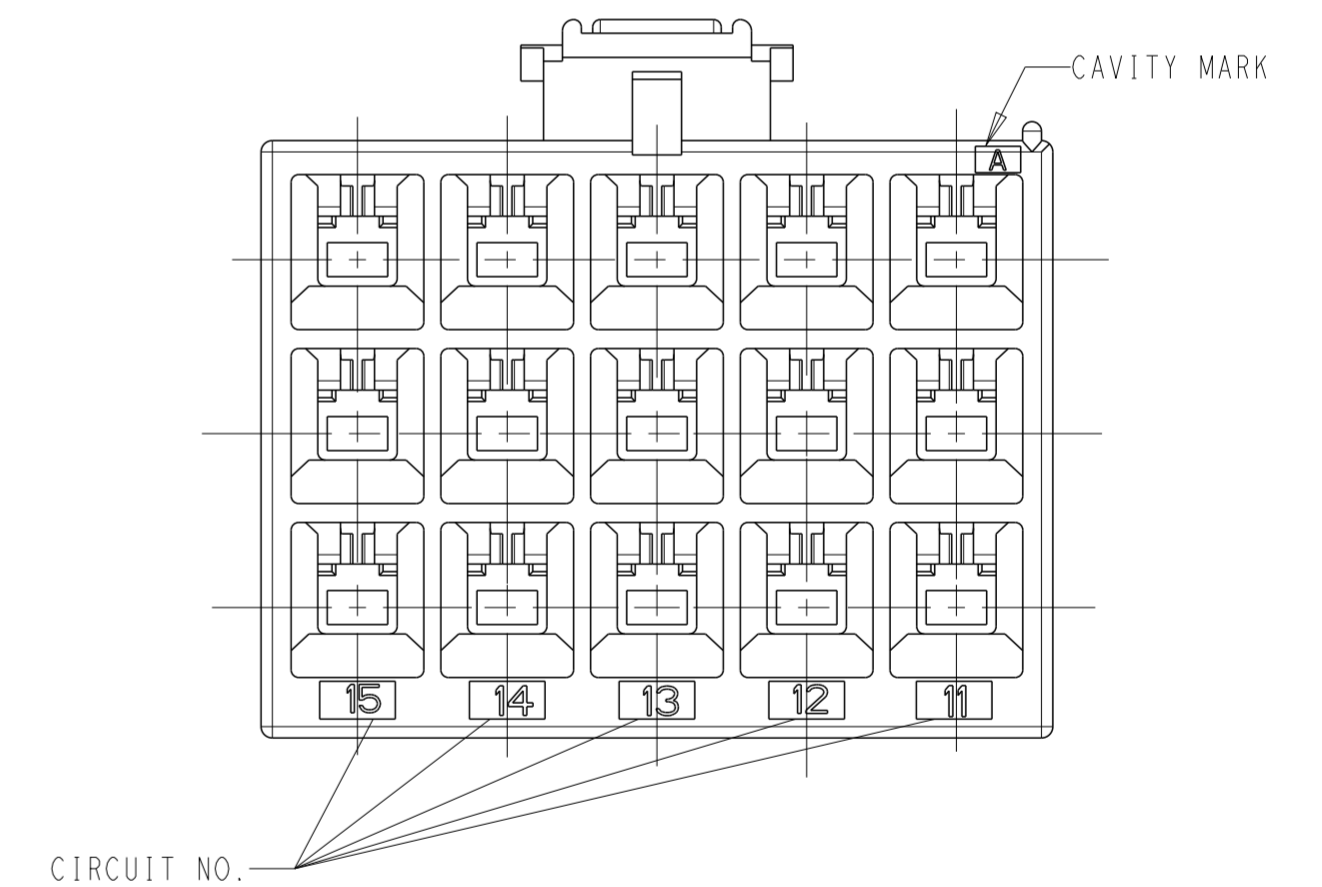
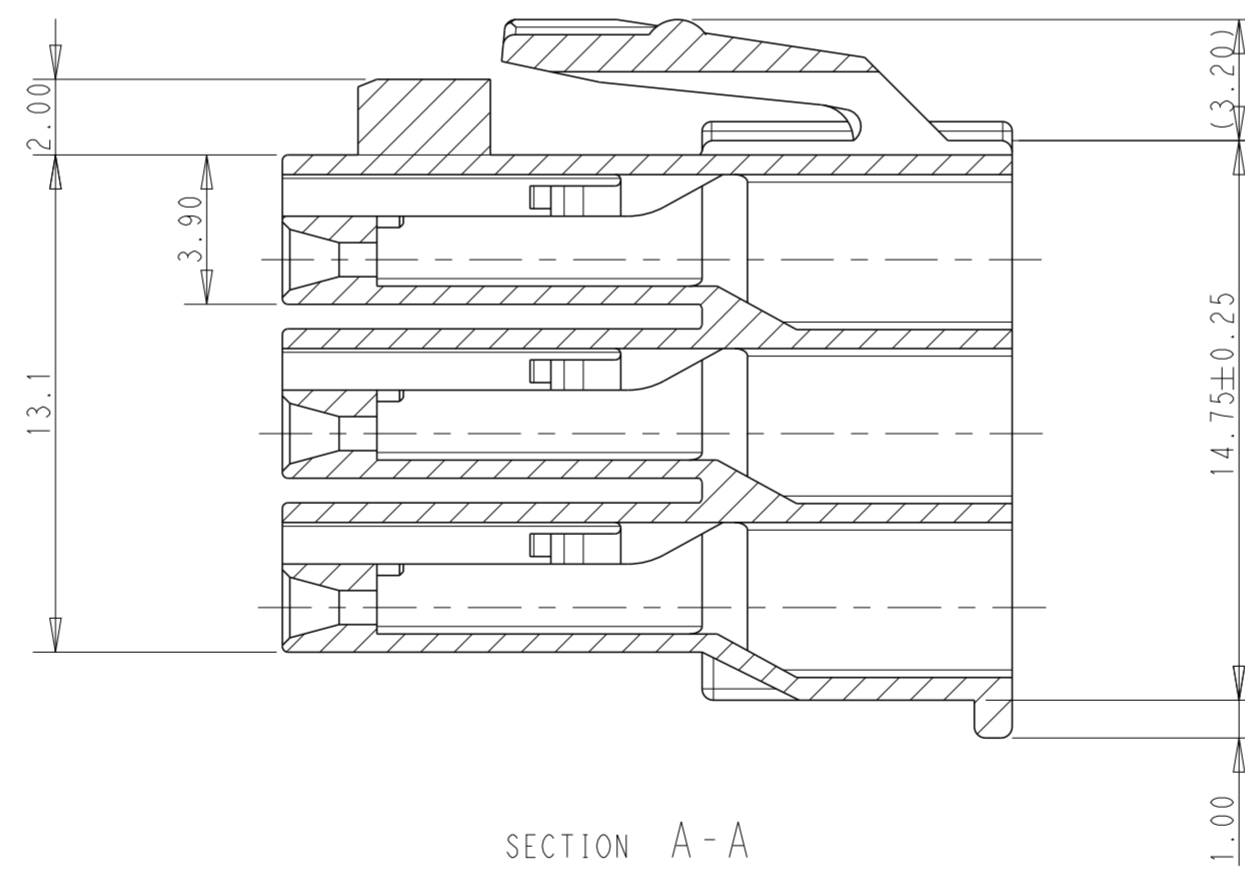
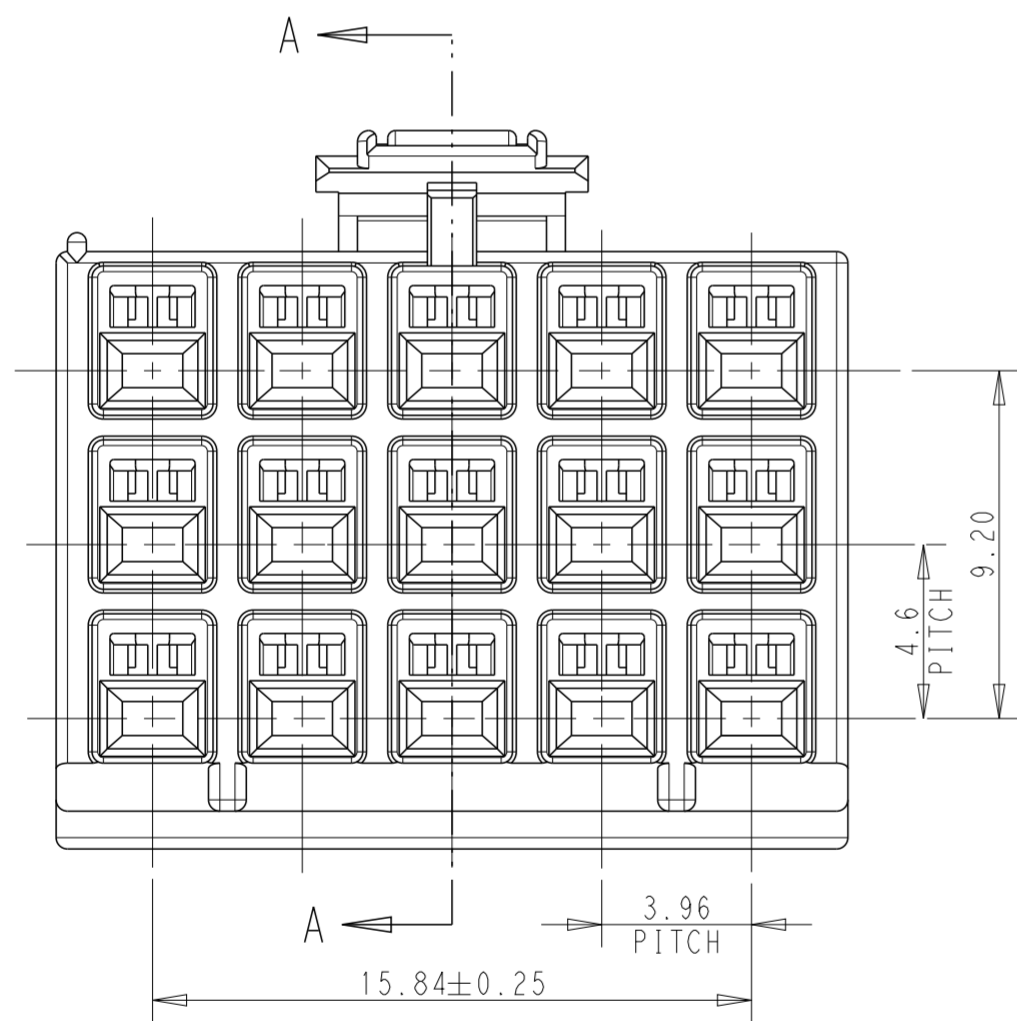

DEVELOPMENT	HOUSING COLOR	POSITION	PART NUMBER
	BLACK	15	176279-9
	BLUE	15	176279-6
DISCONTINUED	YELLOW	15	176279-4
DISCONTINUED	RED	15	176279-2
	NATURAL	15	176279-1

THIS DRAWING IS A CONTROLLED DOCUMENT.		DWN M. SHINDO 24NOV1989	<b>STE</b> TE Connectivity	
DIMENSIONS: mm		CHK Y. FUJITA 28NOV1989		
TOLERANCES UNLESS OTHERWISE SPECIFIED:		APVD N. ONOUE 28NOV1989	NAME AMP UNIVERSAL POWER CONN 3.96MM PITCH 15 POS PLUG HSG (TPL ROW)	
0 PLC ± 1 PLC ±0.25 2 PLC ±0.20 3 PLC ± 4 PLC ± ANGLES ±3° FINISH -		PRODUCT SPEC 108-5302	SIZE CAGE CODE DRAWING NO RESTRICTED TO	
MATERIAL 6/6 NYLON (UL94V-0)		APPLICATION SPEC 114-5142	A2 00779 C-176279	
		WEIGHT -	RESTRICTED CUSTOMER SCALE 5:1 SHEET 1 OF 1 REV C	