

THIS DRAWING IS UNPUBLISHED. RELEASED FOR PUBLICATION  
 © COPYRIGHT - TE Connectivity Ltd. ALL RIGHTS RESERVED.

REVISIONS				
P	LTR	DESCRIPTION	DATE	APVD
	K	STANDARDIZATION OF PLATING & SPLICING	13AUG2024	GVP KJK

**NOTES:**

- ① FOR MINI-APPLICATOR-CRIMPING.
- ② UNDERCOATING:1,25µm Ni, SELECTIVE:0,8µm Au, ZONE 1: 0,5µm MIN. GOLD FLASH.
- ③ UNDERCOATING:1,25µm Ni, SELECTIVE:0,8µm Au, GOLD FLASH ON REMAINDER (GOLD FLASH IS NOT MANDATORY ON THE PILOT CARRIER STRIP).
- ④ UNDERCOATING:1,25µm Ni, SELECTIVE:0,4µm Au, NO GOLD FLASH.
- ⑤ UNDERCOATING:1,25µm Ni, SELECTIVE:2,0µm Au, GOLD FLASH ON REMAINDER (GOLD FLASH IS NOT MANDATORY ON THE PILOT CARRIER STRIP).
- ⑥ PRE-TINPLATED:2,0µm.
- ⑦ ZONE 1:BRIGHT TIN/LEAD PLATED.
- ⑧ MATERIAL: PHOSPHOR BRONZE
- ⑨ FOR STANDARD-APPLICATOR-CRIMPING.
- ⑩ FOR REELFED-HANDTOOL-CRIMPING
- ⑪ 24-20 AWG (0,20-0,56 mm<sup>2</sup>) WITH .055 CRIMPER.  
26 AWG (0,12-0,14 mm<sup>2</sup>) WITH .042 CRIMPER.
- ⑫ OBSOLETE PARTS: OBSOLETE CIS STREAMLINING PER D.RENAUD/D.SINISI
- 13 SPLICING - MAXIMUM 1 LOOSE END PER REEL IS ALLOWED

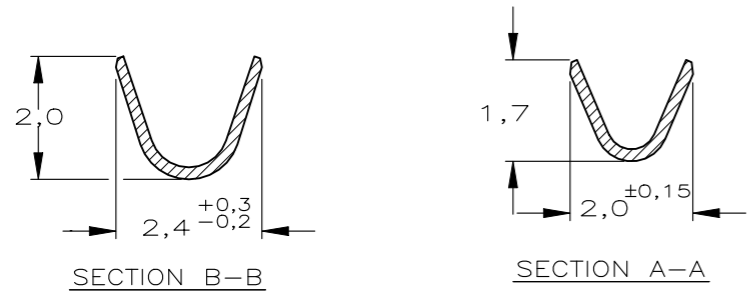
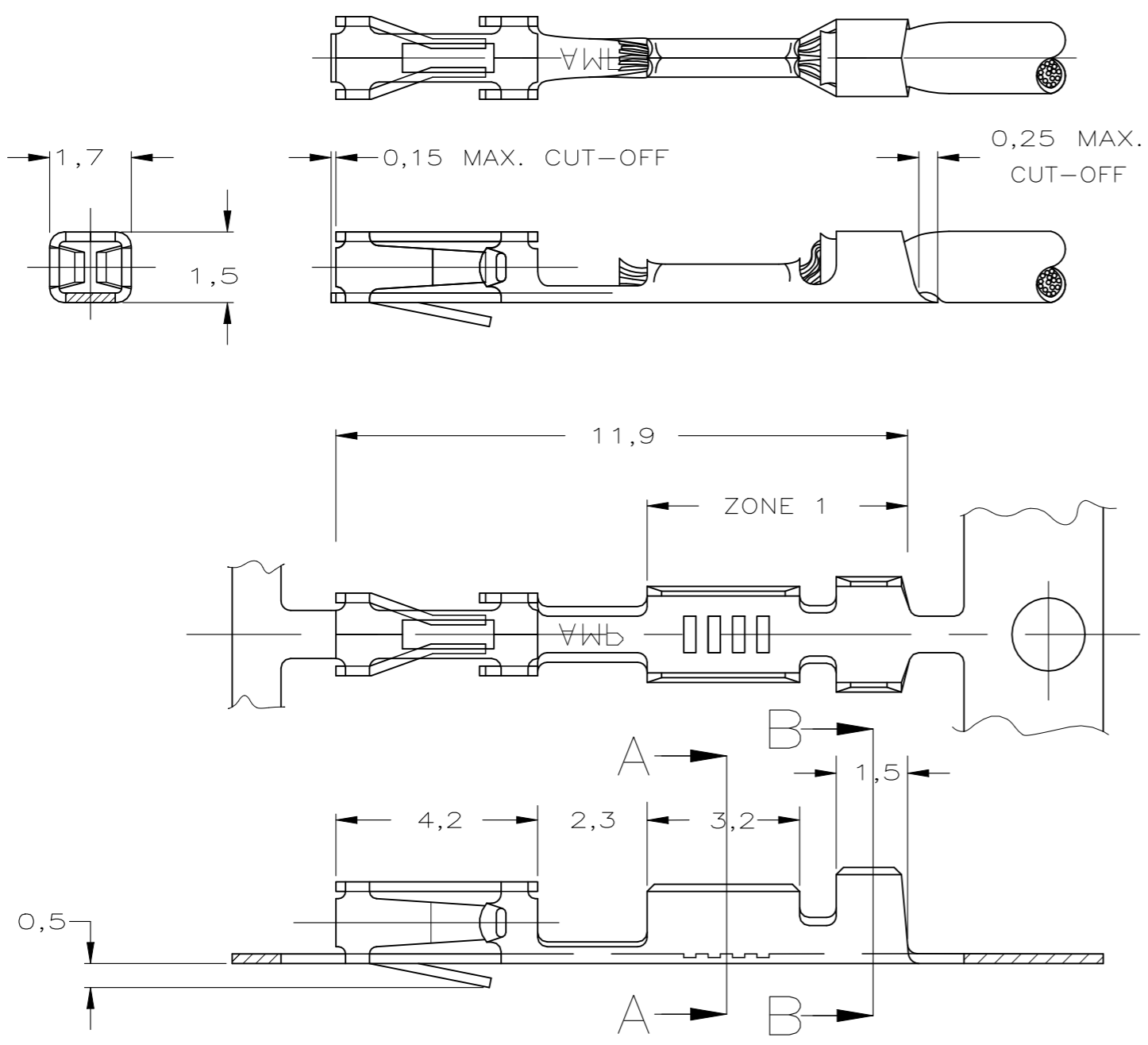

WIRE RANGE ①①
INSUL. RANGE 1,4 MAX.DIA.

GOLD	②	1-141708-2	5-167301-4	⑫	⑩
TIN	⑥	1-141708-1	5-167301-2	⑫	⑩
GOLD	⑤	≠	2-167301-6	⑫	①
			2-167301-5		⑨
GOLD	②	1-141708-2	2-167301-4		①
			2-167301-3	⑫	⑨
TIN	⑥	1-141708-1	2-167301-2		①
			2-167301-1		⑨
GOLD	④ ⑦	≠	1-167301-6		①
			1-167301-5		⑨
GOLD	③	141708-1	167301-4		①
			167301-3		⑨
SURFACE		LOOSE PIECE	PART NUMBER		

THIS DRAWING IS A CONTROLLED DOCUMENT.		DWN R.VISSER 11-11-87	<b>STE</b> TE Connectivity				
DIMENSIONS: mm		CHK J.v.LIEMPT					
TOLERANCES UNLESS OTHERWISE SPECIFIED: ±0.2mm		APVD L.v.SOEST	NAME				
0 PLC ± - 1 PLC ± - 2 PLC ± - 3 PLC ± - 4 PLC ± - ANGLES ± -		PRODUCT SPEC 108-25021	AMPMODU MOD IV RECEPTACLE,S.C.P.				
MATERIAL ⑧		APPLICATION SPEC 114-25003	SIZE A3	CAGE CODE 00779	DRAWING NO C-167301	RESTRICTED TO -	
SEE TABLE		WEIGHT -	CUSTOMER DRAWING		SCALE -	SHEET 1 OF 1	REV K