

4

3

2

1

THIS DRAWING IS UNPUBLISHED.

RELEASED FOR PUBLICATION

LOC

DIST

REVISIONS

© COPYRIGHT - BY TYCO ELECTRONICS CORPORATION. ALL RIGHTS RESERVED.

U

-

P

LTR

DESCRIPTION

DATE

DWN

APVD

A

ECR-10-026094 - P/N 1-1659321-1 ADDED

21 DEC 10

WR

-

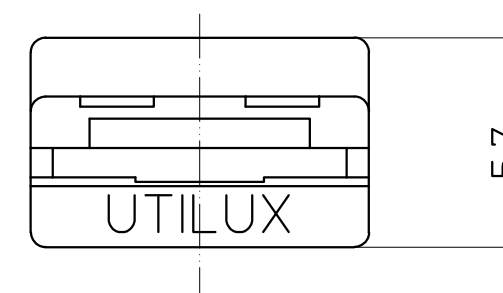
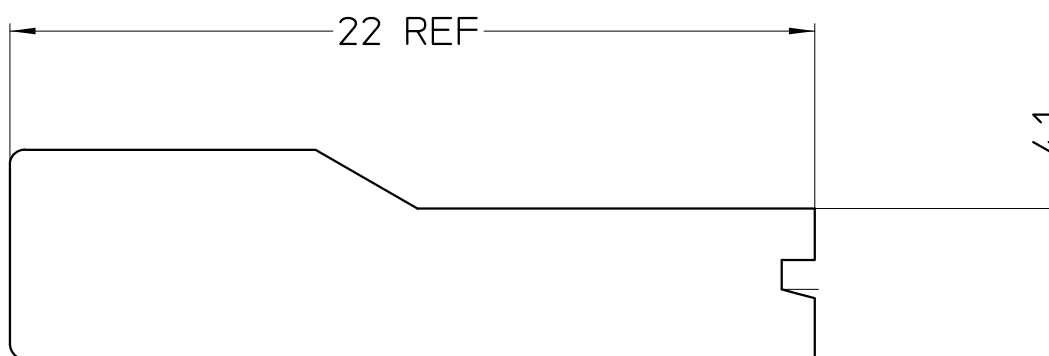
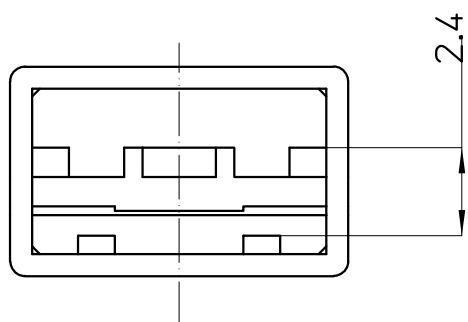

THIS INFORMATION IS CONFIDENTIAL AND PROPRIETARY TO TYCO ELECTRONICS CORPORATION AND ITS WORLDWIDE SUBSIDIARIES AND AFFILIATES. IT MAY NOT BE DISCLOSED TO ANYONE OTHER THAN TYCO ELECTRONICS PERSONNEL WITHOUT WRITTEN PERMISSION FROM TYCO ELECTRONICS CORPORATION, HARRISBURG, PENNSYLVANIA, USA.

NOTES:

- 1. INSULATOR DESIGNED TO BE USED WITH LOW INSERTION FORCE RECEPTACLE SERIES; PART Nos: 1659251, 1659252, 1659253, 1659254, 279509 & 279256.



NYLON 66	BLACK	INSULATOR, POST FIT BLACK (H30013)	1-1659321-1
NYLON 66	NATURAL	INSULATOR, POST FIT NATURAL (H30013)	1-1659321-0
MATERIAL DESC.	COLOUR	DESCRIPTION (UTX P/N)	PART No.

THIS DRAWING IS A CONTROLLED DOCUMENT.		DWN: W.RIEDE 30.3.03	Tyco Electronics Corporation AUSTRALIA	
ALL DIMENSIONS IN mm:		CHK: H.THAI 30.3.03		
	TOLERANCES UNLESS OTHERWISE SPECIFIED:	APVD: W.RIEDE 30.3.03	NAME: INSULATOR, POST FIT	
	DIMENSION (mm) TOLERANCE(+mm)	PRODUCT SPEC:		
	LESS THAN 10 0.4 OVER 10 TO 30 0.5 OVER 30 TO 80 0.7 OVER 80 TO 250 1.0 ANGLES ±2°	APPLICATION SPEC:		
MATERIAL REF BLOCK	FINISH -	WEIGHT: -	SIZE A3	RESTRICTED TO -
CUSTOMER DRAWING			DRAWING NO. C-1659321	SCALE 5:1
			SHEET 1 OF 1	REV A