

THIS DRAWING IS UNPUBLISHED. RELEASED FOR PUBLICATION
 © COPYRIGHT BY TYCO ELECTRONICS CORPORATION. ALL RIGHTS RESERVED.

LOC	DIST	REVISIONS			
P	LTR	DESCRIPTION	DATE	DWN	APVD
DF	DO				
	D	UPDATE PER 0H2Y-0164-04	12 MAY 04	CAS	MKS

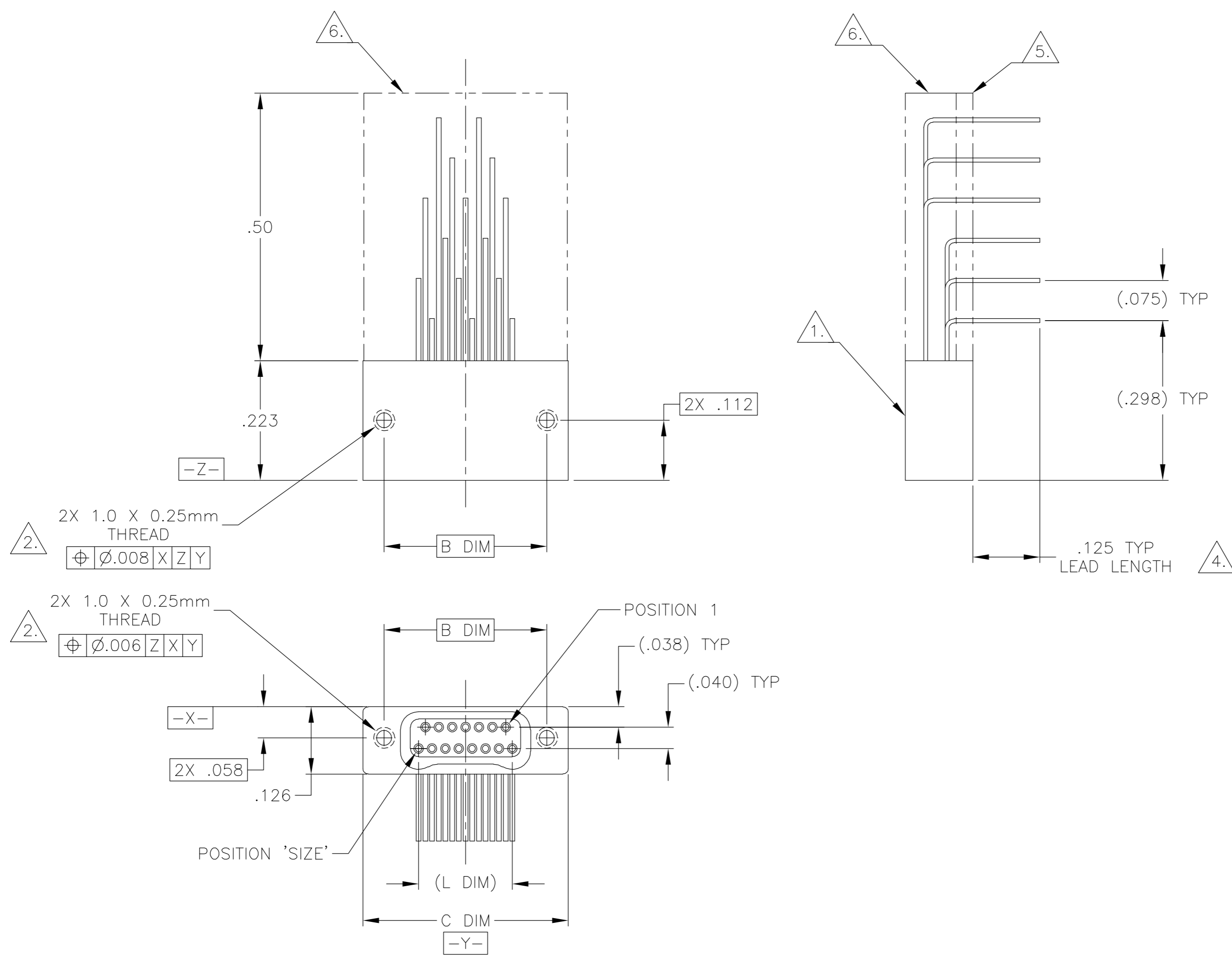

SIZE	B DIM	C DIM ±.0050	(L DIM)
09	.229	.3085	(.100)
15	.304	.3835	(.175)
25	.429	.5085	(.300)
37	.579	.6585	(.450)
51	.754	.8335	(.625)
65	.929	1.0085	(.800)

- 1. SHELL OPTIONS (TO BE SPECIFIED IN NANONICS PART NUMBER):
 METAL: 6061-T6 ALUMINUM, ELECTROLESS NICKEL PLATED PER MIL-C-26074 (STANDARD) OR GOLD PLATED PER MIL-G-45204
 303 STAINLESS STEEL, PASSIVATED PER SAE-AMS-QQ-P-35
 INSULATOR MATERIAL FOR ALL METAL SHELLS IS LIQUID CRYSTAL POLYMER (LCP) PER MIL-M-24519 OR PER ASTM D5138
 PLASTIC: LIQUID CRYSTAL POLYMER (LCP) PER MIL-M-24519 OR PER ASTM D5138
- 2. STANDARD 1.0 X 0.25mm MOUNTING AND JACKSCREW THREADS ARE SHOWN FOR REFERENCE ONLY AND MUST BE SPECIFIED IN THE NANONICS PART NUMBER WHEN REQUIRED. 1.2 X 0.25mm THREADS ALSO AVAILABLE.
- 3. MOUNTING HARDWARE IS AVAILABLE WITH THIS CONFIGURATION (NOT SHOWN). HARDWARE MUST BE SPECIFIED IN THE NANONICS PART NUMBER. CONSULT TYCO ELECTRONICS FOR DETAILS.
- 4. LEADS ARE HH BRASS, TIN LEAD PLATED 60/40 COMPOSITION PER SAE-AMS-P-81728.
- 5. INSULATOR BOARD MATERIAL: G10 OR EQUIVALENT.
- 6. EPOXY ENCAPSULATION.
- 7. TERMINATION CODE: M8
- 8. THIS DRAWING PREVIOUSLY IDENTIFIED AS NANONICS N10138/284

THIS DRAWING IS A CONTROLLED DOCUMENT.		DWN D. RYAN 30 MAY 00	Tyco Electronics Corporation Harrisburg, PA 17105	
DIMENSIONS: INCHES		CHK M. STORRY 30 MAY 00	NAME	
TOLERANCES UNLESS OTHERWISE SPECIFIED:		APVD -	PRODUCT SPEC	
0 PLC ± - 1 PLC ± - 2 PLC ± .010 3 PLC ± .005 4 PLC ± - ANGLES ± 1		APPLICATION SPEC		
MATERIAL SEE NOTES		WEIGHT -	RESTRICTED TO	
FINISH SEE NOTES		SIZE CAGE CODE DRAWING NO A2 00779 C=1589491		
CUSTOMER DRAWING		SCALE 6:1	SHEET 1 OF 2	REV D

THIS DRAWING IS UNPUBLISHED. RELEASED FOR PUBLICATION
 © COPYRIGHT BY TYCO ELECTRONICS CORPORATION. ALL RIGHTS RESERVED.

LOC		DIST		REVISIONS			
P	LTR	DESCRIPTION		DATE	DWN	APVD	
DF	DO	D		UPDATE PER 0H2Y-0164-04	12 MAY 04	CAS MKS	

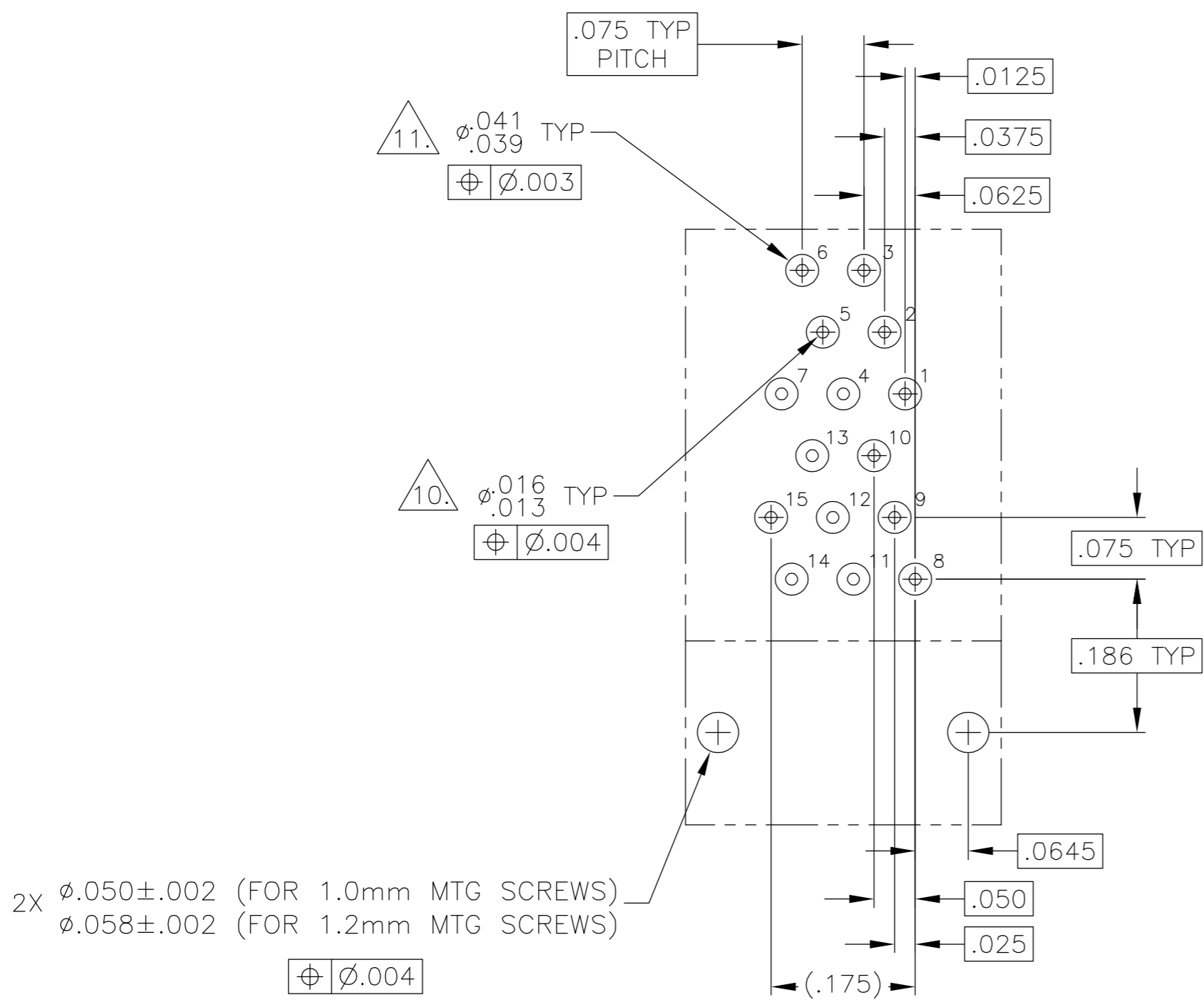
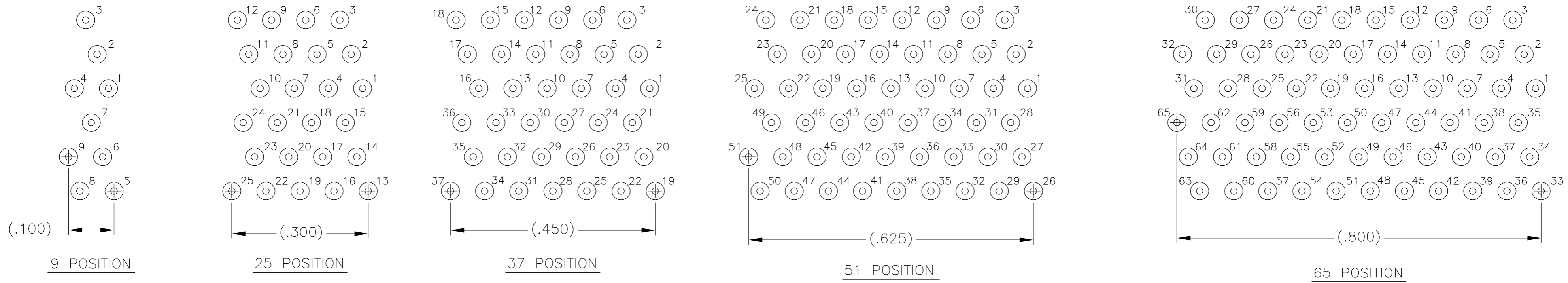

TYPICAL PCB LAYOUT Δ 9.
 SIZE 15 SHOWN FOR REFERENCE

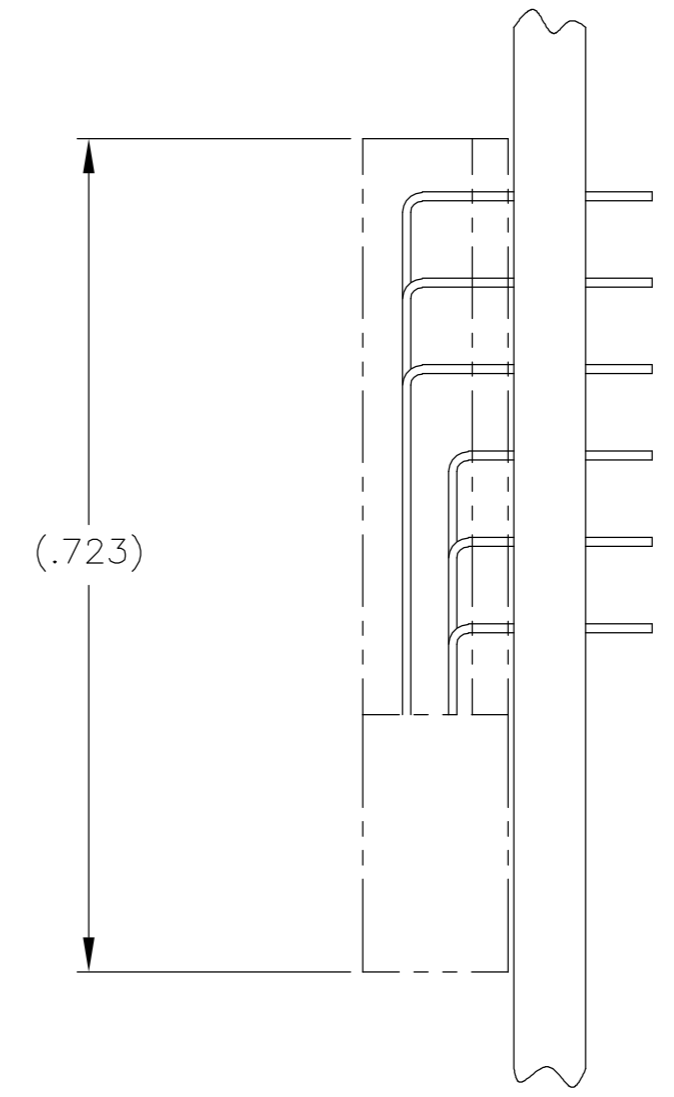

- Δ 9. POSITIONAL TOLERANCES FOR BASIC DIMENSIONED FEATURES ARE RELATIVE TO FIDUCIALS OR SOME SIMILAR DATUM REFERENCES DEFINED BY PCB DESIGNER.
- Δ 10. PLATED THRU HOLES.
- Δ 11. SOLDER PADS.
- 12. ALL THROUGH HOLE LAYOUTS ARE AS VIEWED FROM TOP OF PCB.

THIS DRAWING IS A CONTROLLED DOCUMENT.		DWN D. RYAN 30 MAY 00	Tyco Electronics Corporation Harrisburg, PA 17105	
DIMENSIONS: INCHES		CHK M. STORRY 30 MAY 00		
TOLERANCES UNLESS OTHERWISE SPECIFIED:		APVD -	NAME	
		PRODUCT SPEC -	RECP ASSEMBLY, HORIZONTAL MOUNT, THROUGH HOLE, 2 TO 6 ROW, .075 SPACING, PLASTIC OR METAL	
MATERIAL		APPLICATION SPEC -	SIZE A2	RESTRICTED TO -
FINISH		WEIGHT -	CAGE CODE 00779	DRAWING NO C=1589491
		CUSTOMER DRAWING	SCALE 6:1	SHEET 2 OF 2
			REV D	