

# STANDARD CRIMP

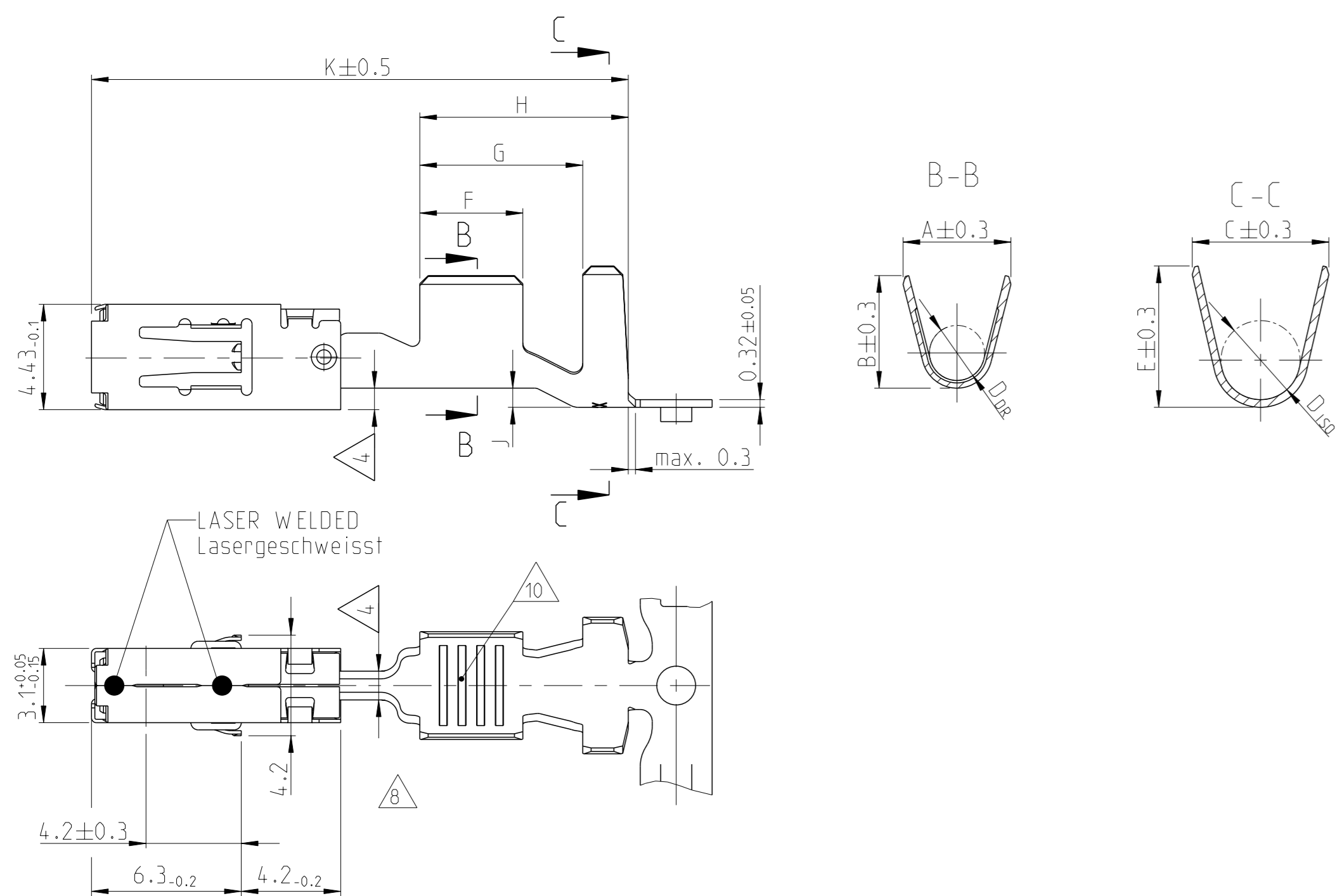

# SERRATION DESIGN Serration Ausfuehrung

DESIGN / Ausfuehrung  
0,5 - 1,0mm<sup>2</sup>

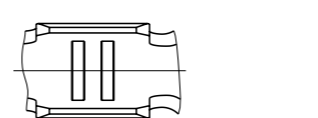

DESIGN / Ausfuehrung  
0,2 - 0,5mm<sup>2</sup>

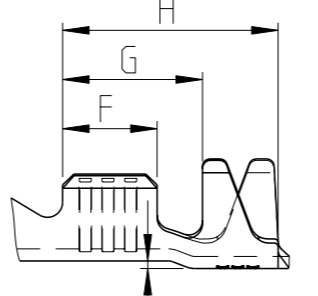

ONLY FOR WIRE SIZE RANGE  
Nur fuer DGB  
0.2 ... 0.5 mm<sup>2</sup>

DESIGN / Ausfuehrung  
1,5 - 2,5mm<sup>2</sup>  
12 AWG

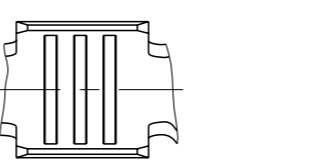

DESIGN / Ausfuehrung  
4,0mm<sup>2</sup>

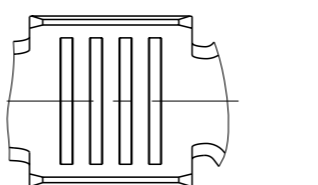

# SINGLE WIRE SEAL Einzeldichtungssystem

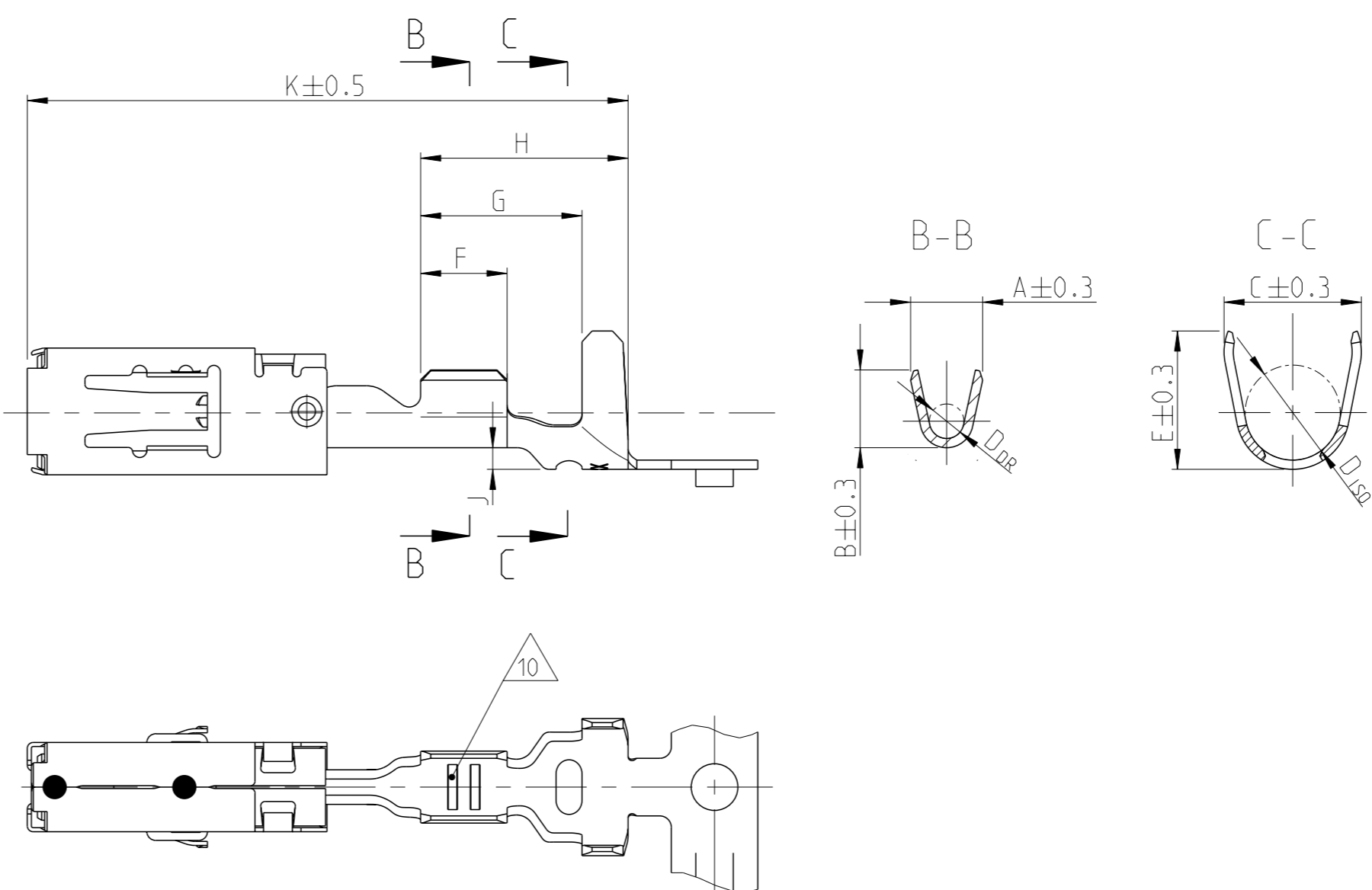

### REVISIONS

#	CTH	DESCRIPTION	DATE	OWN	APVD
J12		PNs 1-968855-4, 1-968857-4, 1-968859-4 OBSOLETE ON DRW.	05MAR2018	MAH.	BECK
J13		Added PN 2-968851-3, 2-968853-3 2-968857-3 and 2-968859-3	07MAY2018	FRAN	BECK
J14		Obsolete PN 1-968882-1/-2/-3; PN 1-968880-1/-3	11NOV2020	FRAN	BECK
J15		PCN-22-152506	14SEP2022	FRAN	GRIE

NOTES:  
Bemerkungen:

1 MATING PART SEE INTERFACE DRAWING  
TE-NO.: 114-18230-002  
Gegenstecker nach Ausfuehrungsvorschrift  
TE-Nr.: 114-18230-002

2 SURFACE:  
- PRE TIN PLATED 1 TO 3 µm  
- GOLD PLATED MIN. 2 µm (ONLY CONTACT AREA)  
- SILVER PLATED 3 TO 5 µm (ONLY CONTACT AREA)  
Oberflaeche:  
- verzinkt 1 bis 3 µm  
- vergoldet min. 2 µm (nur Kontaktzone)  
- versilbert 3 bis 5 µm (nur Kontaktzone)

3 DOUBLE CRIMPS ARE ONLY POSSIBLE WITH  
APPLICATORS AUTHORIZED BY TE (NO HAND TOOL)  
SUITABLE TOOLS ON REQUEST  
Doppelanschlaege sind nur mit von TE zugelassenen  
Anschlagwerkzeugen moeglich (keine Handzangen)  
passende Werkzeuge auf Anfrage

4 GAUGE INSPECTION  
Lehrenpruefung

5 DETAILS OF DESIGN ARE LEFT TO MANUFACTURER  
Einzelheiten der Ausfuehrung bleiben dem Hersteller ueberlassen

6 ONLY GERMAN LANGUAGE VERSION SHALL BE BINDING  
Massgebend ist der deutsche Text

7 PUNCHING OIL RAZIOL CLF 11 SG  
Stanzoeel:

8 "Ag+" MARKING ON SILVER PLATED VERSIONS FOR INCREASED LIMIT TEMPERATURE  
"Ag+" Markierung auf versilberten Versionen fuer erhoehte Grenztemperatur

9 968880 nicht fuer Neuanwendungen, wird ersetzt durch 2141857  
968882 nicht fuer Neuanwendungen, wird ersetzt durch 2141859  
968880 SUPERSEDED BY PN 2141857  
968882 SUPERSEDED BY PN 2141859

10 Unterschiedliche Ausfuehrung und Anzahl der SERRATIONS  
DIFFERENT FORM AND NUMBER OF THE SERRATIONS POSSIBLE

VERSION Ausfuehrung	ORDER-NO. STRIP-FORM Bestell-Nr. Bandware	REV	MATERIAL Werkstoff	BODY SPRING	SURFACE Oberflaeche	WIRE SIZE RANGE Leiter- quer- schnitt mm <sup>2</sup>	INSULATION DIAMETER Isolations- durchmesser mm	CRIMP DIMENSIONS / Crimpabmessungen mm											WEIGHT Gewicht g	SINGLE WIRE SEAL Einzeldichtung	TE CONNECTIVITY NO. DEAD END PLUG Blindstopfen	TE CONNECTIVITY NO.	APPLICATION TOOLS Verarbeitungswerkzeuge		
								A	B	D <sub>DR</sub>	C	E	D <sub>ISO</sub>	F	G	H	J	K							
1-1719506-3	A				SILVER PLATED versilbert	12 AWG	3.0	4.0	4.2	2.0	5.0	5.0	3.5	3.5	5.9	7.5	0.8	21.0	0.59	828905-1	828922-1				
1-1719506-1	A				PRE TIN PLATED verzinkt		3.8																		
2-968859-3	D				SILVER PLATED versilbert	4	3.4	4.5	4.7	2.3	6.0	6.0	4.3	4.3	7.0	8.5	1.25	22.6	0.65	828985-1	828986-1				
1-968859-3	F	J15			SILVER PLATED versilbert		-																		
1-968859-1	E				PRE TIN PLATED verzinkt		3.7																		
2-968857-3	B				SILVER PLATED versilbert	1.5	2.2	3.6	3.8	1.7	5.0	5.0	3.5	3.5	6.0	7.6	0.8	21.0	0.58	828905-1	828922-1				
1-968857-3	F	J15			SILVER PLATED versilbert		-																		
1-968857-2	D				GOLD PLATED vergoldet	2.5	3.0	2.5	2.7	1.2	4.8	4.8	3.3	3.0	5.6	7.2	0.75	21.0	0.54	828904-1	828922-1				
1-968857-1	E				PRE TIN PLATED verzinkt		2.1																		
1-968855-3	F	J15			SILVER PLATED versilbert	0.5	1.4	2.5	2.7	1.2	4.8	4.8	3.3	3.0	5.6	7.2	0.75	21.0	0.54	828904-1	828922-1				
1-968855-2	E				GOLD PLATED vergoldet		2.1																		
1-968855-1	E				PRE TIN PLATED verzinkt	1.0	2.1																		
1-2141859-3	B	J15			SILVER PLATED versilbert	0.2	1.2	2.4	2.3	1.0	4.5	4.5	3.2	2.5	5.1	6.7	0.75	21.0	0.52	828904-1	828922-1				
1-2141859-2	A				GOLD PLATED vergoldet		-																		
1-2141859-1	A				PRE TIN PLATED verzinkt	0.5	1.4																		
1-968882-3	E				SILVER PLATED versilbert	0.2	1.2	2.1	2.1	0.8	4.5	4.5	3.2	2.5	5.1	6.7	0.75	21.0	0.52	828904-1	828922-1				
1-968882-2	E				GOLD PLATED vergoldet		-																		
1-968882-1	E				PRE TIN PLATED verzinkt	0.5	1.4																		
2-968853-3	D				SILVER PLATED versilbert	4	2.7	4.5	4.7	2.3	5.7	5.9	3.3	4.3	6.8	8.7	0.8	22.6	0.65	-	-				
1-968853-3	F	J15			SILVER PLATED versilbert		-																		
1-968853-1	E				PRE TIN PLATED verzinkt		3.7																		
2-968851-3	D				SILVER PLATED versilbert	1.5	2.2	3.6	3.8	1.7	4.6	5.0	2.6	3.5	5.1	6.7	0.3	20.2	0.56	-	-				
1-968851-3	F	J15			SILVER PLATED versilbert		-																		
1-968851-2	E				GOLD PLATED vergoldet	2.5	3.0	2.5	2.7	1.2	3.3	3.5	1.8	3.0	4.6	6.2	0.2	20.2	0.51	-	-				
1-968851-1	E				PRE TIN PLATED verzinkt		2.1																		
1-968849-3	F	J15			SILVER PLATED versilbert	0.5	1.4	2.5	2.7	1.2	3.3	3.5	1.8	3.0	4.6	6.2	0.2	20.2	0.51	-	-				
1-968849-2	E				GOLD PLATED vergoldet		-																		
1-968849-1	E				PRE TIN PLATED verzinkt	1.0	2.1																		
1-2141857-3	B	J15			SILVER PLATED versilbert	0.2	1.2	2.4	2.3	1.0	2.9	2.9	1.4	2.5	3.8	5.7	0.2	20.2	0.48	-	-				
1-2141857-1	A				PRE TIN PLATED verzinkt	0.5	1.4																		
1-968880-3	E				SILVER PLATED versilbert	0.2	1.2	2.1	2.1	0.8	2.9	2.9	1.4	2.5	3.8	5.7	0.2	20.2	0.48	-	-				
1-968880-1	E				PRE TIN PLATED verzinkt	0.5	1.4																		

SEE APPLICATION SPECIFICATION 114-18148  
siehe Verarbeitungsspezifikation 114-18148

THIS DRAWING IS A CONTROLLED DOCUMENT. DWG S. Blidar ZZSEP97  
CHK G. Hotea ZZSEP97  
APVD J. Woller ZZSEP97

TE Connectivity  
PRODUCT GROUP DRAWING FOR  
Tabellenzeichnung fuer  
AMP MCP 2.8

SIZE 114-18148  
WEIGHT  
CUSTOMER DRAWING

SCALE 5:1 SHEET 1 OF 1 REV 15