

THIS DRAWING IS UNPUBLISHED. RELEASED FOR PUBLICATION  
 © COPYRIGHT - By - ALL RIGHTS RESERVED.

LOC		DIST		REVISIONS					
AD		39		P	LTR	DESCRIPTION	DATE	DWN	APVD
				K		REVISED PER ECO-15-004633	30MAY2015	NK	JO

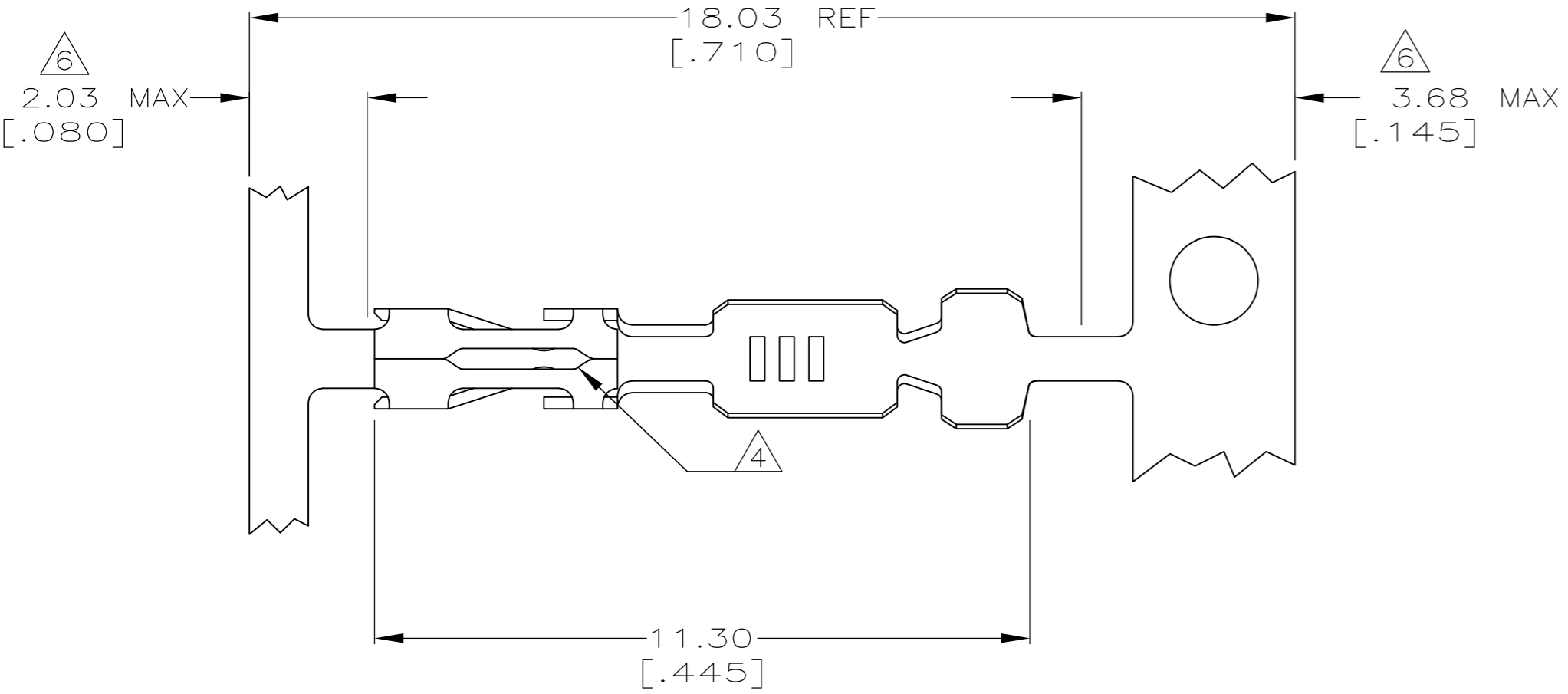

- 1 REELED FOR MINI APPLICATOR.
- 2 FINISH: GOLD FLASH OVER 0.00127[.000050] NICKEL, 0.000381[.000015] GOLD IN CONTACT AREA.
- 3 FINISH: GOLD FLASH OVER 0.00127[.000050] NICKEL, 0.00076[.000030] GOLD IN CONTACT AREA.
- 4 CUT OUTS ON BOX AT MANUFACTURERS OPTION.
- 5 POINT OF MEASUREMENT FOR PLATING THICKNESS(INSIDE BEAMS).
- 6 GOLD PLATING NOT REQUIRED IN THIS AREA.
- 7 WIRE RANGE #22-#26, INSULATION RANGE  $\phi$ .061 MAX.

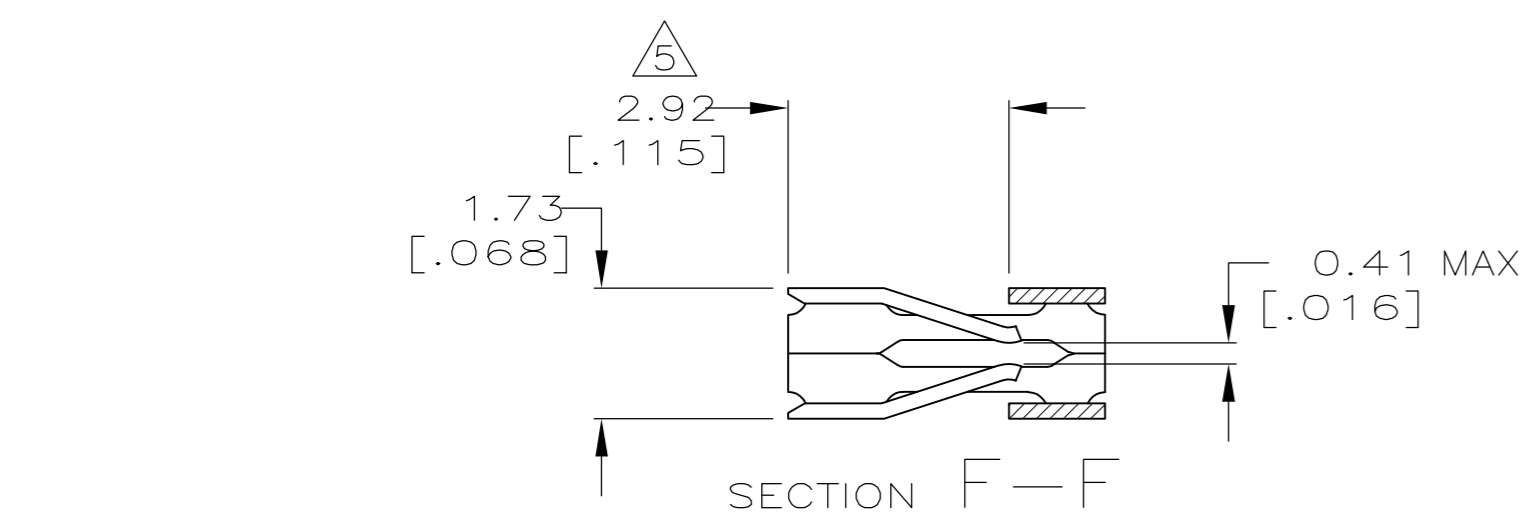
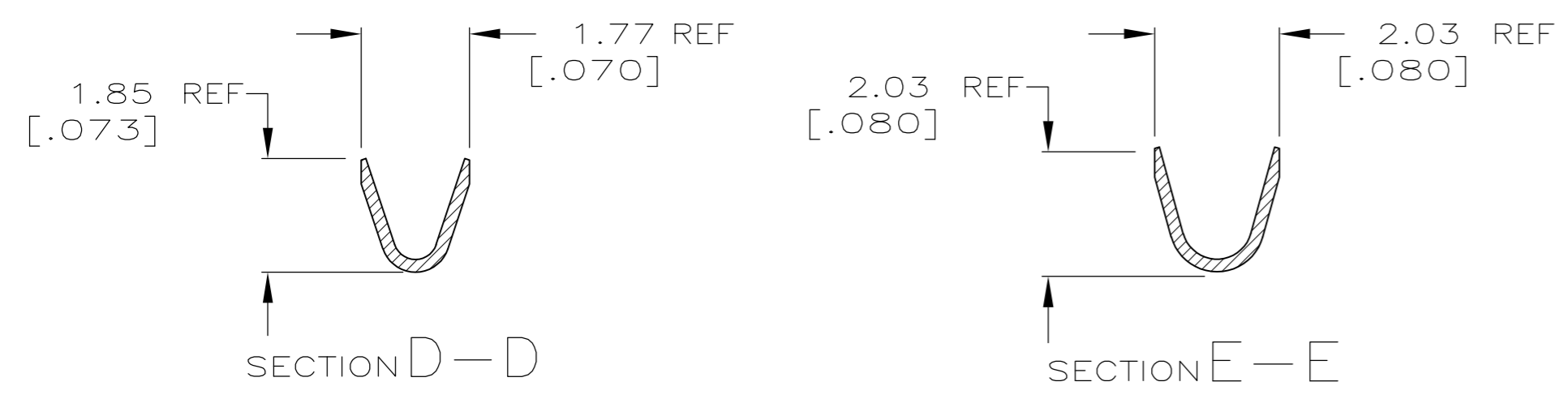
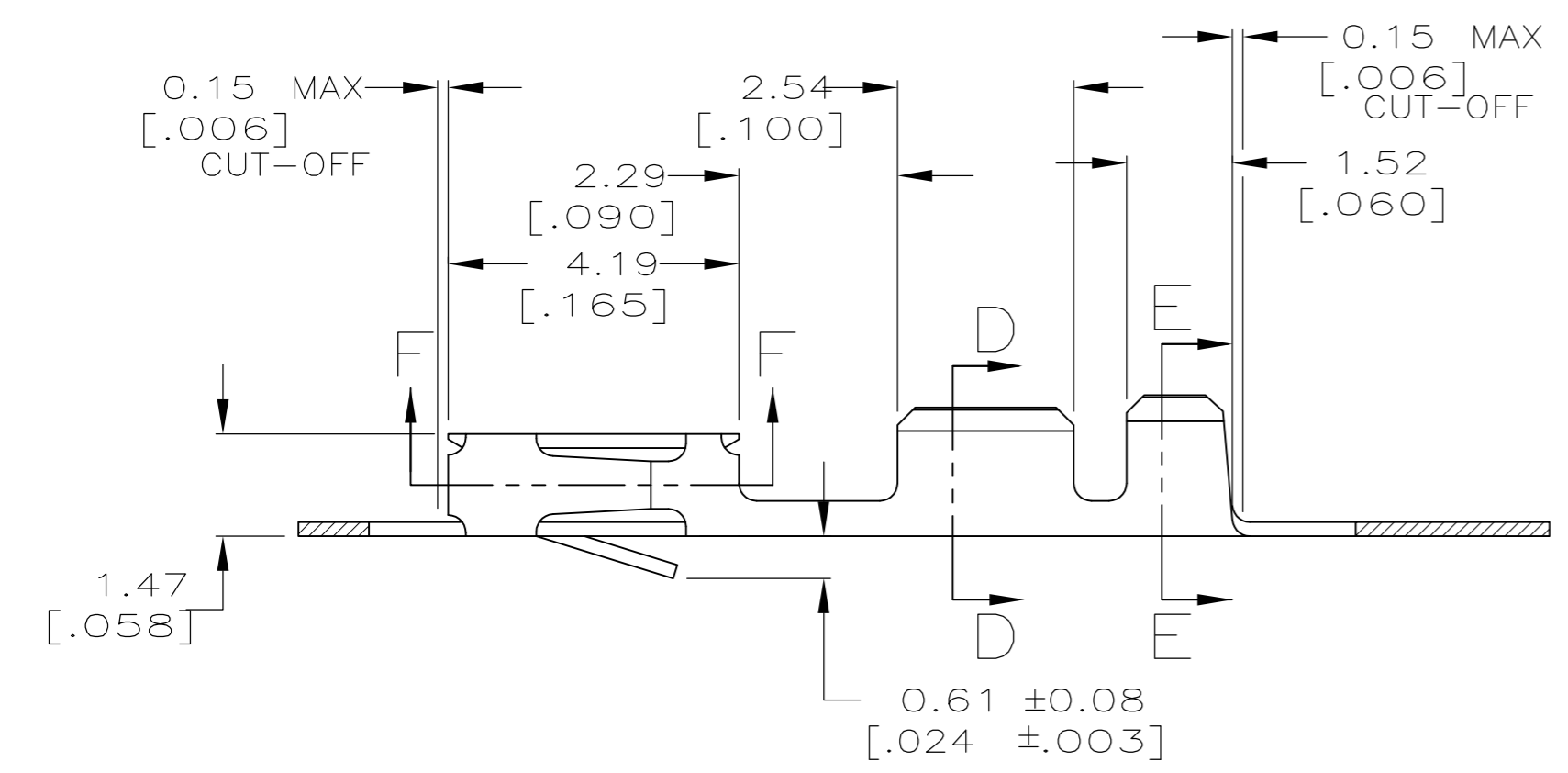

LOOSE PC.	3	102548-6
1	3	102548-5
LOOSE PC.	2	102548-3
1	2	102548-1
DESCRIPTION	FINISH	PART NUMBER

THIS DRAWING IS A CONTROLLED DOCUMENT.		DWN	S. SHUEY	5-6-92		TE Connectivity						
DIMENSIONS: mm [INCHES]		CHK	J.GESFORD	5-20-92		CONTACT, CRIMP SNAP-IN, MOD IV 1/2						
TOLERANCES UNLESS OTHERWISE SPECIFIED:		APVD	-	-		-						
0 PLC ± -		PRODUCT SPEC	-	-		-						
1 PLC ± -		APPLICATION SPEC	-	-	-							
2 PLC ± 0.13[.005]		WEIGHT	-	-	SIZE	A2	CAGE CODE	00779	DRAWING NO	C=102548	RESTRICTED TO	-
3 PLC ± -		CUSTOMER DRAWING	SCALE		10:1	SHEET	1 of 1	REV	K			
4 PLC ± -												
ANGLES ± -												
FINISH		SEE TABLE										
MATERIAL		CU-NI-SI										