

LIGHT-N-LOK STANDARD CONNECTORS

Compact Connector with Reliable Poke-in Wiring Technology

TE Connectivity (TE)'s 2 position wire-to-wire connector provides a space-saving solution for indoor downlighting, connecting power to luminaire. Designed with limited space in mind, the low profile, UL/CSA 2459 compliant connector eliminates the hazard of electric shock and accepts 18 AWG - 22 AWG solid or tin-dipped stranded wires. It is designed for easy, tool-free installation and eliminates mis-mating through its bump feature.

The poke-in technology allows for easy repair and is supported by dual contact surfaces and a metal stopper for reliability. Contacts are fully fixed in the housing and feature an additional lock bar for added dependability.

Applications

- Indoor lighting, especially downlights
- Commercial lighting

Specifications & Product Performance

Rate current (max):	18 AWG:	3A Max 3A certified by UL2459
	22 AWG:	4A Max
Rate voltage (max):	600 VAC Max	
Dielectric strength:	2200 VAC	
Operating Ambient Temperature Range:	-40°C to 105°C	
Durability:	10 cycles	
Housing:	P, UL 94 V-O	
Contact:	Copper alloy with tin plating	
Application Specification:	114-137020	
Product Specification:	108-137020	
UL2459 Approval:	308110	
Part Numbers:	Plug:	2271180-1
	Receptacle:	2271183-1
	Mated Connector:	2271203-1



Benefits

- 2 position, poke-in wiring
- Compact design
- Tool-free installation
- Fits 18-22 AWG solid or tin-dipped stranded wires
- UL/CSA 2459 compliant
- EU RoHS/ELV compliant
- Bump feature allows for easy mating/unmating
- Slim design for maximum Z direction space saving
- Dual contact surface design increases contact reliability
- Contacts are fully fixed in housing for high reliability
- Additional lock bar designed for enhanced retention

Dimensions

Plug (2271180-1) :

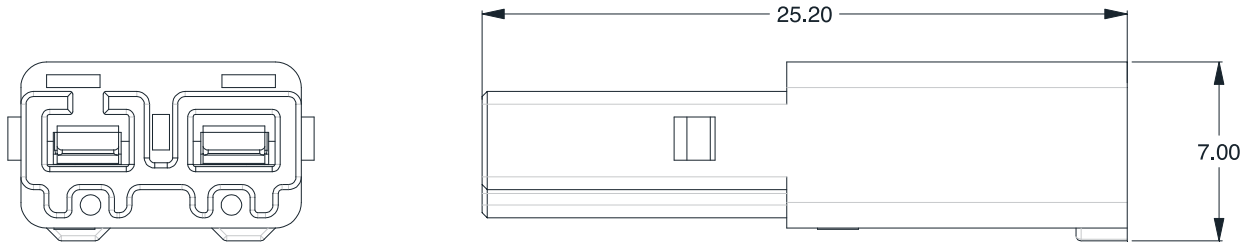

Receptacle (2271183-1) :



Mated Connector (2271203-1) :

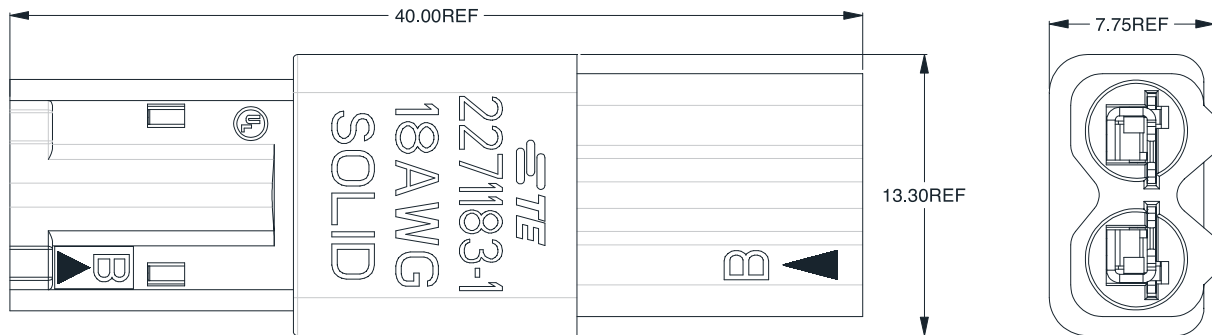

te.com

© 2017 TE Connectivity. All Rights Reserved. LIGHT-N-LOK, TE, TE Connectivity, and the TE connectivity (logo) are trademarks of the TE Connectivity Ltd. family of companies. Other logos, product and Company names mentioned herein may be trademarks of their respective owners.

While TE has made every reasonable effort to ensure the accuracy of the information in this brochure, TE does not guarantee that it is error-free, nor does TE make any other representation, warranty or guarantee that the information is accurate, correct, reliable or current. TE reserves the right to make any adjustments to the information contained herein at any time without notice. TE expressly disclaims all implied warranties regarding the information contained herein, including, but not limited to, any implied warranties of merchantability or fitness for a particular purpose. The dimensions in this catalog are for reference purposes only and are subject to change without notice. Specifications are subject to change without notice. Consult TE for the latest dimensions and design specifications.

1-1773863-8 JN 06/2017

USA: +1 (800) 522-6752
 Canada: +1 (905) 475-6222
 Mexico: +52 (0) 55-1106-0800
 Latin/S. America: +54 (0) 11-4733-2200
 Germany: +49 (0) 6251-133-1999
 UK: +44 (0) 800-267666
 France: +33 (0) 1-3420-8686
 The Netherlands: +31 (0) 73-6246-999
 China: +86 (0) 400-820-6015