

RECOMMENDED MOUNTING HOLE PATTERN FOR .063 THK PRINTED CIRCUIT BOARD

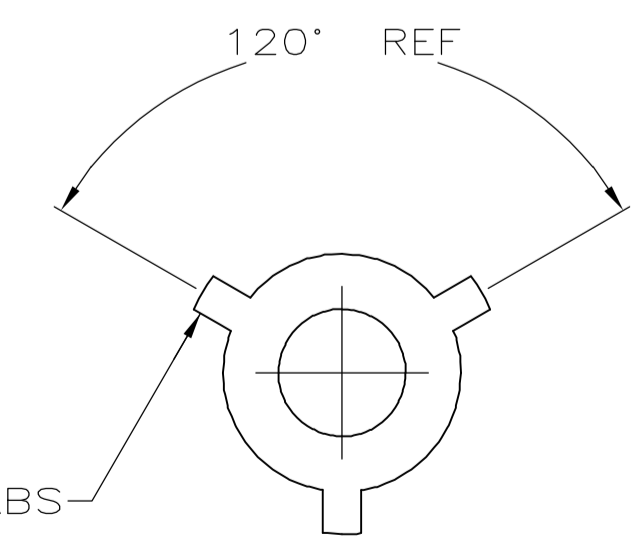
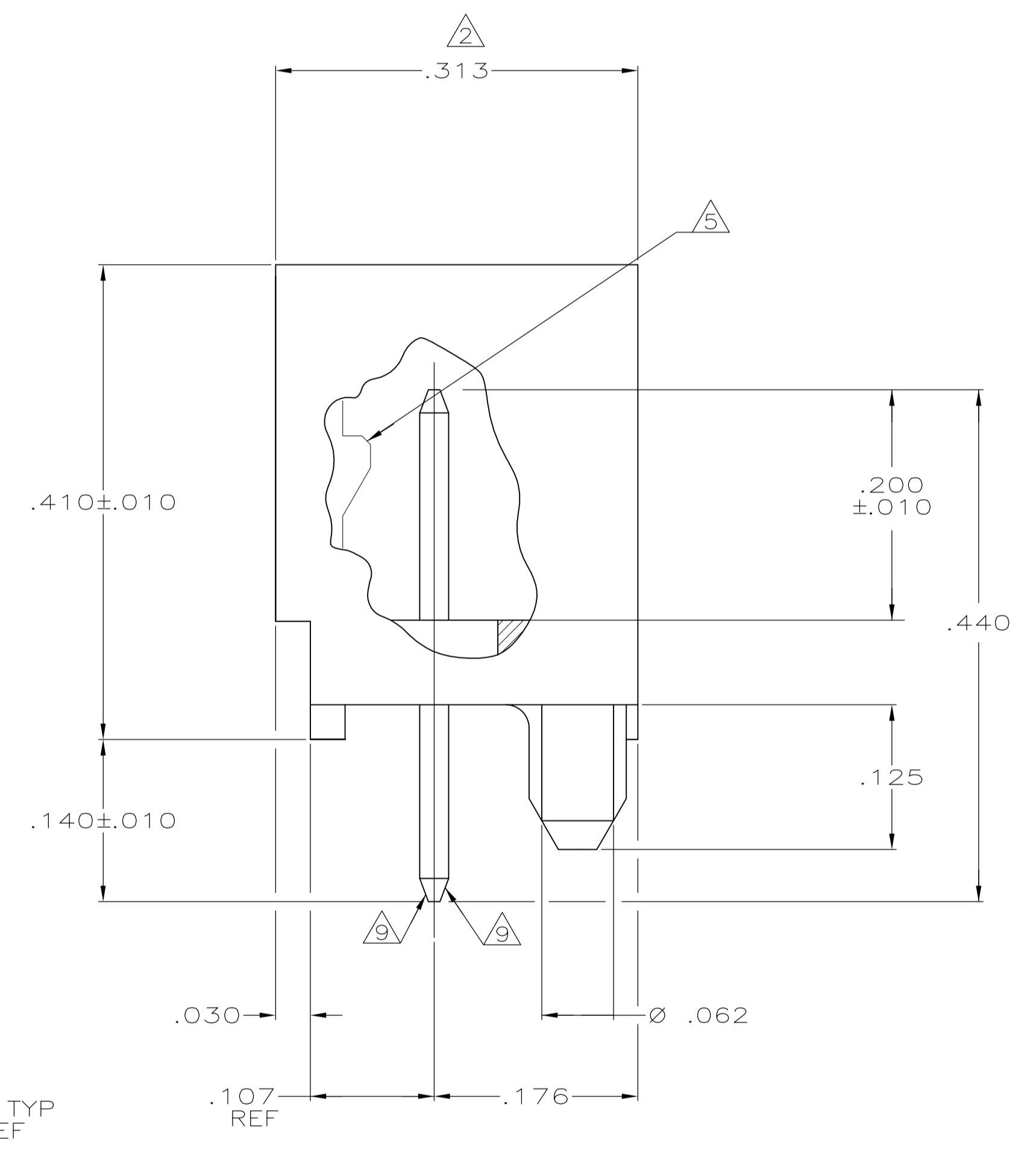
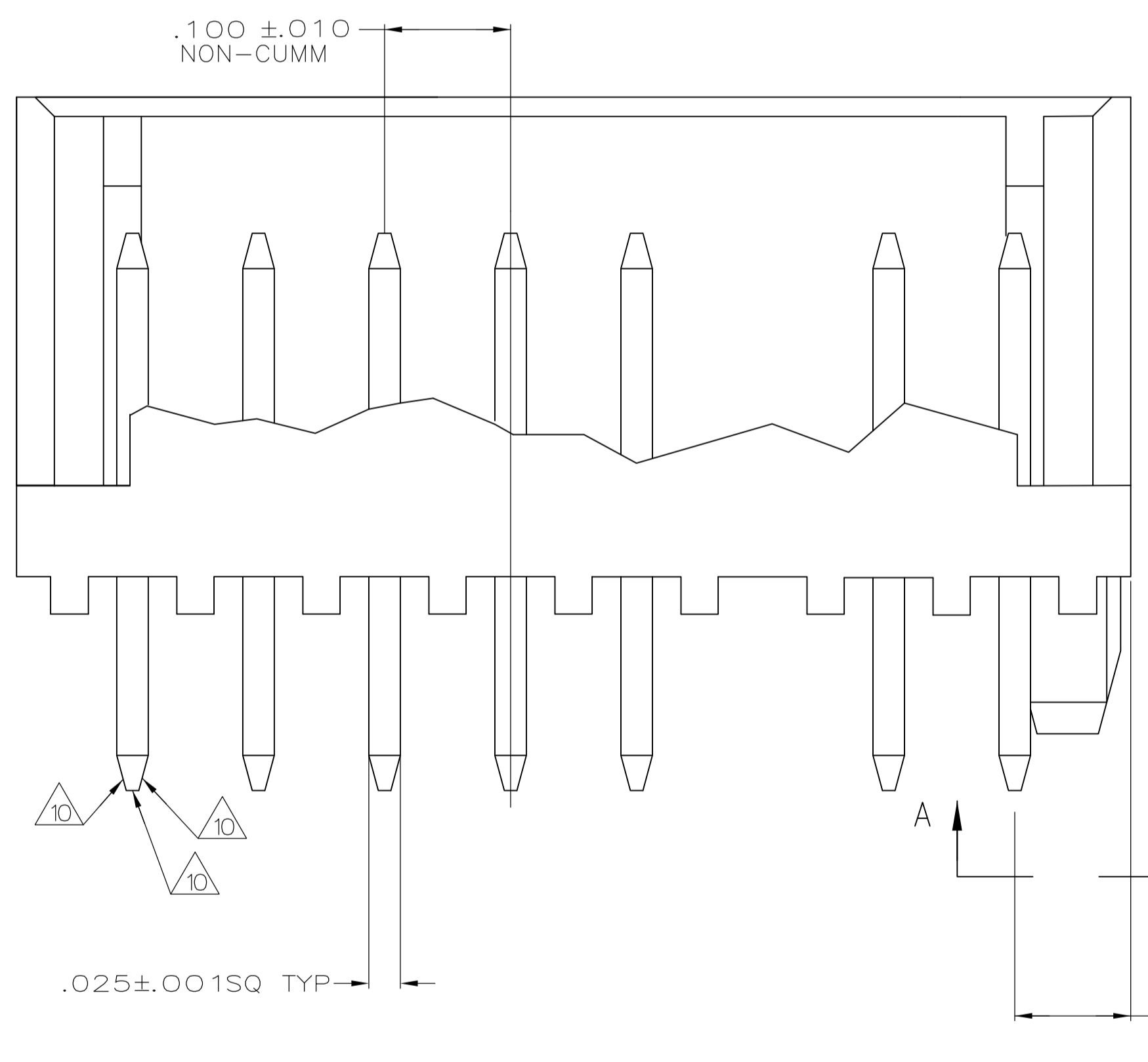

VIEW A-A

- 1 MATERIAL: HEADER- POLYESTER UL94V-0 (BLACK)  
POST- COPPER ALLOY.
- 2 SOLDER SIDE OF P.C. BOARD SHOWN.
- 3 PARTS COMPLY WITH AMP SOLDERABILITY SPEC 109-11-2.
- 4 THE RETENTION TABS PROVIDE A ONE-TIME INTERFERENCE FIT IN THE .078 DIAMETER BOARD HOLE FOR HEADER ASSEMBLY RETENTION DURING SOLDERING.
- 5 LATCH DETENT FEATURE OCCURS 2 PLACES ON EACH END (MAXIMUM OF FOUR PER PART). FOR 2 THRU 5 CIRCUIT HEADERS, LATCH FEATURE OCCURS BETWEEN EACH CIRCUIT.
- 6 COORDINATE DIMENSION APPLIES FROM CENTER OF ACTUAL FEATURE.
- 7 POST: MATTE TIN-LEAD (93/7) PLATED.
- 8 UL RECOGNIZED ( UR ) LOGO AND CSA LOGO WILL APPEAR ON THE SIDE OF THE PART. THE AMP LOGO MAY APPEAR ON THE SIDE OR ON BOTTOM OF PART.
- 9 TWO SIDES OF TAPER, AS SHOWN, MUST BE PLATED. TYPICAL, BOTH ENDS.
- 10 TWO SIDES OF TAPER, AS SHOWN, AND TIP MAY BE UNPLATED. TYPICAL, BOTH ENDS.
- 11 POST: MATTE TIN PLATED.
- 12 OBSOLETE PARTS: OBSOLETE CIS STREAMLINING PER D.RENAUD/D.SINISI

.040	1.02	.125	3.18	-	-
.030	0.76	.124	3.15	-	-
.025	0.64	.107	2.72	.440	11.18
.010	0.25	.100	2.54	.410	10.41
.005	0.13	.092	2.34	.313	7.95
.003	0.08	.078	1.98	.200	5.08
.001	0.03	.062	1.57	.176	4.47
.000	0	.042	1.07	.140	3.56
IN	MM	IN	MM	IN	MM

CONVERSION TABLE

12	SUPERSEDED	6	11	.884	22.45	8	3-1744078-8
		6	7	.884	22.45	8	<del>1744078-8</del>
	POST NO OMITTED	FINISH	IN	MM	NO OF POSITIONS	PART NUMBER	
			L		HEADER ASSEMBLY		

THIS DRAWING IS A CONTROLLED DOCUMENT.

DIMENSIONS: INCHES	TOLERANCES UNLESS OTHERWISE SPECIFIED:	DIN K WHITAKER 08SEP2004	TE Connectivity
0 PLC ± -	1 PLC ± -	CHK D BOSSI 08SEP2004	NAME
2 PLC ± -	3 PLC ± .005	APP'D D BOSSI 08SEP2004	PRODUCT SPEC
4 PLC ± -	ANGLES ± # 0.30'	APPLICATION SPEC	MTA-100 SHROUDED HEADER ASSEMBLY, FRICTION LOCK, STRAIGHT POST, TIN OR TIN LEAD PLATED
MATERIAL	FINISH	SIZE	CAGE CODE
1	-	WEIGHT	DRAWING NO
		A1	00779
		C=1744078	RESTRICTED TO
		CUSTOMER DRAWING	SCALE 10:1 SHEET 1 OF 1 REV B

