



TE Connectivity

## CUSTOMER DATA

PART NO.

1432869-1

SHT. 1  
OF 2

|                      |                       |                              |              |
|----------------------|-----------------------|------------------------------|--------------|
| DRAWN<br>N.TABAKOVIC | APPROVAL<br>L.BENNETT | DATE FIRST_DRAWN<br>10-24-06 | SCALE<br>1:1 |
|----------------------|-----------------------|------------------------------|--------------|

|                                       |
|---------------------------------------|
| CUSTOMER<br>TYCO_ELECTRONICS_STANDARD |
|---------------------------------------|

|           |        |   |     |
|-----------|--------|---|-----|
| TOLERANCE | 0.X    | = | +/- |
| UNLESS    | 0.XX   | = | +/- |
| SPECIFIED | 0.XXX  | = | +/- |
| OTHERWISE | ANGLES | = | +/- |

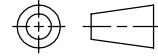

DO NOT SCALE THIS DRAWING

## CHANGES

| REV. | DATE      | CO            | APP. |
|------|-----------|---------------|------|
| E    | 06NOV2017 | ECO-17-003787 | B.T. |
| F1   | 29DEC2022 | ECN-22-181733 | B.K. |

NOT TO BE USED IN AUTOMOTIVE APPLICATIONS OR APPLICATIONS REQUIRING PPAP AND/OR IMDS DOCUMENTATION  
ELECTRICAL CHARACTERISTICS: (ALL DATA APPLIES @ 23°C UNLESS OTHERWISE SPECIFIED)

COIL DATA:

|                    |                                  |
|--------------------|----------------------------------|
| NOMINAL VOLTAGE:   | 12 VDC                           |
| OPERATE VOLTAGE:   | 7.8 VDC MAXIMUM                  |
| RELEASE VOLTAGE:   | 1.2 VDC MINIMUM                  |
| COIL RESISTANCE:   | 90 OHMS +/- 10%                  |
| OPERATE TIME:      | 8 mSEC. MAXIMUM EXCLUDING BOUNCE |
| RELEASE TIME:      | 5 mSEC. MAXIMUM EXCLUDING BOUNCE |
| TEMPERATURE RANGE: | OPERATING -40°C TO +85°C         |

CONTACT DATA: (CONTACT DATA IS FORMATTED N.O./N.C.)

|                             |  |
|-----------------------------|--|
| CONTACT ARRANGEMENT:        | 1 FORM C (SPDT)  |
| CONTACT MATERIAL:           | AgSnO (SILVER TIN-OXIDE)   |
| CONTACT MILLIVOLT DROP:     | 200mv @ 35A ON N.O. CONTACTS (AFTER SWITCHING)<br>250mv @ 20A ON N.C. CONTACTS (AFTER SWITCHING) |
| MAXIMUM MAKE CURRENT:       | 90A/30A (LAMP) @ 16 VDC  |
| MAXIMUM BREAK CURRENT:      | 40A/30A @ 16 VDC RESISTIVE   |
| MAXIMUM CONTINUOUS CURRENT: | 40A/30A @ 23°C , 35A/20A @ 85°C  |
| INITIAL BREAKDOWN CURRENT   | 500V RMS CONTACTS TO COIL  |

|                |   |
|----------------|---|
| EXPECTED LIFE: | 100,000 OPERATIONS, 40 A, 14 VDC RESISTIVE ON NORMALLY OPEN CONTACT |
|----------------|---|

MECHANICAL CHARACTERISTICS:

|                |  |
|----------------|--|
| EXPECTED LIFE: | 10 MILLION OPERATIONS, NO CONTACT LOAD |
| TERMINALS      | PLATED COPPER                          |
| ENCLOSURE:     | EPOXY SEALED                           |

# OBSOLETE



TE Connectivity

# CUSTOMER DATA

PART NO.  
1432869-1

SHT. 2  
OF 2

|                      |                       |                              |              |
|----------------------|-----------------------|------------------------------|--------------|
| DRAWN<br>N.TABAKOVIC | APPROVAL<br>L.BENNETT | DATE FIRST_DRAWN<br>10-24-06 | SCALE<br>1:1 |
|----------------------|-----------------------|------------------------------|--------------|

CUSTOMER  
TYCO\_ELECTRONICS\_STANDARD

TOLERANCE 0.X = +/-  
 UNLESS 0.XX = +/-  
 SPECIFIED 0.XXX = +/-  
 OTHERWISE ANGLES = +/-

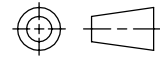

REV E1

DO NOT SCALE THIS DRAWING

MILLIMETERS

### MARKING TO INCLUDE:

TYCO ELECTRONICS NAME, TYCO ELECTRONICS PART NUMBER, SCHEMATIC, COIL VOLTAGE, COUNTRY OF ORIGIN, AND DATE CODE

\* TERMINAL LOCATIONS APPLY AT THE BASE OF THE TERMINALS

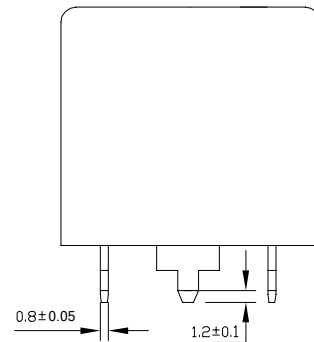
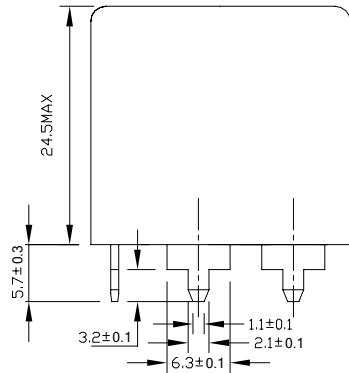

# OBSOLETE

K  
K Aspect

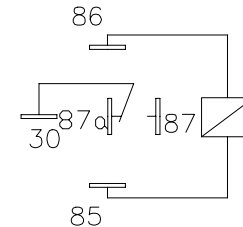
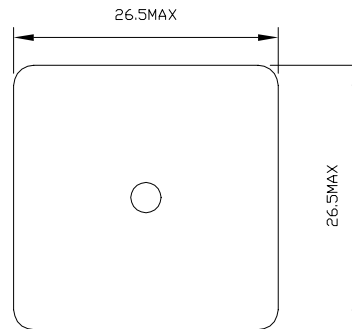
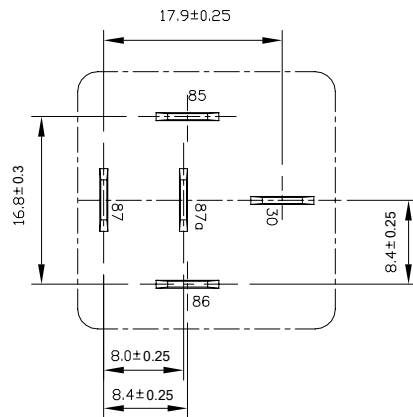

Schematic Drawing  
(Bottom views)

NOT TO BE USED IN AUTOMOTIVE APPLICATIONS OR APPLICATIONS REQUIRING PPAP AND/OR IMDS DOCUMENTATION